

F.A.I. RTE.	SECTION	COUNTY	TOTAL SHEETS	SHEET NO.
94/90		COOK	598	407
STA.		TO STA.		
FED. ROAD DIST. NO.		ILLINOIS FED. AID PROJECT		
62302		• (1818, ETC, 2324.6-1P)R-9		

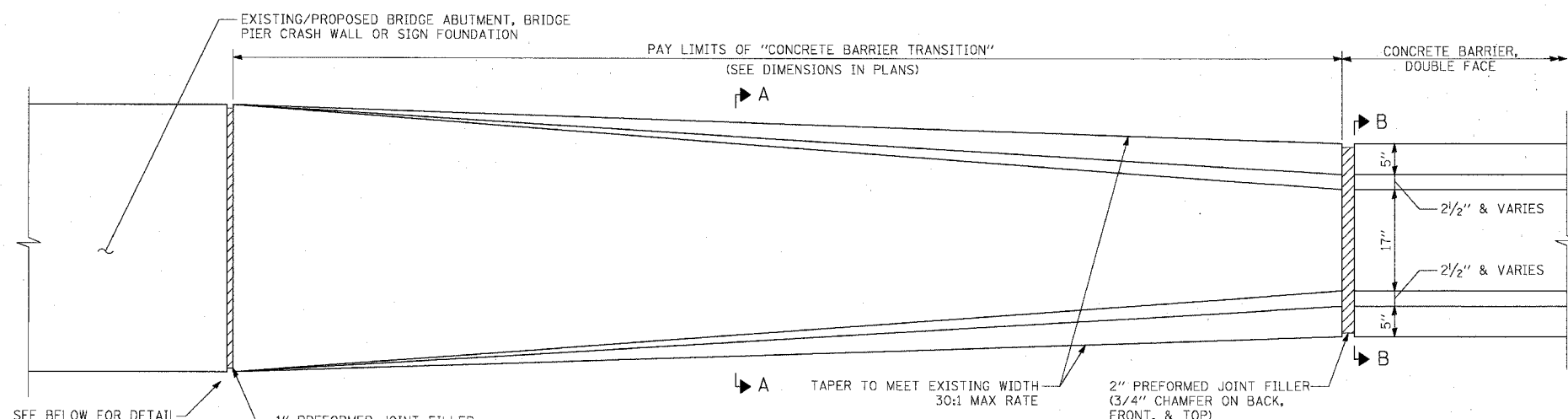

DETAIL OF "CONCRETE BARRIER TRANSITION" FOR DOUBLE FACE BARRIER WALL

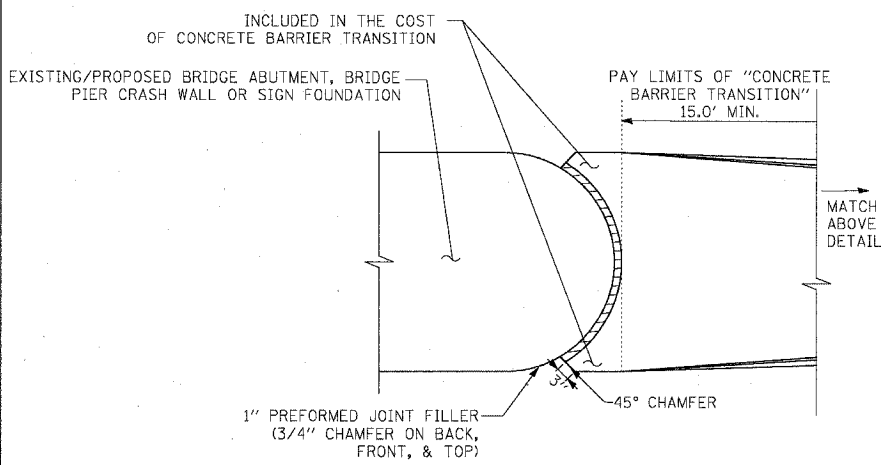

DETAIL OF "CONCRETE BARRIER TRANSITION" AT EXISTING ROUNDED PIER

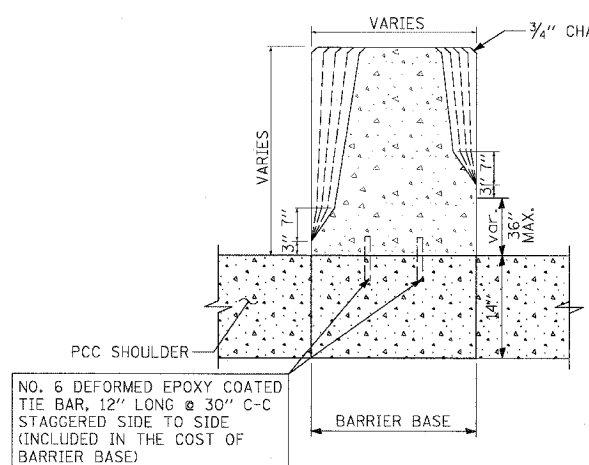

SECTION A-A CONCRETE BARRIER TRANSITION

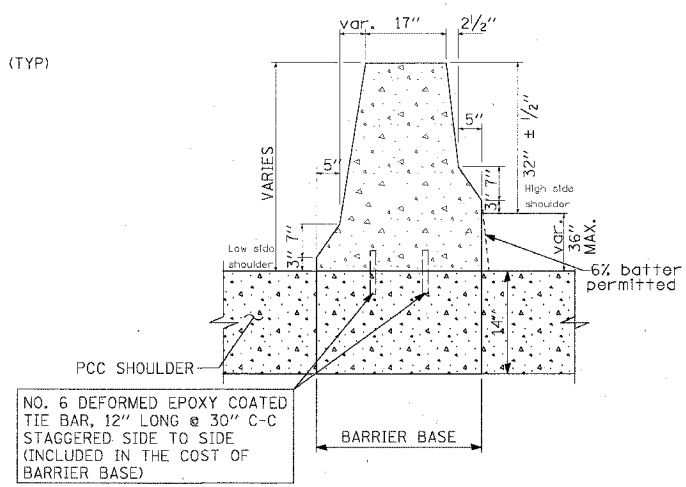

SECTION B-B DOUBLE FACE BARRIER WALL

NOTE: ALL TRANSITIONS PAID FOR AS CONCRETE BARRIER TRANSITION

Edwards AND Kelcey
 ONE NORTH FRANKLIN CHICAGO, IL 60606
 PHONE: (312) 251-3000
 FAX: (312) 251-3015
 WEB: WWW.EKCORP.COM

REVISIONS	
NAME	DATE

ILLINOIS DEPARTMENT OF TRANSPORTATION
 F.A.I. 94/90 (DAN RYAN EXPRESSWAY)
 31ST STREET TO 71ST STREET
 SB EXPRESS LANE RECONSTRUCTION
 CONCRETE BARRIER TRANSITION
 (SHEET 2 OF 3)

SCALE: NONE
 DATE: 7/7/05

DRAWN BY: TAI
 CHECKED BY: PjM

CDT-20

08/24/2005 12:21:50 PM