

STATE OF ILLINOIS
DEPARTMENT OF TRANSPORTATION

F.A.I. SECTION	COUNTY	TOTAL SHEETS	SHEET NO.
90/94	COOK	598	420
STA. TO STA.		FED. ROAD DIST. NO. 1 ILLINOIS FED. AID PROJECT	
		• (1818, ETC, 2324.6-IPR-9 62302	

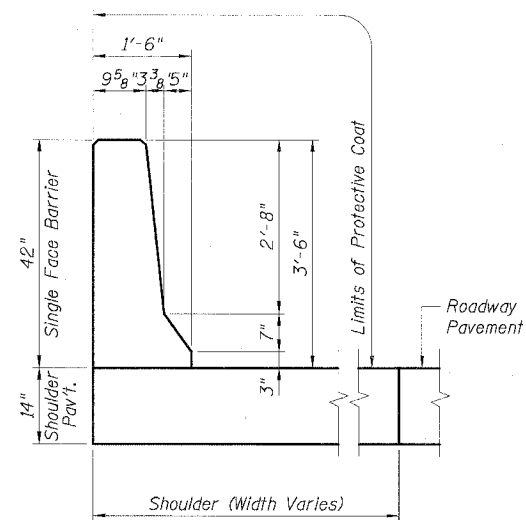

SECTION A

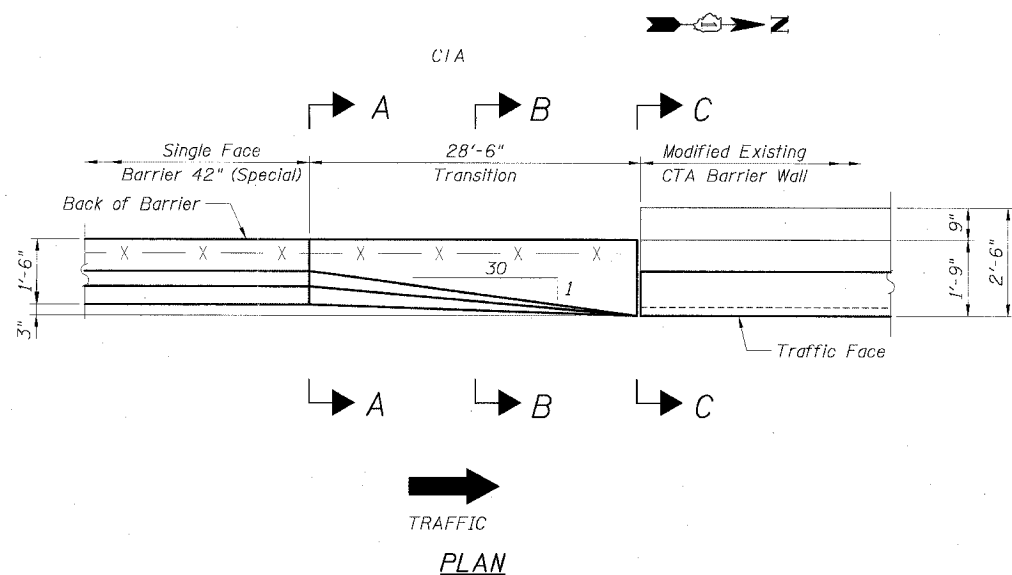
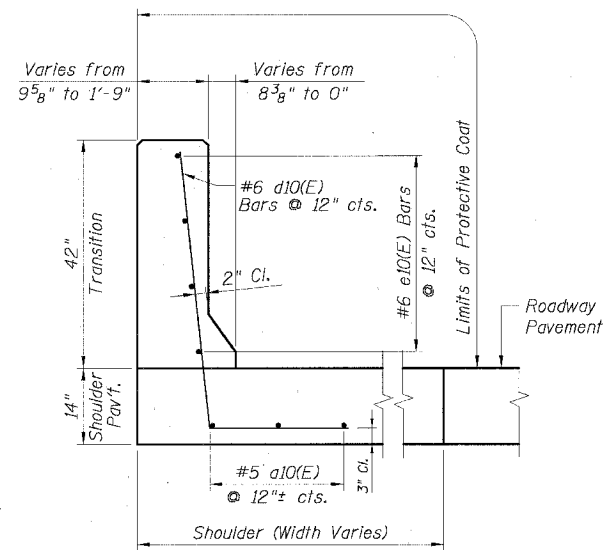

SECTION B

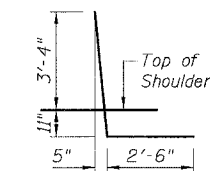

BAR d10(E)

BILL OF MATERIAL
FOR ONE TRANSITION

Bar	No.	Size	Length	Shape
d10	3	#5	28'-2"	—
d10	29	#6	6'-9"	L
e10	4	#4	28'-2"	—
Item	Unit	Quantity		
Reinforcement Bars, Epoxy Coated	Lbs.	460		
Concrete Structures	Cu. Yd.	5.2		
Protective Coat	Sq. Yd.	16		

NOTES:

- For alternative vertical reinforcing details, see "Concrete Barrier Single Face, 42" Alternates".
- For existing CTA Barrier modifications - vertical facing, see sheet B7.
- For locations of Transition, see Roadway Plans.

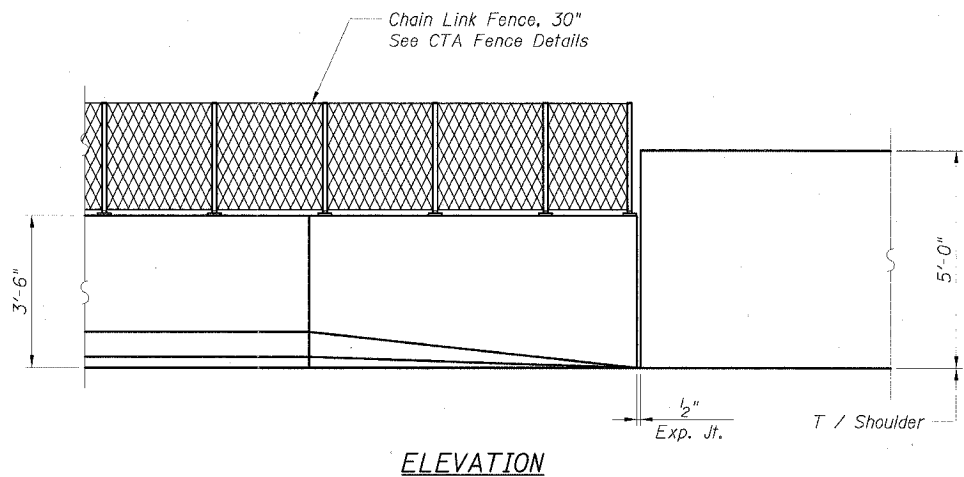

ELEVATION

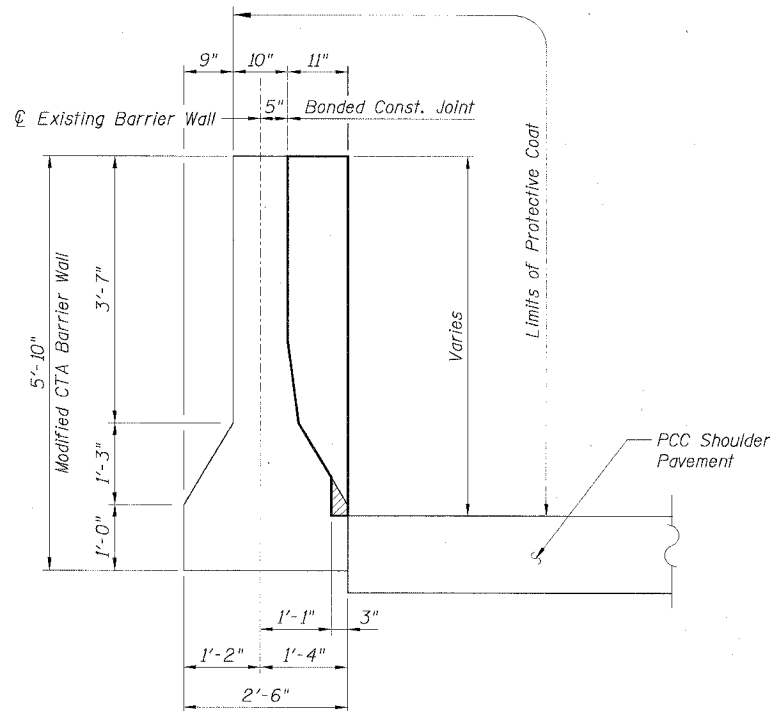

SECTION C

REVISIONS	
NAME	DATE

Sheet B12 of 18
ILLINOIS DEPARTMENT OF TRANSPORTATION
F.A.I. 90/94 (DAN RYAN EXPRESSWAY)
EXISTING BARRIER WALL MODIFICATIONS
AT CTA STATIONS
PROPOSED T/S SHOULDER AT OR ABOVE EXISTING
VERT. NEW 42" BARRIER TO REFACED BARRIER
TRANSITION DETAILS (TAPER)
SCALE: None DRAWN BY: CHD
DATE: JULY 7, 2005 CHECKED BY: RDP

CTE AECOM

CTE
303 E. Rockwell Drive, Suite 400, Chicago, Illinois 60631-2075
T: 312.818.0100 F: 312.818.1100 www.cteaecom.com

05/24/2005 02:20:21 PM