

F.A.P. RTE.	SECTION	COUNTY	TOTAL SHEETS	SHEET NO.
303	134(B&B-2)R-1	LAKE	137	26
STA. 25+098 TO STA. 25+197				
FED. ROAD DIST. NO. 1 ILLINOIS FED. AID PROJECT				

CONTRACT NO. 62037

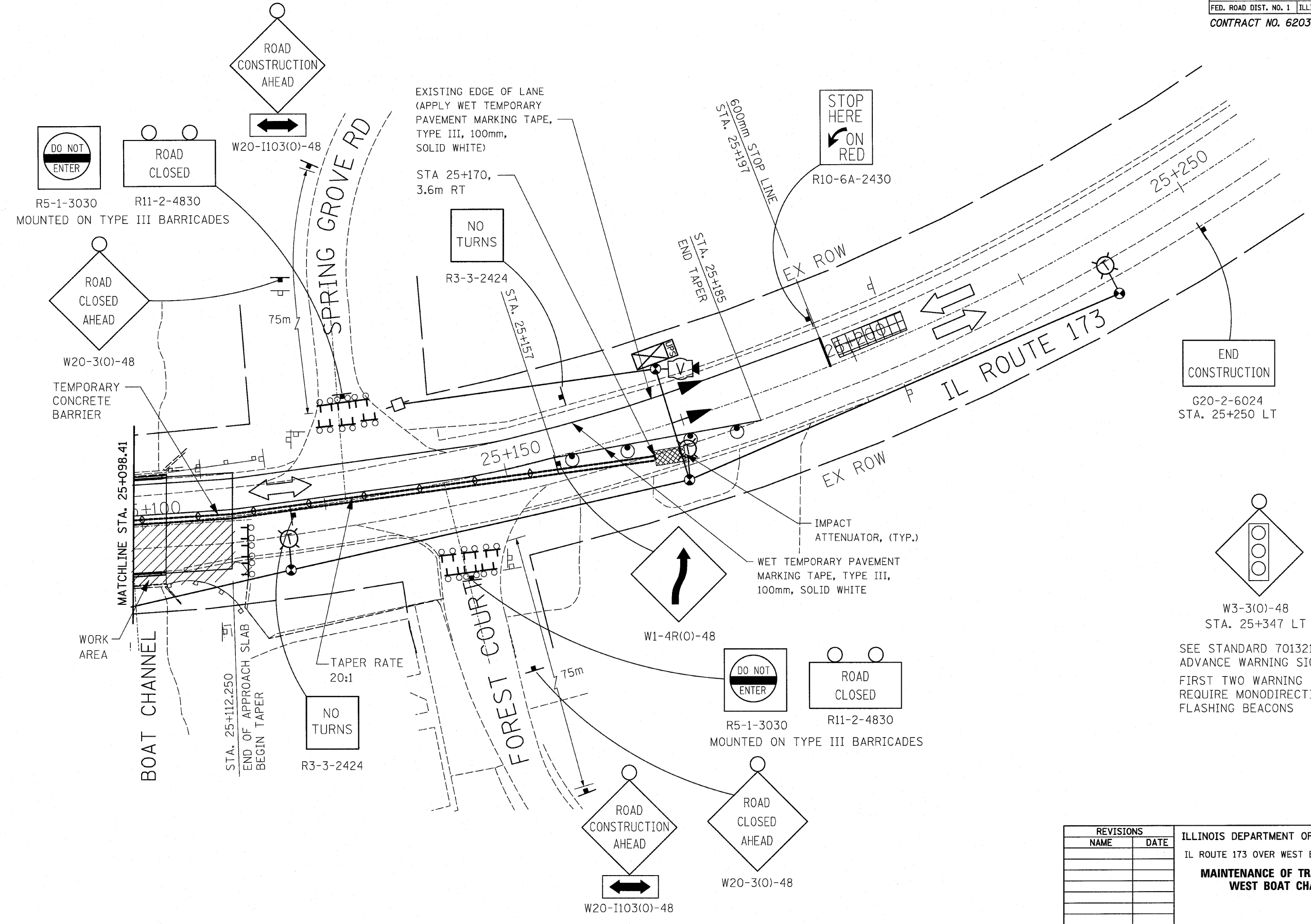

END CONSTRUCTION  
G20-2-6024  
STA. 25+250 LT

W3-3(O)-48  
STA. 25+347 LT

SEE STANDARD 701321 FOR ADVANCE WARNING SIGNS  
FIRST TWO WARNING SIGNS REQUIRE MONODIRECTIONAL FLASHING BEACONS

REVISIONS	
NAME	DATE

ILLINOIS DEPARTMENT OF TRANSPORTATION  
IL ROUTE 173 OVER WEST BOAT CHANNEL  
**MAINTENANCE OF TRAFFIC STAGE II  
WEST BOAT CHANNEL**

SCALE: 1:250  
DRAWN BY CLG  
CHECKED BY BNU

DATE 3-8-10

3117TRAFFWEST2.DGN