

SECTION 13, TOWNSHIP 36, RANGE 14  
SECTION 24, TOWNSHIP 36, RANGE 14

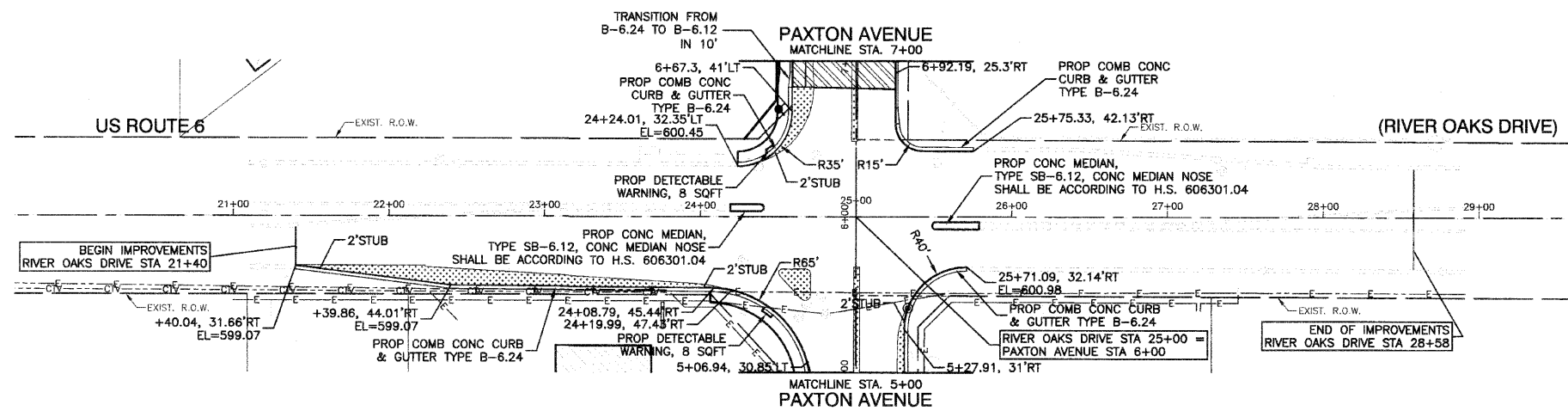
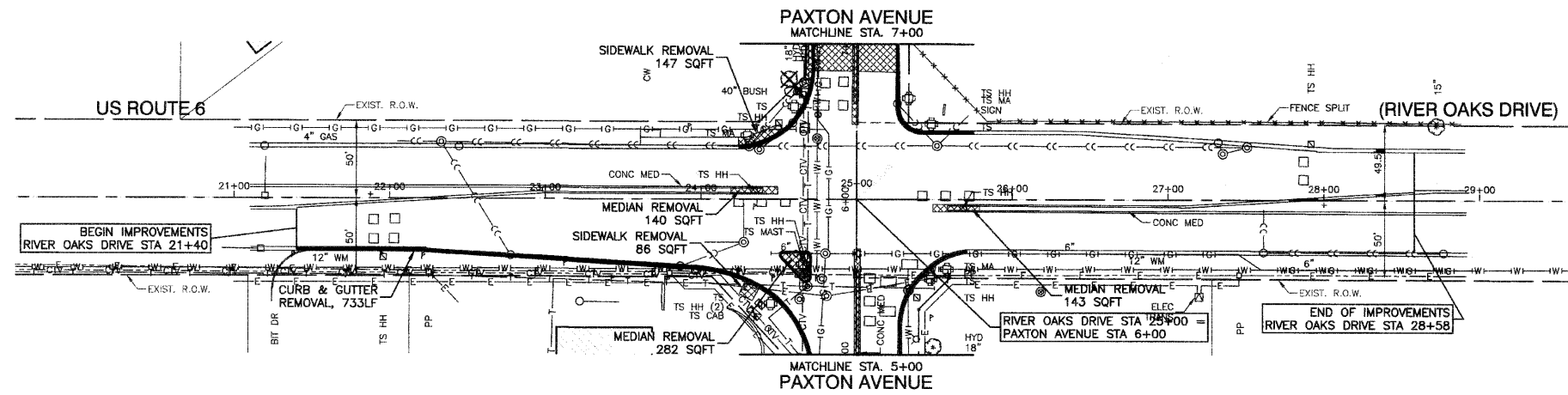

EARTHWORK SCHEDULE				
Location	Earth Excavation	Earth Excavation adjusted for Shrinkage	Embarkment	Earthwork Balance Waste(+) or Shortage (-)
	Cubic Yard	Cubic Yard	Cubic Yard	Cubic Yard
Paxton Ave South Leg	647.4	485.6	13.2	472.4
Paxton Ave North Leg	112.0	84.0	0.7	83.3
River Oaks Drive West Leg	281.0	210.7	0.0	210.7
<b>Total</b>				<b>766.4</b>

LEGEND

- PROP SUBBASE GRANULAR MATERIAL, TYPE B, 4" HOT-MIX ASPHALT BASE COURSE, 8" HOT-MIX ASPHALT BINDER COURSE, IL-19.0, N70 2 1/2" HOT-MIX ASPHALT SURFACE COURSE, MIX "D", N70, 2"
- PROP SUBBASE GRANULAR MATERIAL, TYPE B, 4" P.C.C. PAVEMENT, 10"
- PROP SUBBASE GRANULAR MATERIAL, TYPE B, 4" HOT-MIX ASPHALT BASE COURSE, 8" LEVELING BINDER (MACHINE METHOD) N70, 1" HOT-MIX ASPHALT SURFACE COURSE, MIX "D", N70, 2"
- CLASS D PATCH, 10"
- PAVEMENT, DRIVEWAY PAVEMENT, & SIDEWALK REMOVAL
- CURB & GUTTER REMOVAL

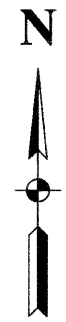

PLAN	SURVEYED	DATE
	PLOTTED	
	CHECKED	
	BY	
	NO.	

PROFILE	SURVEYED	DATE
	PLOTTED	
	CHECKED	
	BY	
	NO.	

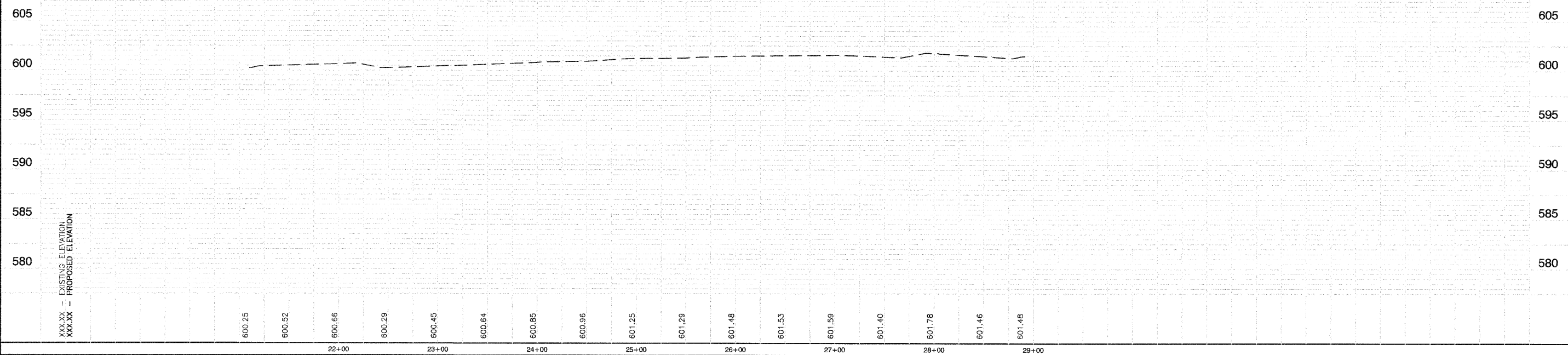

FILE NAME = 08328-PLPR-01 - PLPR01	USER NAME =	DESIGNED = RW	REVISED =	STATE OF ILLINOIS DEPARTMENT OF TRANSPORTATION	US ROUTE 6 (RIVER OAKS DRIVE) AT PAXTON AVENUE INTERSECTION IMPROVEMENT EXISTING & PROPOSED PLAN & PROFILE		F.A.P. RTE. = 351	SECTION = 08-00139-00-CH	COUNTY = COOK	TOTAL SHEETS = 044	SHEET NO. = 007	
	PLOT SCALE =	DRAWN = RG/PS	REVISED =		SCALE: H 1"=50' V 1"=5'		SHEET NO. 007 OF 044 SHEETS	STA. TO STA.	CONTRACT NO. 63268			
	PLOT DATE = 01-25-10	CHECKED = AG	REVISED =		FED. ROAD DIST. NO. 1		ILLINOIS	FED. AID PROJECT HD-M-9003(258)				