

F.A.P. RTE.	SECTION	COUNTY	TOTAL SHEETS	SHEET NO.
0336	05-00308-00-WR	MCHENRY	606	1
FED. ROAD DIST. NO.	ILLINOIS	CONTRACT NO. 63398		

FOR INDEX OF SHEETS SEE SHEET NO. 2

HIGHWAY CLASSIFICATION
PRINCIPAL ARTERIAL

RAKOW ROAD TRAFFIC DATA

2005 ADT=16,500 TO 39,400
2030 ADT=29,000 TO 66,000
POSTED SPEED LIMIT = 45 MPH
DESIGN SPEED LIMIT = 45 MPH

PROJECT DESCRIPTION

THE PROPOSED IMPROVEMENT CONSISTS OF THE WIDENING AND RECONSTRUCTION OF RAKOW ROAD FROM ACKMAN ROAD TO ILLINOIS ROUTE 31 INCLUDING A NEW STORM SEWER SYSTEM, EXTENSION OF THE CRYSTAL CREEK DOUBLE BOX CULVERT, AND TRAFFIC SIGNAL MODERNIZATION

PROJECT LOCATED IN CITY OF CRYSTAL LAKE AND VILLAGE OF LAKE IN THE HILLS

STATE OF ILLINOIS
DEPARTMENT OF TRANSPORTATION
DIVISION OF HIGHWAYS
PROPOSED HIGHWAY PLANS

FAP 0336 (RAKOW ROAD)
FAU 3873 (ACKMAN ROAD) TO FAP 0336 (ILLINOIS ROUTE 31)
ROADWAY RECONSTRUCTION AND WIDENING

PROJECT # HPP-TCSP-RS-CMF-0336(031)
JOB # C-91-191-05
SECTION # 05-00308-00-WR
MCHENRY COUNTY

VOLUME 1

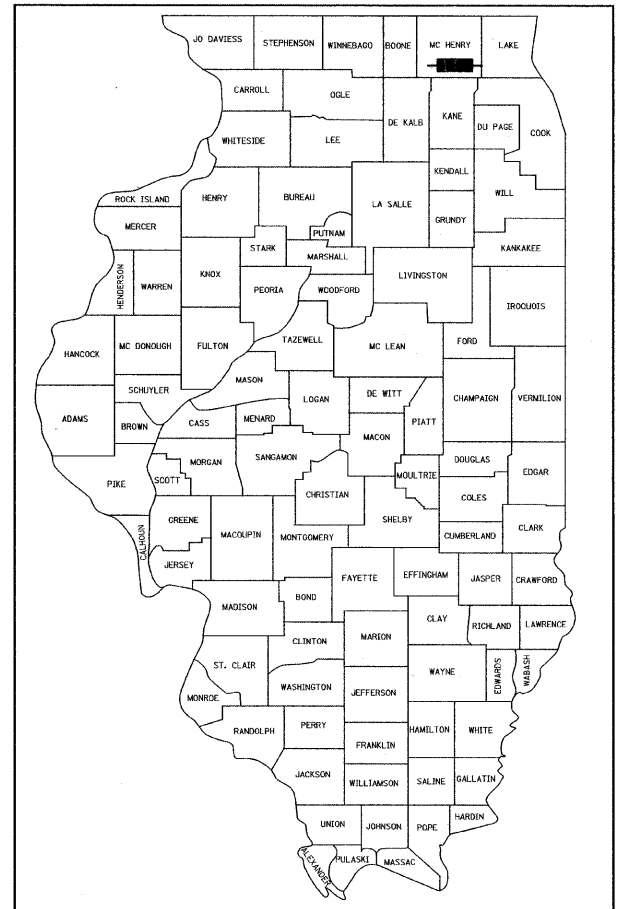

LOCATION OF SECTION INDICATED THUS: - [black box]

McHENRY COUNTY
DIVISION OF TRANSPORTATION
APPROVED: JULY, 27 2010
Joseph R. Kopecki Jr.
DIRECTOR OF TRANSPORTATION / COUNTY ENGINEER

STATE OF ILLINOIS
DEPARTMENT OF TRANSPORTATION
DIVISION OF HIGHWAYS
PASSED August 27 2010
Christy Hawthorn
DISTRICT ENGINEER OF LOCAL ROADS AND STREETS
RELEASING FOR BID BASED ON LIMITED REVIEW
August 30 2010
Diane M. O'Leary
DEPUTY DIRECTOR OF HIGHWAYS, REGION I ENGINEER

PRINTED BY THE AUTHORITY
OF THE STATE OF ILLINOIS

PLANS PREPARED BY:
PATRICK ENGINEERING, INC.

FINAL

IDOT FIELD ENGINEER: ALEX HOUSEH (847) 705-4410

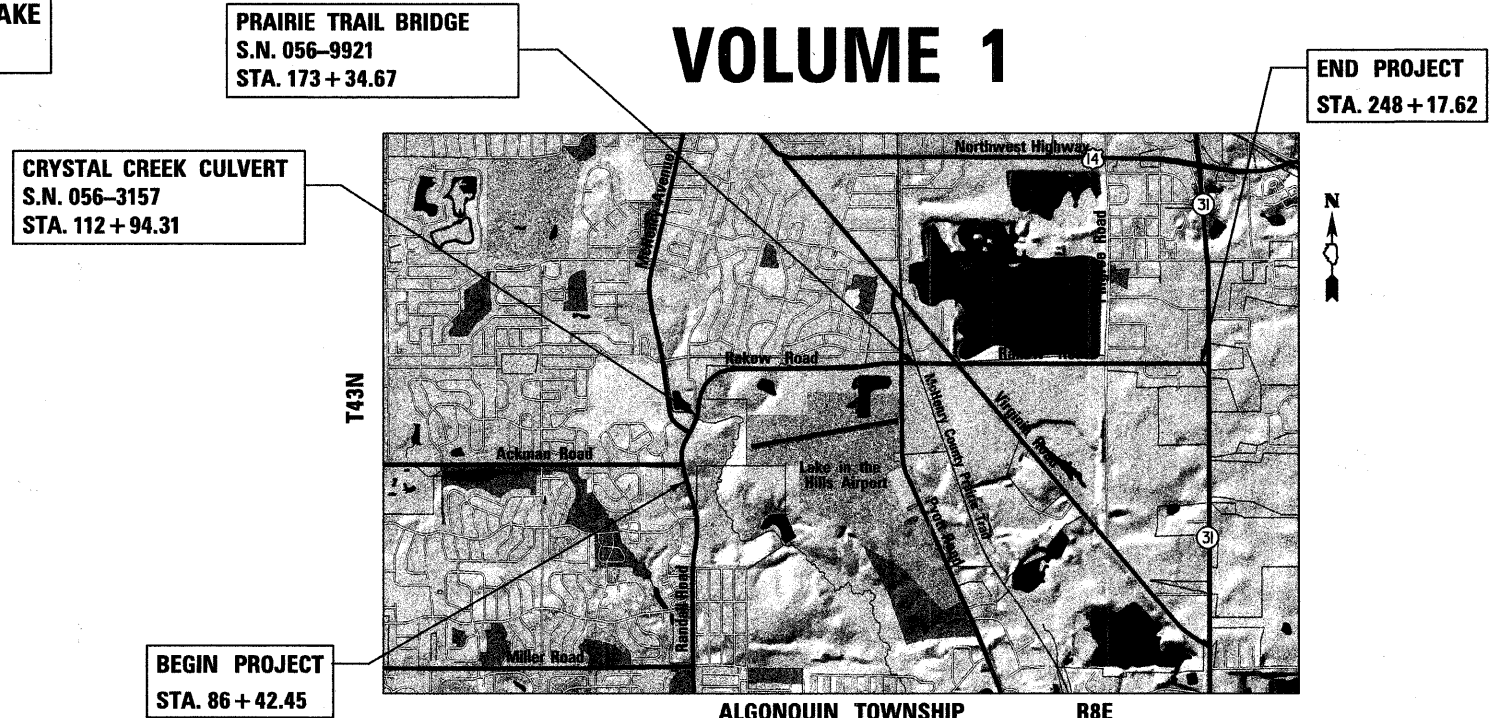

ALGONQUIN TOWNSHIP R8E
LOCATION MAP
SCALE: 1" = 2500' GROSS & NET LENGTH OF PROJECT = 16,175 FEET (3.06 MILES)

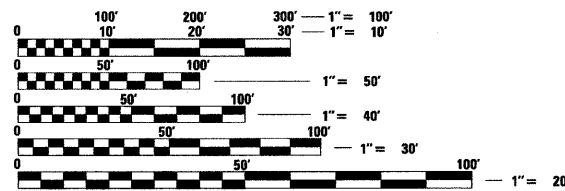

FULL SIZE PLANS HAVE BEEN PREPARED USING STANDARD ENGINEERING SCALES. REDUCED SIZED PLANS WILL NOT CONFORM TO STANDARD SCALES. IN MAKING MEASUREMENTS ON REDUCED PLANS, THE ABOVE SCALES MAY BE USED.

J.U.L.I.E.
JOINT UTILITY LOCATION INFORMATION FOR EXCAVATION
1-800-892-0123 OR 811

CONTRACT NO. 63398

<p>PATRICK ENGINEERING, INC. JOHN A. HEIM, P.E.</p> <p><i>J.A. Heim</i> JOHN A. HEIM, P.E. # 062-058717 EXP: 11/30/2011 DATE: 7/28/2010</p>	<p>PATRICK ENGINEERING, INC. ERIC Y. CHOW, P.E.</p> <p><i>E. Y. Chow</i> ERIC Y. CHOW, P.E. # 062-060334 EXP: 11/30/2011 DATE: 7/28/2010 SHEETS 187-230 ; 289-307</p>	<p>PATRICK ENGINEERING, INC. ATALAY YARGICOGLU, S.E.</p> <p><i>Atalay Yargicoglu</i> ATALAY YARGICOGLU, S.E. # 081-005358 EXP: 11/30/2010 DATE: 7/28/2010 SHEETS 403-424</p>	<p>PATRICK ENGINEERING, INC. CHRISTY HAWTHORN, P.E.</p> <p><i>Christy Hawthorn</i> CHRISTY HAWTHORN, P.E. # 062-058438 EXP: 11/30/2011 DATE: 7/28/2010 SHEETS 375-402</p>	<p>GEWALT-HAMILTON ASSOCIATES, INC. DANIEL P. BRINKMAN, P.E.</p> <p><i>D. P. Brinkman</i> DANIEL P. BRINKMAN, P.E. # 062-055293 EXP: 11/30/2011 DATE: 7/28/2010 SHEETS 310-374</p>
---	---	--	---	--