

INTERSECTION COORDINATE TABLE		
STATION EQUATION	N	E
☉ RANDALL ROAD STA. 99+99.66 = ☉ ACKMAN ROAD STA. 20+00.00	2017108.951	983389.682
☉ RAKOW ROAD STA. 108+84.72 = ☉ MCHENRY ROAD STA. 20+00.00	2107942.189	983588.310

SUPERELEVATION TRANSITIONS CURVE MCH 2						
LT EOP	PGL EL.	X-SLOPE	PROP ☉ STATION	X-SLOPE	PGL EL.	RT EOP
881.79	882.27	-2.00% (NC)	10+71.77	-2.00% (NC)	882.27	881.79
882.59	883.07	-2.00% (NC)	11+80.86	2.00% (RC)	883.07	883.55
882.55	883.32	-3.22% (SE)	12+14.02 (PC)	3.22% (SE)	883.32	884.12
882.49	883.64	-4.80% (SE)	12+57.22	4.80% (SE)	883.64	884.96
885.66	886.61	-4.80% (SE)	16+52.68	4.80% (SE)	886.61	888.34
886.07	886.84	-3.22% (SE)	16+95.88 (PT)	3.22% (SE)	886.84	888.00
886.39	886.90	-2.00% (NC)	17+29.04	2.00% (RC)	886.90	887.62
885.76	886.38	-2.00% (NC)	18+38.13	-2.00% (NC)	886.38	885.66

RANDALL/RAKOW ROAD COORDINATE TABLE			
DESCRIPTION	ALIGNMENT POINT	N	E
	PI 35+66.99	2015727.062	983834.096
BEGIN PROJECT	86+42.45	2015806.503	983763.609
	PT 90+86.28	2016239.382	983668.804
CURVE RAK 3	PC 99+58.00	2017068.994	983401.143
	PI 103+11.79	2017405.697	983292.512
	PT 106+25.88	2017715.518	983463.334
CURVE RAK 4	PC 110+47.98	2018085.154	983667.136
	PI 127+17.15	2019546.872	984473.064
	PT 140+73.51	2019574.215	986142.013

SIDE ROAD COORDINATE TABLE			
DESCRIPTION	ALIGNMENT POINT	N	E
BEGIN IMPROVEMENT	9+03.18	2017113.601	982292.553
END IMPROVEMENT	21+87.44	2017108.158	983576.816
BEGIN IMPROVEMENT	6+81.33	2018999.675	982986.374
CURVE MCH 2	PC 12+14.02	2018471.937	983058.862
	PI 14+73.99	2018214.381	983094.238
	PT 16+95.88	2018088.935	983321.943
END IMPROVEMENT	22+15.19	2017838.351	983776.792

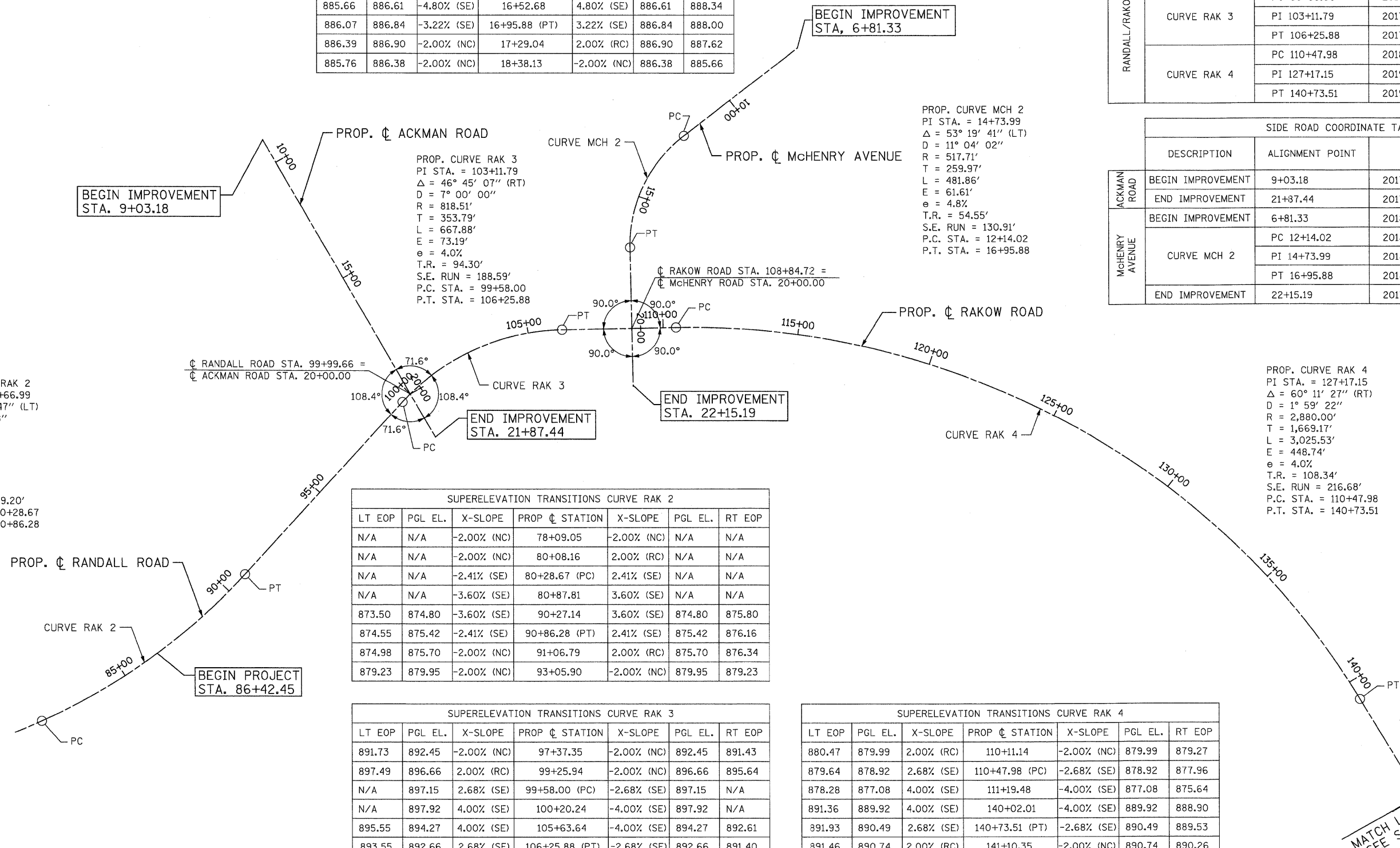

SUPERELEVATION TRANSITIONS CURVE RAK 2						
LT EOP	PGL EL.	X-SLOPE	PROP ☉ STATION	X-SLOPE	PGL EL.	RT EOP
N/A	N/A	-2.00% (NC)	78+09.05	-2.00% (NC)	N/A	N/A
N/A	N/A	-2.00% (NC)	80+08.16	2.00% (RC)	N/A	N/A
N/A	N/A	-2.41% (SE)	80+28.67 (PC)	2.41% (SE)	N/A	N/A
N/A	N/A	-3.60% (SE)	80+87.81	3.60% (SE)	N/A	N/A
873.50	874.80	-3.60% (SE)	90+27.14	3.60% (SE)	874.80	875.80
874.55	875.42	-2.41% (SE)	90+86.28 (PT)	2.41% (SE)	875.42	876.16
874.98	875.70	-2.00% (NC)	91+06.79	2.00% (RC)	875.70	876.34
879.23	879.95	-2.00% (NC)	93+05.90	-2.00% (NC)	879.95	879.23

SUPERELEVATION TRANSITIONS CURVE RAK 3						
LT EOP	PGL EL.	X-SLOPE	PROP ☉ STATION	X-SLOPE	PGL EL.	RT EOP
891.73	892.45	-2.00% (NC)	97+37.35	-2.00% (NC)	892.45	891.43
897.49	896.66	2.00% (RC)	99+25.94	-2.00% (NC)	896.66	895.64
N/A	897.15	2.68% (SE)	99+58.00 (PC)	-2.68% (SE)	897.15	N/A
N/A	897.92	4.00% (SE)	100+20.24	-4.00% (SE)	897.92	N/A
895.55	894.27	4.00% (SE)	105+63.64	-4.00% (SE)	894.27	892.61
893.55	892.66	2.68% (SE)	106+25.88 (PT)	-2.68% (SE)	892.66	891.40
892.46	891.74	2.00% (RC)	106+57.94	-2.00% (NC)	891.74	890.72

SUPERELEVATION TRANSITIONS CURVE RAK 4						
LT EOP	PGL EL.	X-SLOPE	PROP ☉ STATION	X-SLOPE	PGL EL.	RT EOP
880.47	879.99	2.00% (RC)	110+11.14	-2.00% (NC)	879.99	879.27
879.64	878.92	2.68% (SE)	110+47.98 (PC)	-2.68% (SE)	878.92	877.96
878.28	877.08	4.00% (SE)	111+19.48	-4.00% (SE)	877.08	875.64
891.36	889.92	4.00% (SE)	140+02.01	-4.00% (SE)	889.92	888.90
891.93	890.49	2.68% (SE)	140+73.51 (PT)	-2.68% (SE)	890.49	889.53
891.46	890.74	2.00% (RC)	141+10.35	-2.00% (NC)	890.74	890.26
889.82	890.54	-2.00% (NC)	143+27.03	-2.00% (NC)	890.54	890.06

MATCH LINE STA. 145+00
SEE SHEET AL 2 OF 3

G:\MCD00\209502_001\Drawings\RDWY\shets\A1\1S_A1_01.dgn