

ADVANCE SIGNING DETAIL:

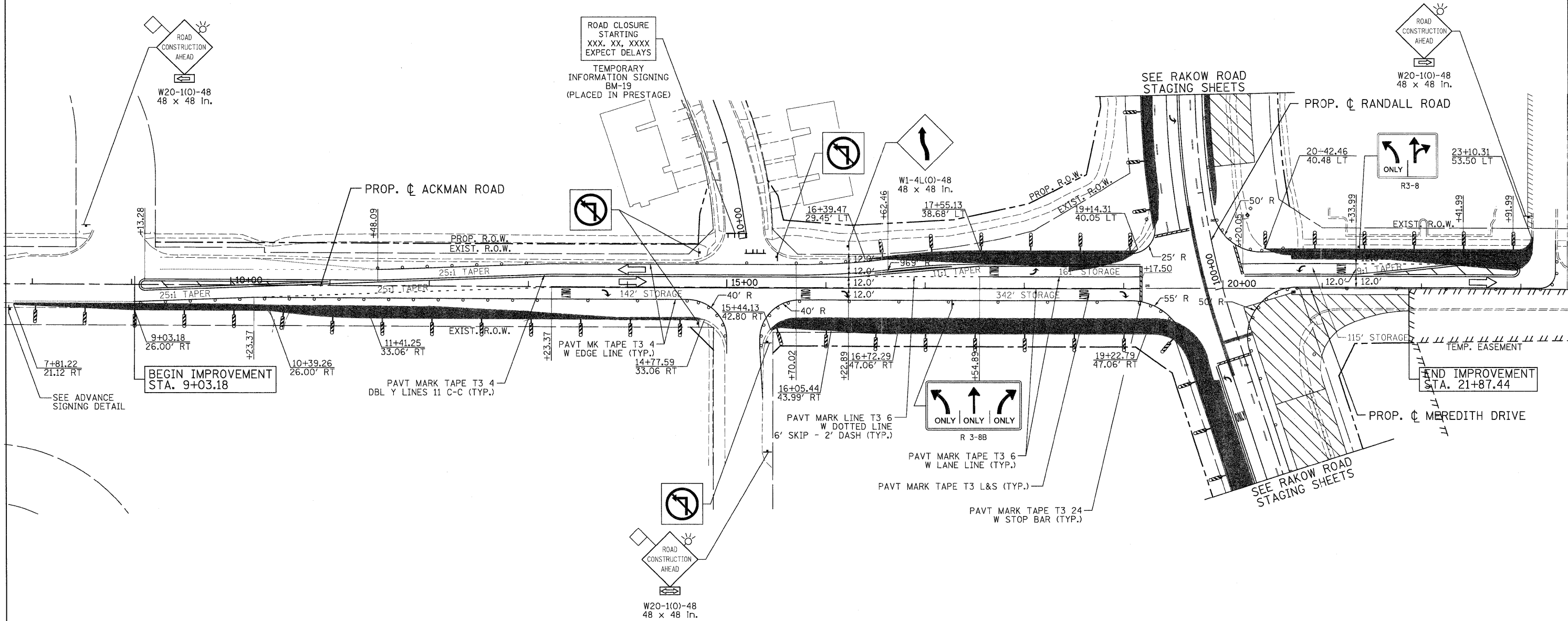
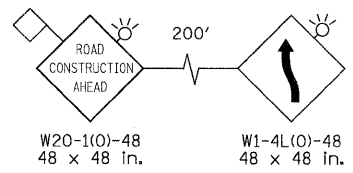

LEGEND		
	TEMPORARY PAVEMENT	
	WORK ZONE	
	DIRECTION OF TRAFFIC	
	TYPE II BARRICADES OR DRUMS WITH STEADY BURNING LIGHTS @ 50 FT CENTERS ALONG ROADWAY (TANGENT), 25 FT CENTERS ALONG TAPERS AND 12 FT CENTERS ALONG RADII	
	TYPE III BARRICADES WITH FLASHING LIGHTS	

<p>PATRICK ENGINEERING INC. LISLE, ILLINOIS</p>	USER NAME = Rdwy_L1s1e	DESIGNED - MJV	REVISED -
	PLOT CONFIG = PDF(Grey_Large).plt	DRAWN - EJB	REVISED -
	PLOT SCALE = 1:50	CHECKED - JAH	REVISED -
	PLOT DATE = 7/29/2010	DATE - 8/2/2010	REVISED -

MCHENRY COUNTY
DIVISION OF TRANSPORTATION

RAKOW ROAD FROM ACKMAN ROAD TO ILLINOIS ROUTE 31
SUGGESTED STAGING OF CONSTRUCTION & TRAFFIC CONTROL
ACKMAN ROAD STAGE 1A

SCALE: 1"=50' SHEET NO. MOT 41 OF 100 STA. 9+03.18 TO STA. 21+87.44

F.A.P. RTE. 0336	SECTION 05-00308-00-WR	COUNTY MCHENRY	TOTAL SHEETS 606	SHEET NO. 87
FED. ROAD DIST. NO. ILLINOIS FED. AID PROJECT		CONTRACT NO. 63398		

G:\MCDOT\2010\Drawings\RDWY\shits\MOT\07_S_MOT01(1)_AckmanRd.dgn