

ADVANCE SIGNING DETAIL:

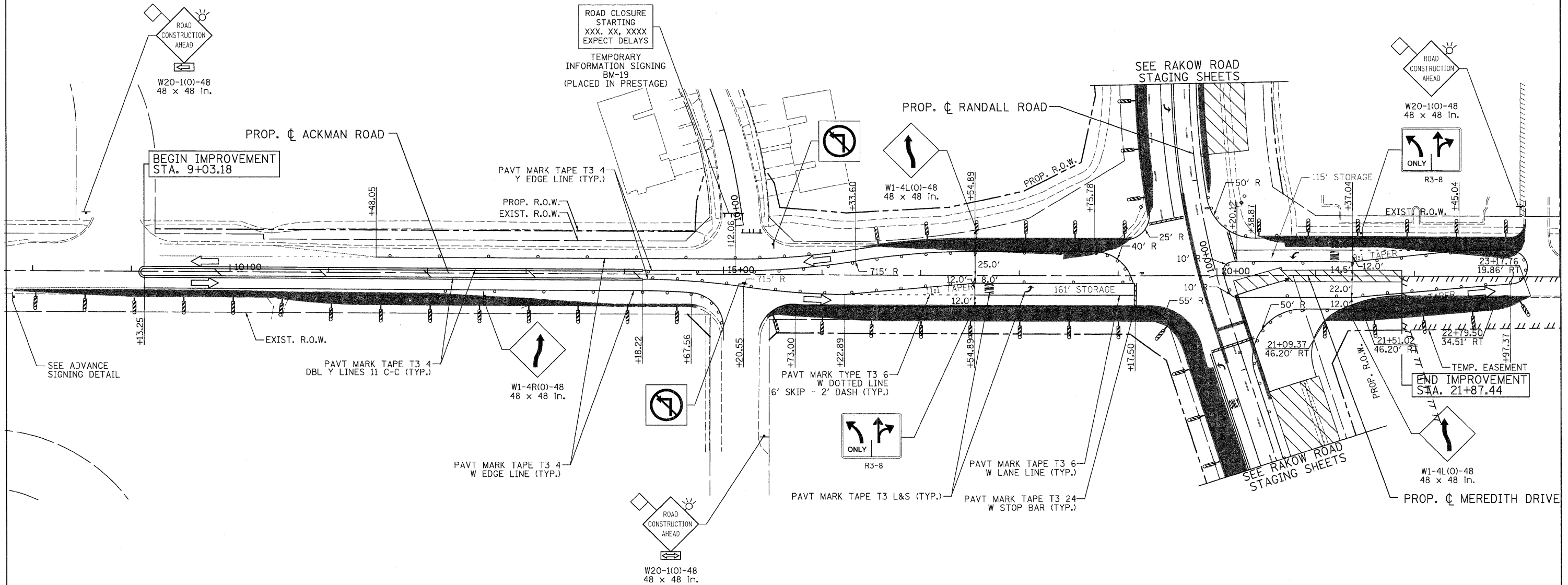
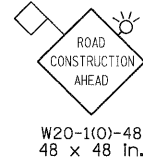

LEGEND

- TEMPORARY PAVEMENT
- WORK ZONE
- DIRECTION OF TRAFFIC
- TYPE II BARRICADES OR DRUMS WITH STEADY BURNING LIGHTS @ 50 FT CENTERS ALONG ROADWAY (TANGENT), 25 FT CENTERS ALONG TAPERS AND 12 FT CENTERS ALONG RADII
- VERTICAL PANEL WITH STEADY BURNING LIGHT 50 FT C-C
- TYPE III BARRICADES WITH FLASHING LIGHTS

<p>PATRICK ENGINEERING INC. LISLE, ILLINOIS</p>	USER NAME = Rdwy_Lisle	DESIGNED - MJV	REVISED -	<p>MCHENRY COUNTY DIVISION OF TRANSPORTATION</p>	<p>RAKOW ROAD FROM ACKMAN ROAD TO ILLINOIS ROUTE 31 SUGGESTED STAGING OF CONSTRUCTION & TRAFFIC CONTROL ACKMAN ROAD STAGE 1B</p>	F.A.P. RTE. 0336	SECTION 05-00308-00-WR	COUNTY MCHENRY	TOTAL SHEETS 606	SHEET NO. 88
	PLOT CONFID= PDF(Grey_Large).plt	DRAWN - EJB	REVISED -			SCALE: 1"=50'	SHEET NO. MOT 42 OF 100	STA. 9+03.18 TO STA. 21+87.44	FED. ROAD DIST. NO.	ILLINOIS FED. AID PROJECT
PLOT SCALE = 1:50	CHECKED - JAH	DATE - 8/2/2010	REVISED -							
PLOT DATE = 7/29/2010										

G:\MCDOT\20950_001\Drawings\RDW\shhs\MOT\08_S_MOT21(B)_AckmanRd.dgn