

ADVANCE SIGNING DETAIL:

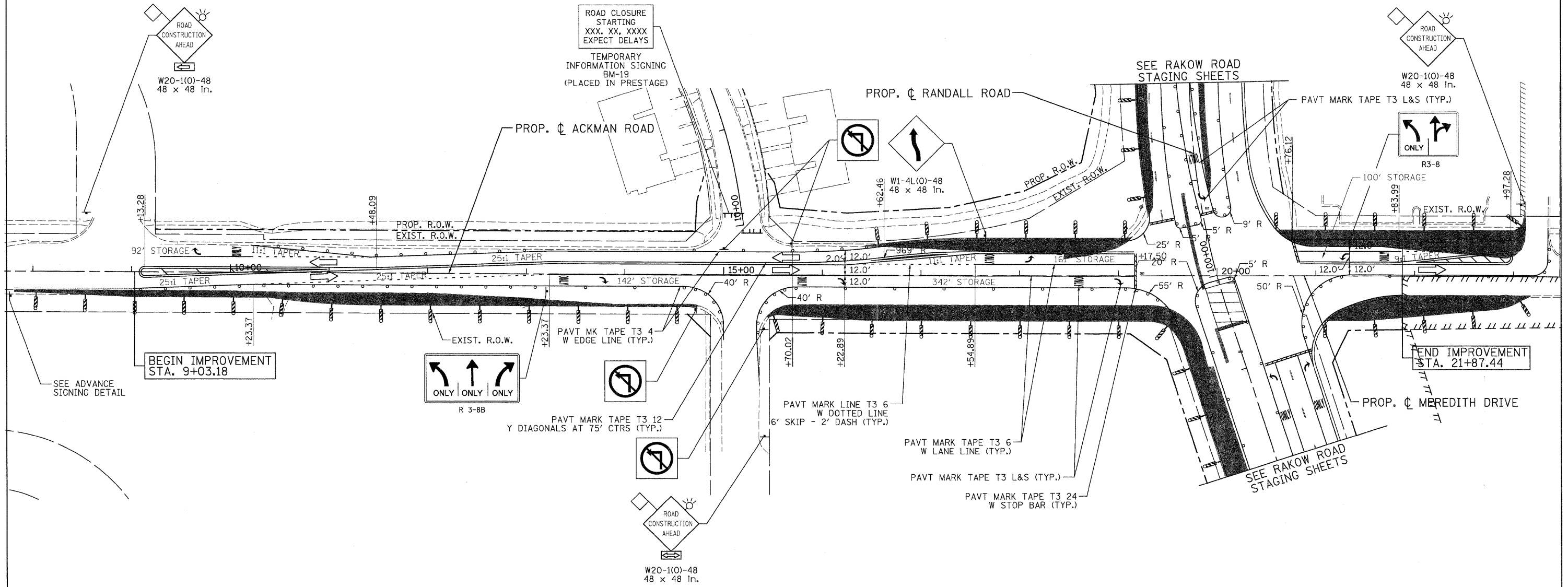

LEGEND			
	TEMPORARY PAVEMENT		TYPE II BARRICADES OR DRUMS WITH STEADY BURNING LIGHTS @ 50 FT CENTERS ALONG ROADWAY (TANGENT), 25 FT CENTERS ALONG TAPERS AND 12 FT CENTERS ALONG RADII
	WORK ZONE		VERTICAL PANEL WITH STEADY BURNING LIGHT 50 FT C-C
	DIRECTION OF TRAFFIC		TYPE III BARRICADES WITH FLASHING LIGHTS

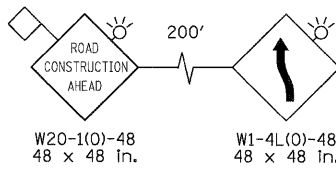

USER NAME = Rdkj.Lisle	DESIGNED - MJV	REVISED -
PLOT CONFIG = PDF(Gray_Large).plt	DRAWN - EJB	REVISED -
PLOT SCALE = 1:50	CHECKED - JAH	REVISED -
PLOT DATE = 7/29/2010	DATE - 8/2/2010	REVISED -



**MCHENRY COUNTY
DIVISION OF TRANSPORTATION**

**RAKOW ROAD FROM ACKMAN ROAD TO ILLINOIS ROUTE 31
SUGGESTED STAGING OF CONSTRUCTION & TRAFFIC CONTROL
ACKMAN ROAD STAGE 1D3**

SCALE: 1"=500' SHEET NO. MOT 62 OF 100 STA. 9+03.18 TO STA. 21+87.44

F.A.P. RTE. 0336	SECTION 05-00308-00-WR	COUNTY MCHENRY	TOTAL SHEETS 606	SHEET NO. 108
FED. ROAD DIST. NO. ILLINOIS		FED. AID PROJECT		
CONTRACT NO. 63398				

Q:\MCDOT\28958_001\Drawings\RDW\cmts\MOT\27_S.MOT81(03).l(ackmanRd).dgn