

LEGEND

- TEMPORARY PAVEMENT
- WORK ZONE
- DIRECTION OF TRAFFIC
- TYPE II BARRICADES OR DRUMS WITH STEADY BURNING LIGHTS @ 50 FT CENTERS ALONG ROADWAY (TANGENT), 25 FT CENTERS ALONG TAPERS AND 12 FT CENTERS ALONG RADII
- VERTICAL PANEL WITH STEADY BURNING LIGHT 50 FT C-C
- TYPE III BARRICADES WITH FLASHING LIGHTS

NOTES:

1. EXISTING BIKE PATH MUST REMAIN OPEN AT ALL TIMES WHILE THE PROPOSED BIKE PATH AND BRIDGE ARE BEING CONSTRUCTED
2. TYPE II BARRICADES WITH LIGHTS NEED TO BE INSTALLED ON BOTH SIDES OF THE TEMPORARY BIKE PATH THROUGH THE WORK ZONE.

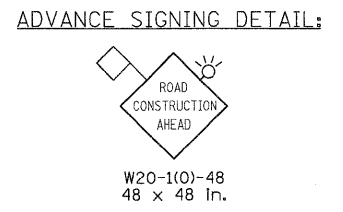
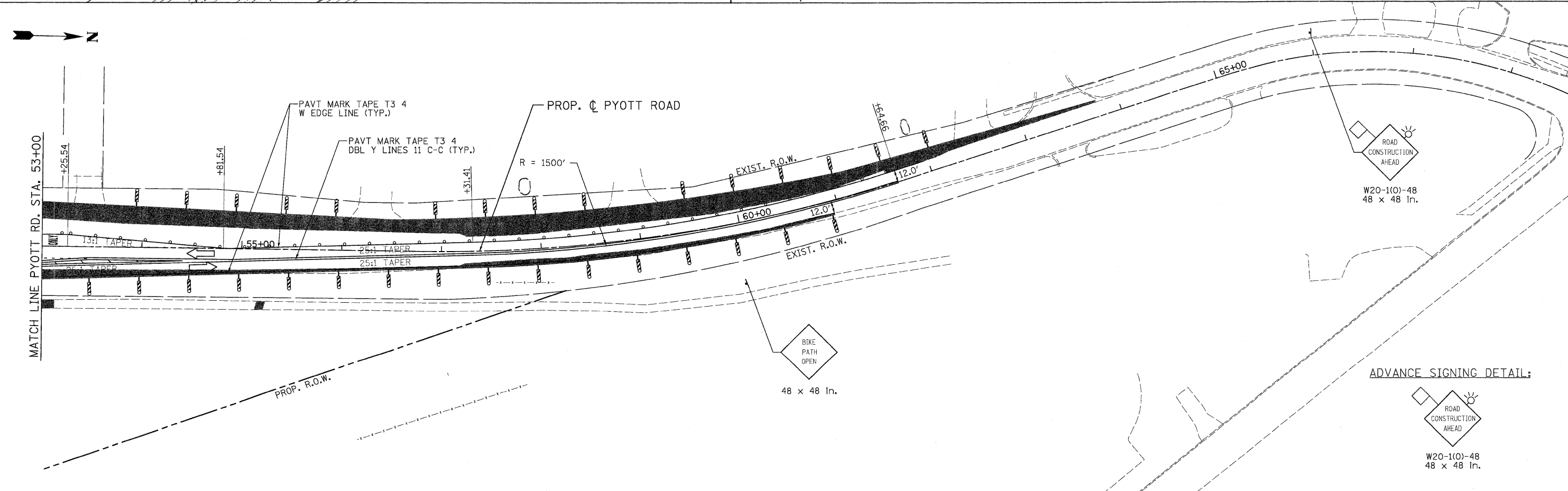
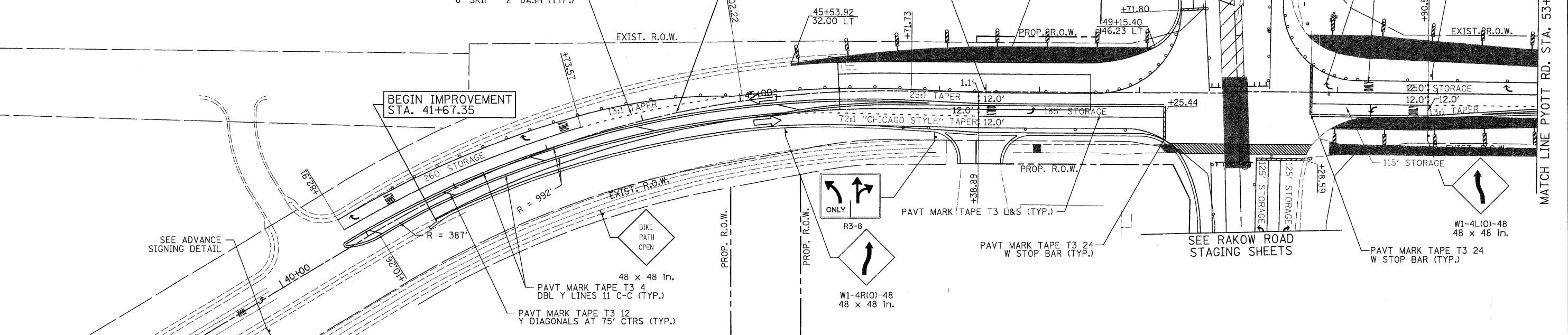

<p>PATRICK ENGINEERING INC. LISLE, ILLINOIS</p>	USER NAME = Rdwy_Lisle	DESIGNED - MJV	REVISED -	<p>MCHENRY COUNTY DIVISION OF TRANSPORTATION</p>	<p>RAKOW ROAD FROM ACKMAN ROAD TO ILLINOIS ROUTE 31 SUGGESTED STAGING OF CONSTRUCTION & TRAFFIC CONTROL PYOTT ROAD STAGE 1D1</p>	F.A.P. RTE. = 0336	SECTION = 05-00308-00-WR	COUNTY = MCHENRY	TOTAL SHEETS = 606	SHEET NO. = 112
	PLOT CONFIG = PDF(Grey_Large).plt	DRAWN - EJB	REVISED -			SCALE: 1"=50'	SHEET NO. MOT 66 OF 100	STA. 41+67.35 TO STA. 65+57.25	FED. ROAD DIST. NO. = ILLINOIS	FED. AID PROJECT
PLOT SCALE = 1:50	CHECKED - JAH	REVISED -	REVISED -							
PLOT DATE = 7/29/2010	DATE = 8/2/2010	REVISED -	REVISED -							

G:\MCDOT\2010\Drawings\RDWY\shs\MOT\38A_S_MOT0101_Pyott.dgn