

**LEGEND**

	TEMPORARY PAVEMENT		○ TYPE II BARRICADES OR DRUMS WITH STEADY BURNING LIGHTS @ 50 FT CENTERS ALONG ROADWAY (TANGENT), 25 FT CENTERS ALONG TAPERS AND 12 FT CENTERS ALONG RADII		VERTICAL PANEL WITH STEADY BURNING LIGHT 50 FT C-C
	WORK ZONE		▮ TYPE III BARRICADES WITH FLASHING LIGHTS		
	DIRECTION OF TRAFFIC				

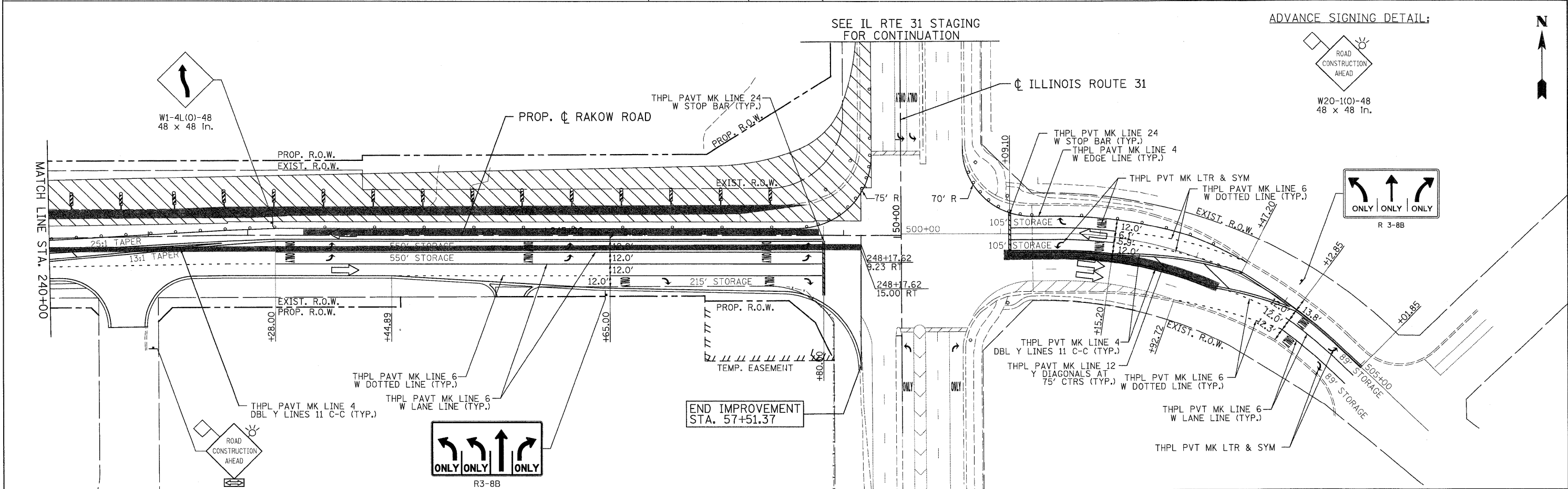

<b>PATRICK ENGINEERING INC.</b> LISLE, ILLINOIS	USER NAME = Rdwg_Lisle	DESIGNED - MJV	REVISED -		<b>MCHENRY COUNTY</b> DIVISION OF TRANSPORTATION			<b>RAKOW ROAD FROM ACKMAN ROAD TO ILLINOIS ROUTE 31</b> SUGGESTED STAGING OF CONSTRUCTION & TRAFFIC CONTROL RAKOW ROAD STAGE 2			F.A.P. RTE. 0336	SECTION 05-00308-00-WR	COUNTY MCHENRY	TOTAL SHEETS 606	SHEET NO. 120	
	PLOT CONFIG= PDF(Grey_Large).plt	DRAWN - EJB	REVISED -								FED. ROAD DIST. NO.	ILLINOIS FED. AID PROJECT	CONTRACT NO. 63398			
	PLOT SCALE = 1:150	CHECKED - JAH	REVISED -								SCALE: 1"=50'	SHEET NO. MOT 74 OF 100	STA. 225+00 TO STA. PROJECT END			
	PLOT DATE = 7/29/2010	DATE - 8/2/2010	REVISED -													