

ADVANCE SIGNING DETAIL:

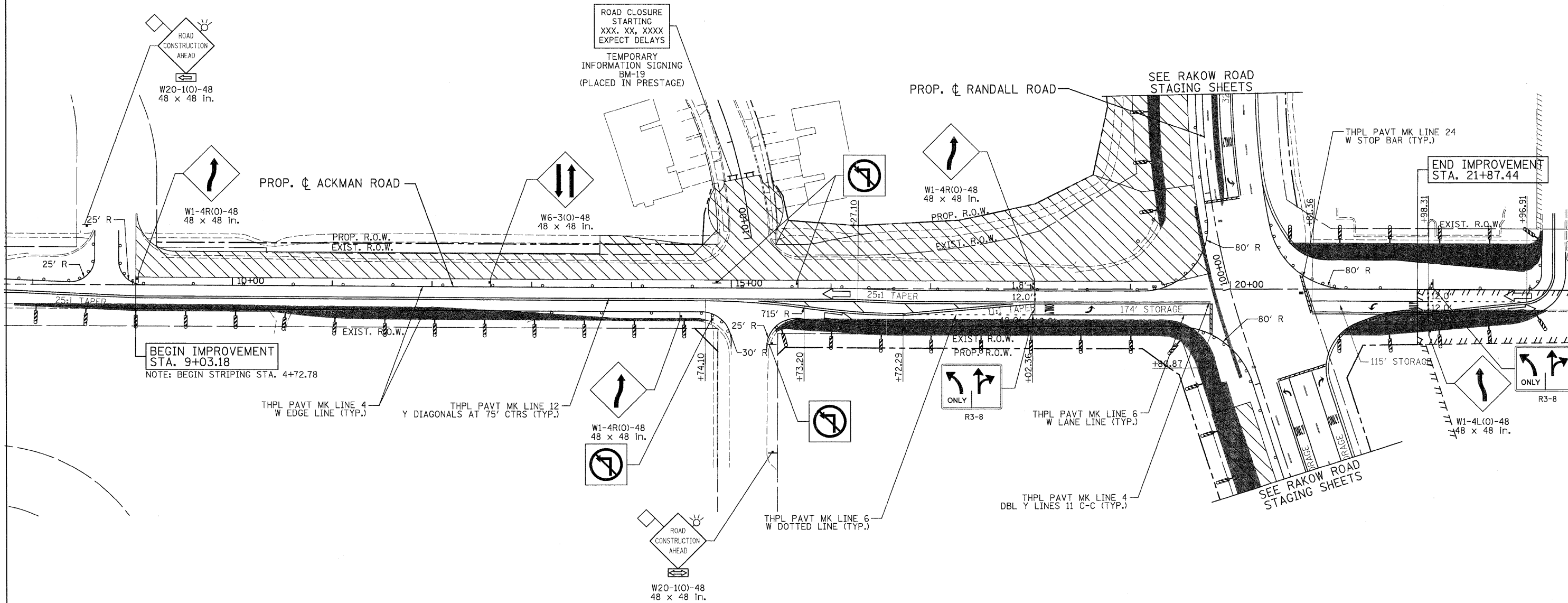

LEGEND

- TEMPORARY PAVEMENT
- WORK ZONE
- DIRECTION OF TRAFFIC
- TYPE II BARRICADES OR DRUMS WITH STEADY BURNING LIGHTS @ 50 FT CENTERS ALONG ROADWAY (TANGENT), 25 FT CENTERS ALONG TAPERS AND 12 FT CENTERS ALONG RADII
- VERTICAL PANEL WITH STEADY BURNING LIGHT 50 FT C-C
- TYPE III BARRICADES WITH FLASHING LIGHTS

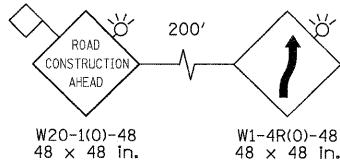

USER NAME = Rdwy_Lisle	DESIGNED - MJV	REVISED -
PLOT CONFIG = PDF(Grey_Large).plt	DRAWN - EJB	REVISED -
PLOT SCALE = 1:50	CHECKED - JAH	REVISED -
PLOT DATE = 7/29/2010	DATE - 8/2/2010	REVISED -



MCHENRY COUNTY
DIVISION OF TRANSPORTATION

RAKOW ROAD FROM ACKMAN ROAD TO ILLINOIS ROUTE 31
SUGGESTED STAGING OF CONSTRUCTION & TRAFFIC CONTROL
ACKMAN ROAD STAGE 2A

F.A.P. RTE. 0336	SECTION 05-00308-00-WR	COUNTY MCHENRY	TOTAL SHEETS 606	SHEET NO. 121
FED. ROAD DIST. NO. ILLINOIS FED. AID PROJECT		CONTRACT NO. 63398		

SCALE: 1"=50' SHEET NO. MOT 75 OF 100 END OF IMPROVEMENT TO STA. 22+00