

ADVANCE SIGNING DETAIL:

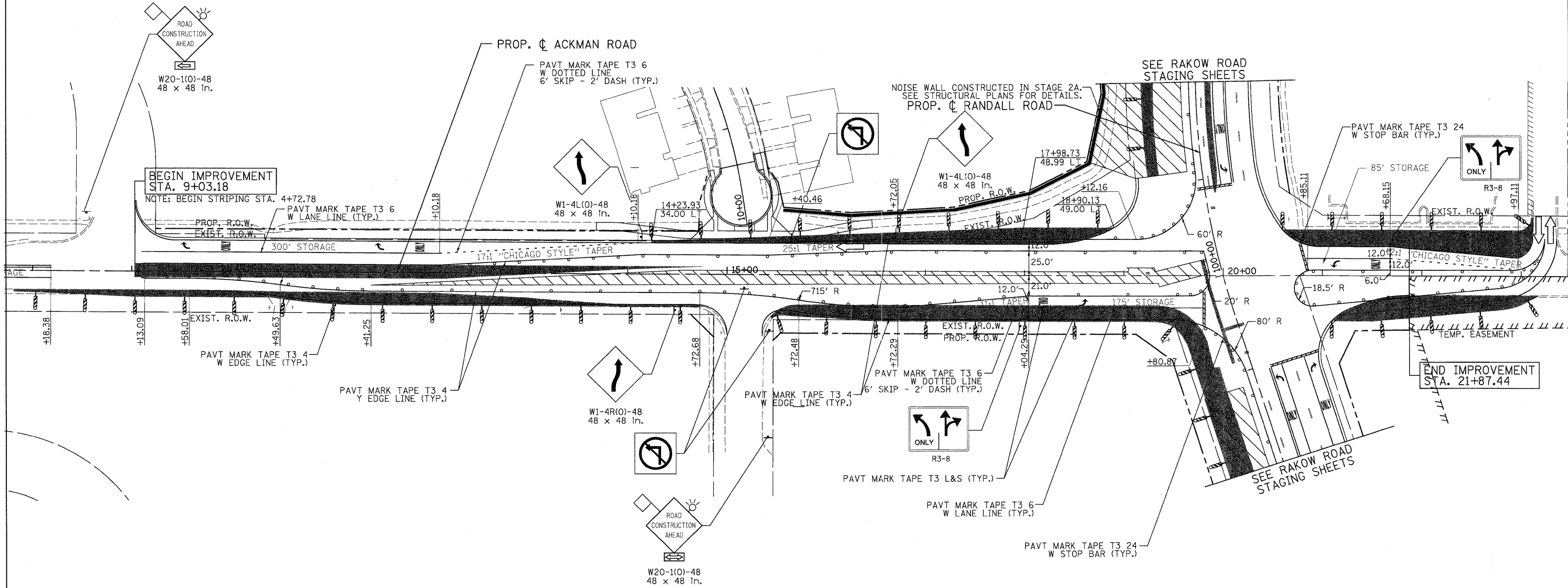

**LEGEND**

TEMPORARY PAVEMENT	TYPE II BARRICADES OR DRUMS WITH STEADY BURNING LIGHTS @ 50 FT CENTERS ALONG ROADWAY (TANGENT), 25 FT CENTERS ALONG TAPERS AND 12 FT CENTERS ALONG RADII	VERTICAL PANEL WITH STEADY BURNING LIGHT 50 FT C-C
WORK ZONE	TYPE III BARRICADES WITH FLASHING LIGHTS	
DIRECTION OF TRAFFIC		

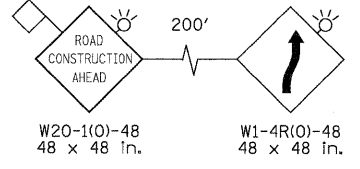

USER NAME = Rdky.Lisle	DESIGNED - MJV	REVISED -
PLOT CONFIG = PDF(Grey, Large).plt	DRAWN - EJB	REVISED -
PLOT SCALE = 1:50	CHECKED - JAH	REVISED -
PLOT DATE = 7/29/2010	DATE - 8/2/2010	REVISED -



**MCHENRY COUNTY  
DIVISION OF TRANSPORTATION**

**RAKOW ROAD FROM ACKMAN ROAD TO ILLINOIS ROUTE 31  
SUGGESTED STAGING OF CONSTRUCTION & TRAFFIC CONTROL  
ACKMAN ROAD STAGE 2B**

F.A.P. RTE. 0336	SECTION 05-00308-00-WR	COUNTY MCHENRY	TOTAL SHEETS 606	SHEET NO. 122
FED. ROAD DIST. NO. ILLINOIS FED. AID PROJECT		CONTRACT NO. 63398		