

ADVANCE SIGNING DETAIL:

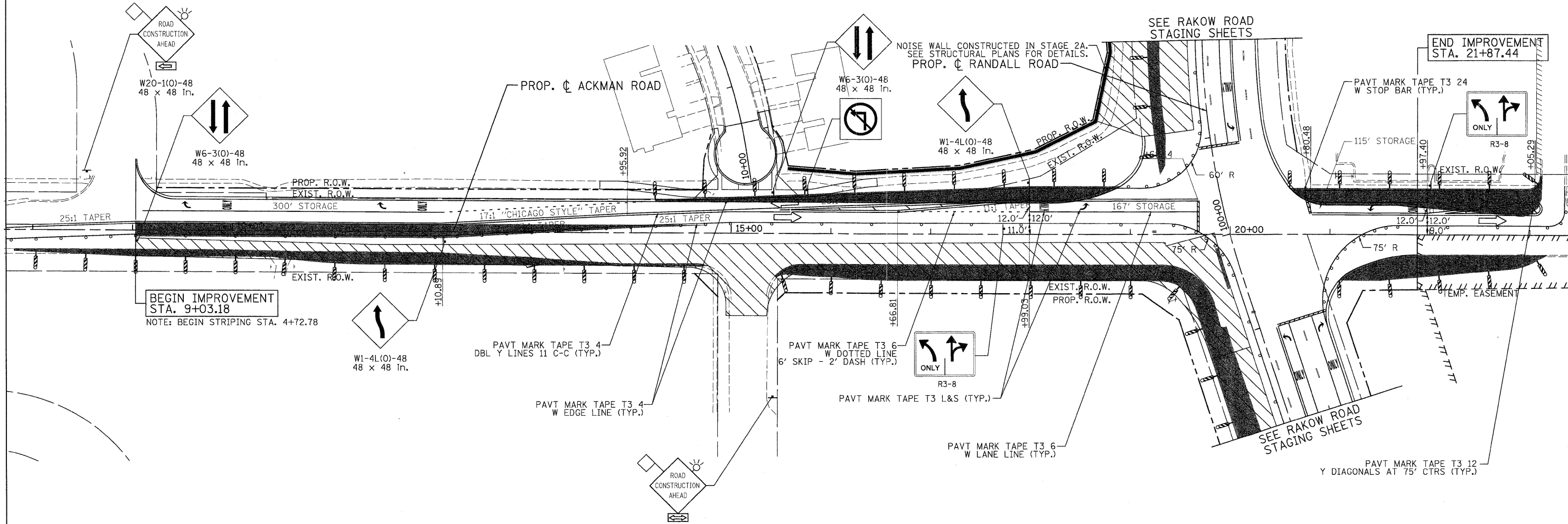
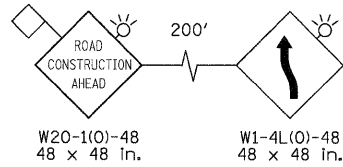

LEGEND			
	TEMPORARY PAVEMENT		TYPE II BARRICADES OR DRUMS WITH STEADY BURNING LIGHTS @ 50 FT CENTERS ALONG ROADWAY (TANGENT), 25 FT CENTERS ALONG TAPERS AND 12 FT CENTERS ALONG RADII
	WORK ZONE		VERTICAL PANEL WITH STEADY BURNING LIGHT 50 FT C-C
	DIRECTION OF TRAFFIC		TYPE III BARRICADES WITH FLASHING LIGHTS

<p>PATRICK ENGINEERING INC. LISLE, ILLINOIS</p>	USER NAME = Rdky_Lisle PLOT CONFIG = PDF(Gray, Large).plt PLOT SCALE = 1:50 PLOT DATE = 7/29/2010	DESIGNED - MJV DRAWN - EJB CHECKED - JAH DATE - 8/2/2010	REVISED - REVISED - REVISED - REVISED -	<p>MCHENRY COUNTY DIVISION OF TRANSPORTATION</p>	<p>RAKOW ROAD FROM ACKMAN ROAD TO ILLINOIS ROUTE 31 SUGGESTED STAGING OF CONSTRUCTION & TRAFFIC CONTROL ACKMAN ROAD STAGE 2C</p>	F.A.P. RTE. 0336 SECTION 05-00308-00-WR COUNTY MCHENRY TOTAL SHEETS 606 SHEET NO. 123	CONTRACT NO. 63398
	SCALE: 1"=50' SHEET NO. MOT 77 OF 100 END OF IMPROVEMENT TO STA. 22+00	FED. ROAD DIST. NO. ILLINOIS FED. AID PROJECT					

G:\MCDOT\20950_001\Drawings\ROW\shhs\MOT\39_S_MOT02(C)\AckmanRd.dgn