

LEGEND

- TEMPORARY PAVEMENT
- WORK ZONE
- DIRECTION OF TRAFFIC
- TYPE II BARRICADES OR DRUMS WITH STEADY BURNING LIGHTS @ 50 FT CENTERS ALONG ROADWAY (TANGENT), 25 FT CENTERS ALONG TAPERS AND 12 FT CENTERS ALONG RADII
- VERTICAL PANEL WITH STEADY BURNING LIGHT 50 FT C-C
- TYPE III BARRICADES WITH FLASHING LIGHTS

NOTES:

1. EXISTING BIKE PATH MUST REMAIN OPEN AT ALL TIMES WHILE THE PROPOSED BIKE PATH AND BRIDGE ARE BEING CONSTRUCTED
2. TYPE II BARRICADES WITH LIGHTS NEED TO BE INSTALLED ON BOTH SIDES OF THE TEMPORARY BIKE PATH THROUGH THE WORK ZONE.

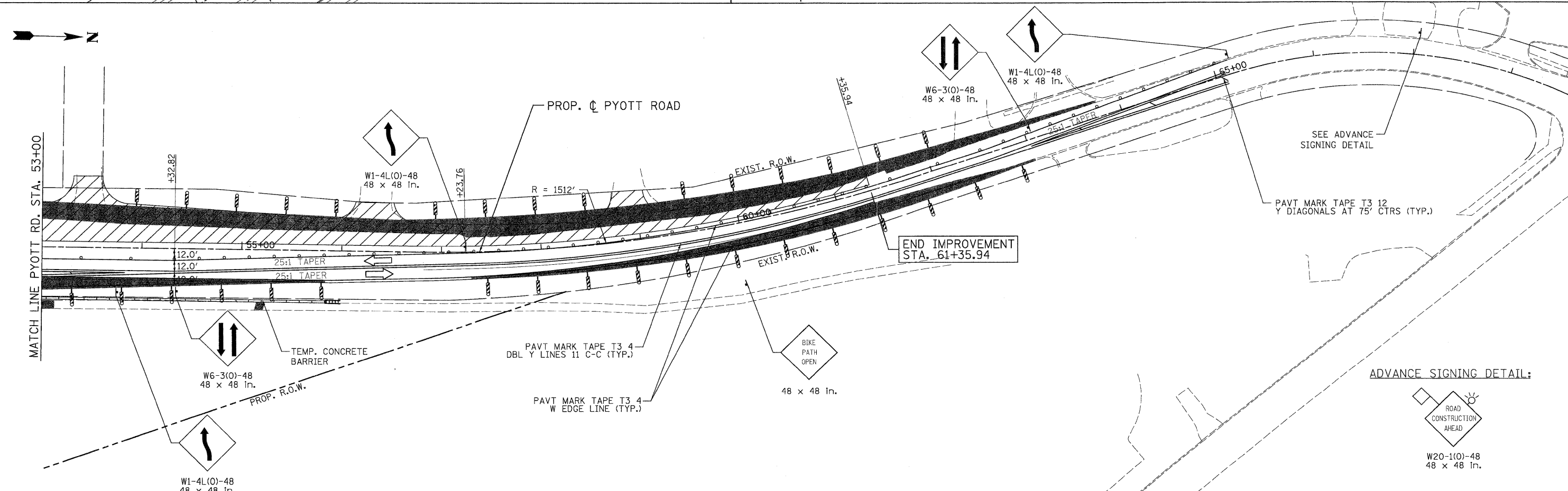
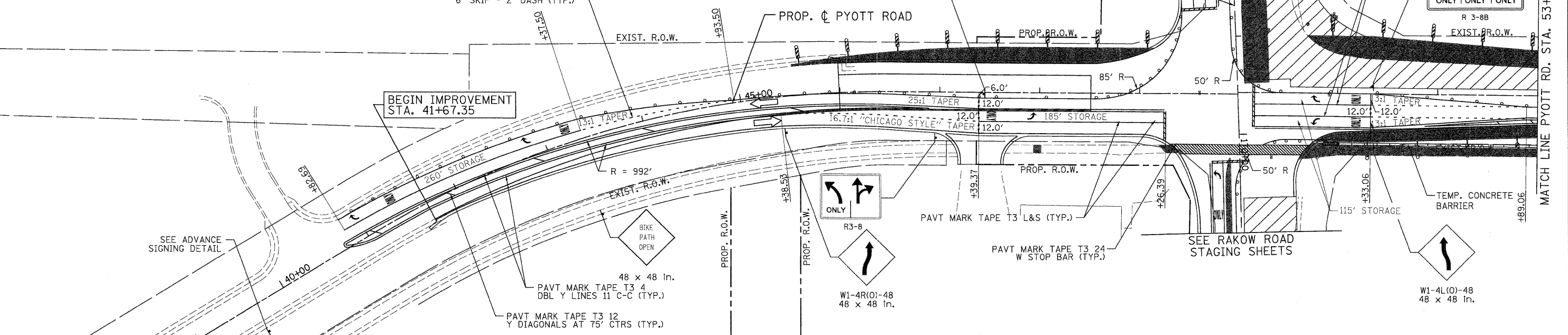

 PATRICK ENGINEERING INC. LISLE, ILLINOIS	USER NAME = Rdwg_Lisle PLOT CONFIG = PDF(Greg_Large).plt PLOT SCALE = 1:50 PLOT DATE = 7/29/2010	DESIGNED - MJV DRAWN - EJB CHECKED - JAH DATE - 8/2/2010	REVISED - REVISED - REVISED - REVISED -	 MCHENRY COUNTY DIVISION OF TRANSPORTATION	RAKOW ROAD FROM ACKMAN ROAD TO ILLINOIS ROUTE 31 SUGGESTED STAGING OF CONSTRUCTION & TRAFFIC CONTROL PYOTT ROAD STAGE 2C	F.A.P. RTE. 0336 SECTION 05-00308-00-WR COUNTY MCHENRY CONTRACT NO. 63398	TOTAL SHEETS 606 SHEET NO. 129 FED. ROAD DIST. NO. ILLINOIS FED. AID PROJECT
	SCALE: 1"=50' SHEET NO. MOT 83 OF 100 STA. 41+67.35 TO STA. 61+35.94						

G:\MCDOT\209588_001\Drawings\RDWY\shfts\MOT\45_S.MOT82C1\Pyott.dgn