

**LEGEND**

	TEMPORARY PAVEMENT		TYPE II BARRICADES OR DRUMS WITH STEADY BURNING LIGHTS @ 50 FT CENTERS ALONG ROADWAY (TANGENT), 25 FT CENTERS ALONG TAPERS AND 12 FT CENTERS ALONG RADII		VERTICAL PANEL WITH STEADY BURNING LIGHT 50 FT C-C
	WORK ZONE		TYPE III BARRICADES WITH FLASHING LIGHTS		
	DIRECTION OF TRAFFIC				

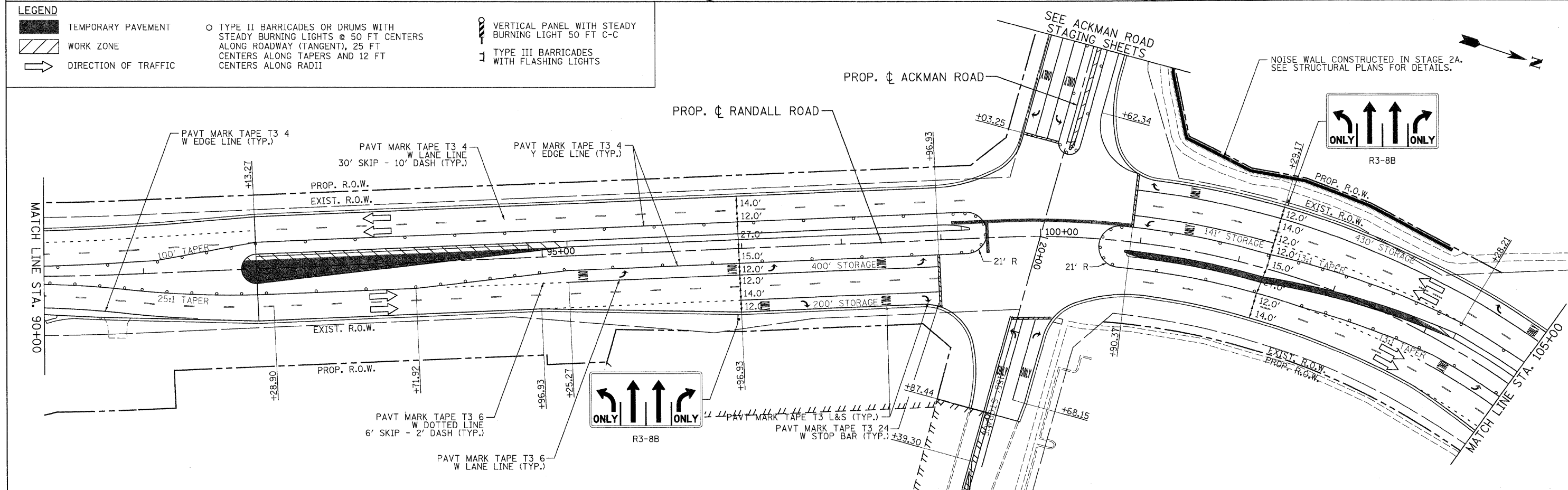

<b>PATRICK ENGINEERING INC.</b> LISLE, ILLINOIS	USER NAME = Rdey.Lisle PLOT CONFIG = PDFIGreg.Large.plt PLOT SCALE = 1:50 PLOT DATE = 7/29/2010	DESIGNED - MJV DRAWN - EJB CHECKED - JAH DATE - 8/2/2010	REVISED - REVISED - REVISED - REVISED -	<b>MCHENRY COUNTY</b> DIVISION OF TRANSPORTATION	<b>RAKOW ROAD FROM ACKMAN ROAD TO ILLINOIS ROUTE 31</b> <b>SUGGESTED STAGING OF CONSTRUCTION &amp; TRAFFIC CONTROL</b> <b>RAKOW ROAD STAGE 3</b>		F.A.P. RTE. 0336 SECTION 05-00308-00-WR COUNTY MCHENRY TOTAL SHEETS 606 SHEET NO. 138	CONTRACT NO. 63398
	SCALE: 1/4"=50'    SHEET NO. MOT 92 OF 100    STA. PROJ. START TO STA. 105+00					FED. ROAD DIST. NO. ILLINOIS FED. AID PROJECT		

G:\MCDOT\22950\_001\Drawings\RDWY\sh\ta\MOT\53.S.MOT03.01.dgn