

LEGEND

	TEMPORARY PAVEMENT		TYPE II BARRICADES OR DRUMS WITH STEADY BURNING LIGHTS @ 50 FT CENTERS ALONG ROADWAY (TANGENT), 25 FT CENTERS ALONG TAPERS AND 12 FT CENTERS ALONG RADII
	WORK ZONE		TYPE III BARRICADES WITH FLASHING LIGHTS
	DIRECTION OF TRAFFIC		VERTICAL PANEL WITH STEADY BURNING LIGHT 50 FT C-C

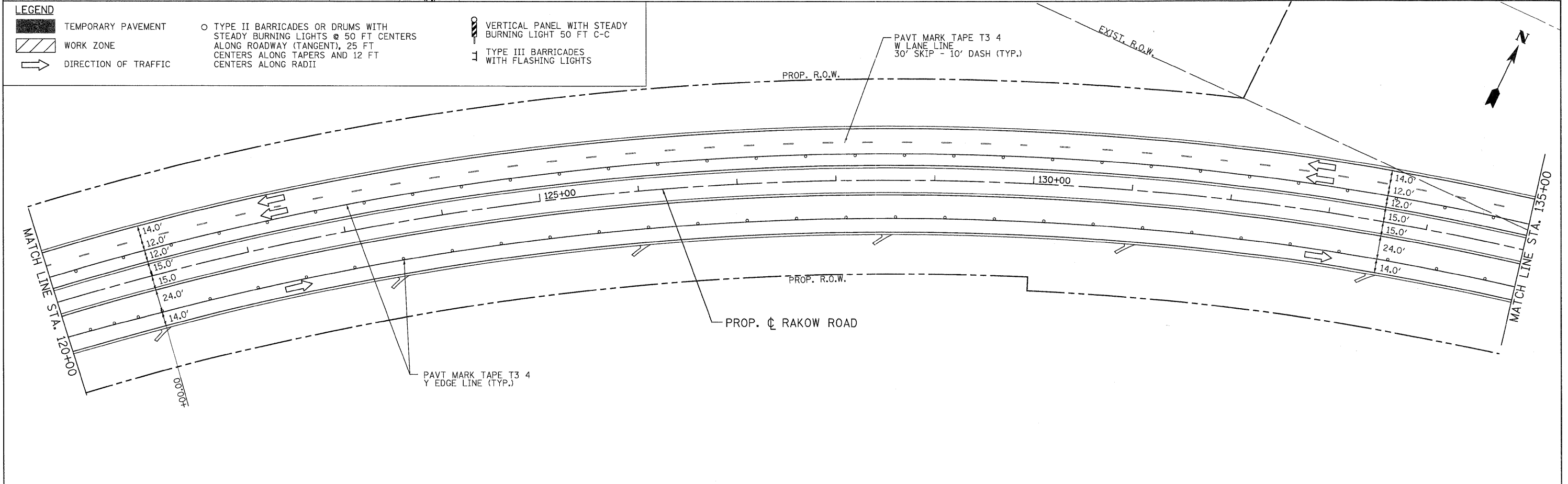

PATRICK ENGINEERING INC. LISLE, ILLINOIS	USER NAME = Rdwg_Lisle PLOT CONFIG = PDF(Grey_Large).plt PLOT SCALE = 1:50 PLOT DATE = 7/29/2010	DESIGNED - MJV DRAWN - EJB CHECKED - JAH DATE - 8/2/2010	REVISED - REVISED - REVISED - REVISED -	MCHENRY COUNTY DIVISION OF TRANSPORTATION	RAKOW ROAD FROM ACKMAN ROAD TO ILLINOIS ROUTE 31 SUGGESTED STAGING OF CONSTRUCTION & TRAFFIC CONTROL RAKOW ROAD STAGE 3	F.A.P. RTE. 0336	SECTION 05-00308-00-WR	COUNTY MCHENRY	TOTAL SHEETS 606	SHEET NO. 139
	SCALE: 1"=50' SHEET NO. MOT 93 OF 100 STA. 105+00 TO STA. 135+00	FED. ROAD DIST. NO. ILLINOIS FED. AID PROJECT				CONTRACT NO. 63398				

G:\MCDOT\20950_001\Drawings\RDWY\shhs\MOT\54_S_MOT83_02.dgn