

LEGEND

	TEMPORARY PAVEMENT		TYPE II BARRICADES OR DRUMS WITH STEADY BURNING LIGHTS @ 50 FT CENTERS ALONG ROADWAY (TANGENT), 25 FT CENTERS ALONG TAPERS AND 12 FT CENTERS ALONG RADII		VERTICAL PANEL WITH STEADY BURNING LIGHT 50 FT C-C
	WORK ZONE		TYPE III BARRICADES WITH FLASHING LIGHTS		
	DIRECTION OF TRAFFIC				

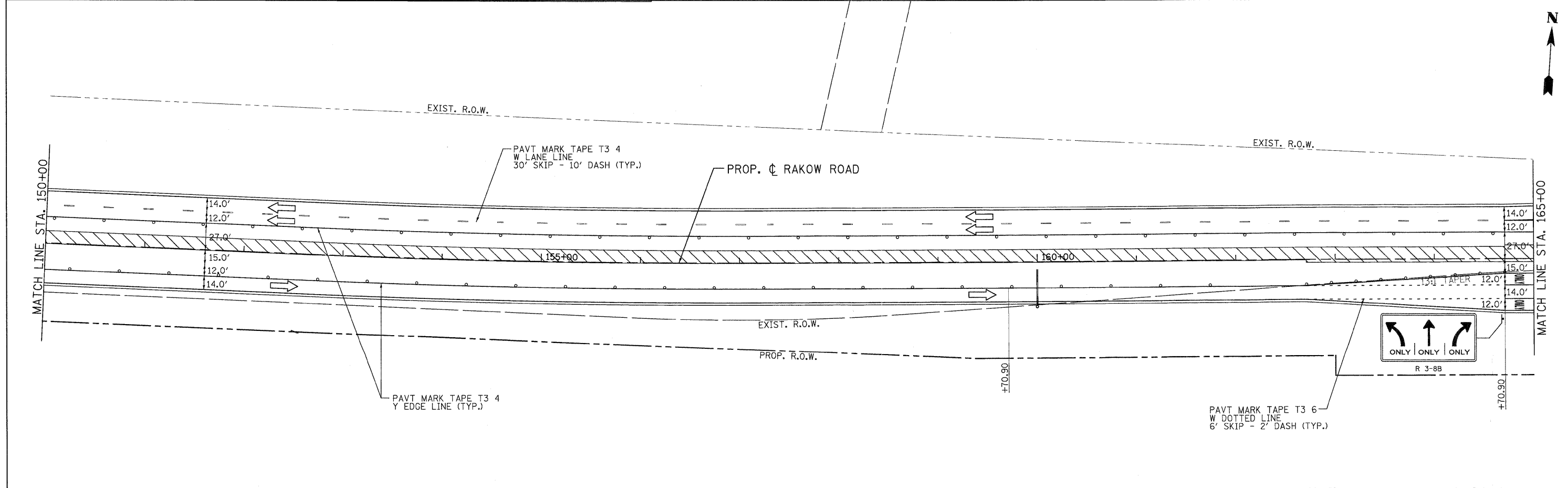

PATRICK ENGINEERING INC. LISLE, ILLINOIS	USER NAME = Rdey.Lisle	DESIGNED - MJV	REVISED -	MCHENRY COUNTY DIVISION OF TRANSPORTATION	RAKOW ROAD FROM ACKMAN ROAD TO ILLINOIS ROUTE 31 SUGGESTED STAGING OF CONSTRUCTION & TRAFFIC CONTROL RAKOW ROAD STAGE 3			F.A.P. RTE. 0336	SECTION 05-00308-00-WR	COUNTY MCHENRY	TOTAL SHEETS 606	SHEET NO. 140
	PLOT CONFIG = PDF(Grey.Large).plt	DRAWN - EJB	REVISED -		SCALE: 1"=50'	SHEET NO. MOT 94 OF 100	STA. 135+00 TO STA. 165+00	FED. ROAD DIST. NO. ILLINOIS FED. AID PROJECT	CONTRACT NO. 63398			
PLOT SCALE = 1:500	CHECKED - JAH	REVISED -										
PLOT DATE = 7/29/2010	DATE - 8/2/2010	REVISED -										

G:\MCDOT\20950_001\Drawings\RDW\shsta\MOT\55.S.MOT83_03.dgn