

PLAN	DATE
SURVEYED	BY
PLOTTED	
NOTE BOOK	
NO.	

PROFILE	DATE
SURVEYED	BY
PLOTTED	
NOTE BOOK	
NO.	

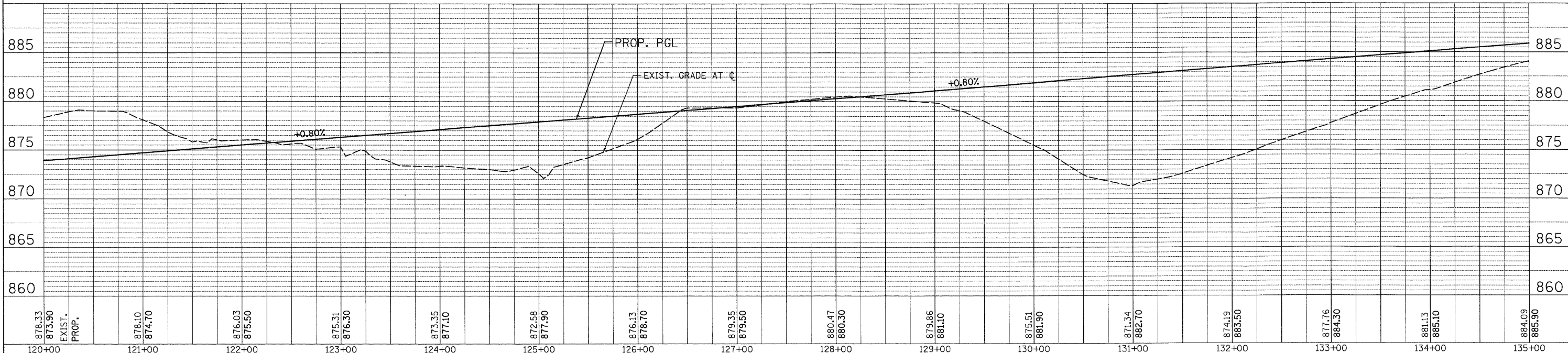

878.33 873.90 EXIST. PROP.	878.10 874.70	876.03 875.50	875.31 876.30	873.35 877.10	872.58 877.90	876.13 878.70	879.35 879.50	880.47 880.30	879.86 881.10	875.51 881.90	871.34 882.70	874.19 883.50	877.76 884.30	881.13 885.10	884.09 885.90
120+00	121+00	122+00	123+00	124+00	125+00	126+00	127+00	128+00	129+00	130+00	131+00	132+00	133+00	134+00	135+00

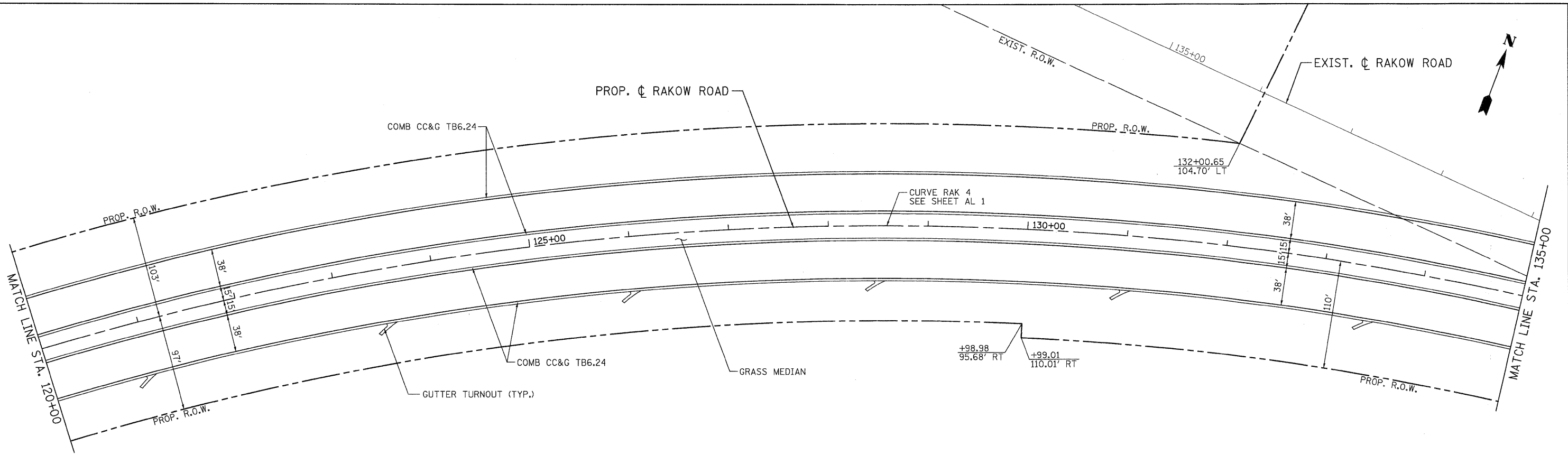

USER NAME = Rdwy_Lisle
 PLOT CONFIG = PDF(Grey, Large).plt
 PLOT SCALE = 1:50
 PLOT DATE = 7/28/2010 10:27:37 PM

DESIGNED - MJP
 DRAWN - TCK
 CHECKED - JAH
 DATE - 8/2/2010



**MCHENRY COUNTY
 DIVISION OF TRANSPORTATION**

**RAKOW ROAD FROM ACKMAN ROAD TO ILLINOIS ROUTE 31
 RAKOW ROAD PROPOSED ROADWAY PLAN AND PROFILE**

SCALE: 1"=50' SHEET NO. PP 5 OF 25 STA. 120+00 TO STA. 135+00

F.A. RTE.	SECTION	COUNTY	TOTAL SHEETS	SHEET NO.
0336	05-00308-00-WR	MCHENRY	606	151
FED. ROAD DIST. NO.			ILLINOIS FED. AID PROJECT	
			CONTRACT NO. 63398	

G:\MCDOT\22950\001\Drawings\RDWY\shhs\RAKS_PP_05.dgn