

DATE	
BY	
REVISIONS	
NO.	
DATE	
BY	
REVISIONS	
NO.	
DATE	
BY	
REVISIONS	
NO.	

DATE	
BY	
REVISIONS	
NO.	
DATE	
BY	
REVISIONS	
NO.	
DATE	
BY	
REVISIONS	
NO.	

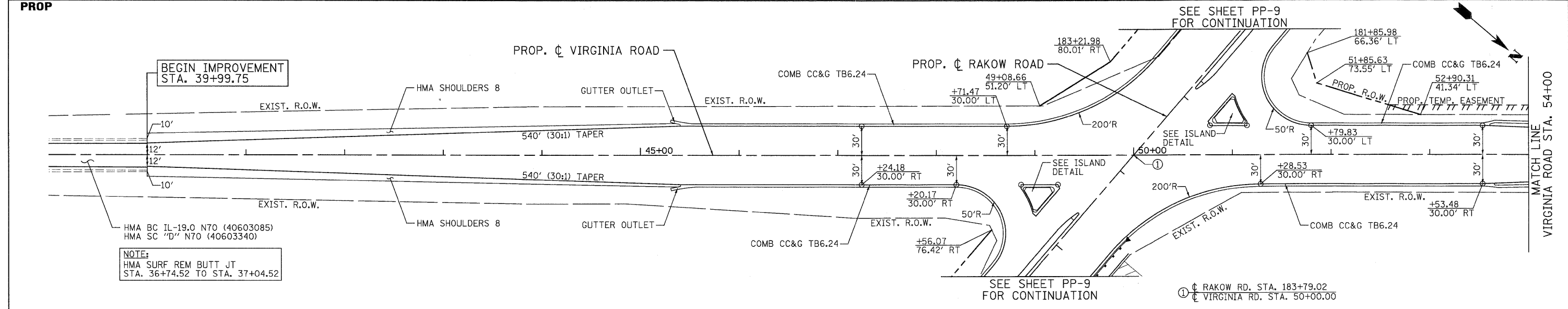
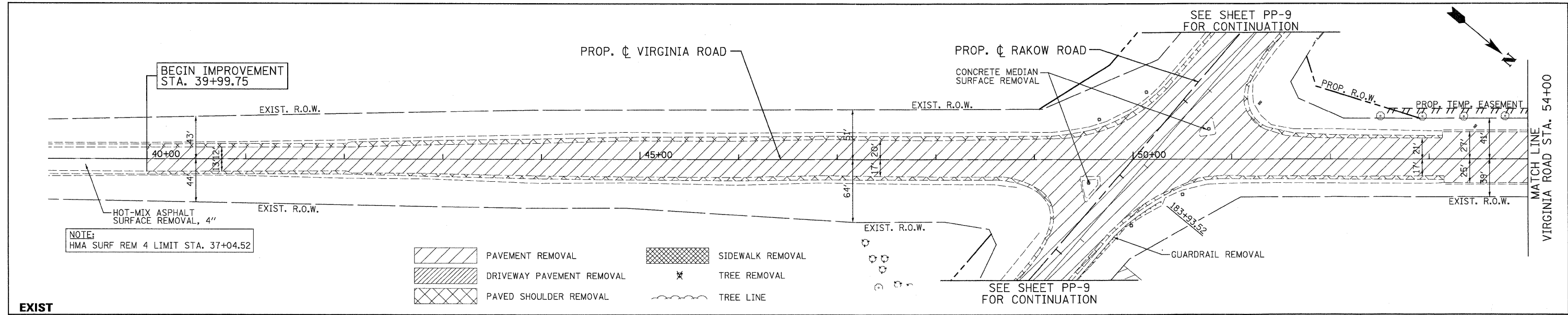

890.51	890.77	890.89	891.09	891.29	891.38	891.69	891.57	892.09	891.84	892.49	891.90	892.86	891.85	892.59	891.32	891.67	890.42	890.72	889.58	889.77	889.68	889.76	889.05	889.46	889.14	889.96	889.34	890.40	889.53	890.28
39+00	40+00	41+00	42+00	43+00	44+00	45+00	46+00	47+00	48+00	49+00	50+00	51+00	52+00	53+00	54+00															

USER NAME = Rdwy.Lisle  
 PLOT CONFIG = PDF(Gray.Large).plt  
 PLOT SCALE = 1:500  
 PLOT DATE = 7/28/2010 10:29:51 PM

DESIGNED - MJP  
 DRAWN - TCK  
 CHECKED - JAH  
 DATE - 8/2/2010

**MCHENRY COUNTY**  
**DIVISION OF TRANSPORTATION**

**RAKOW ROAD FROM ACKMAN ROAD TO ILLINOIS ROUTE 31**  
**VIRGINIA ROAD PROPOSED ROADWAY PLAN AND PROFILE**

F.A. RTE. 0336  
 SECTION 05-00308-00-WR  
 COUNTY MCHENRY  
 CONTRACT NO. 63398

SCALE: 1"=50' SHEET NO. PP 19 OF 25 STA. 39+99.75 TO STA. 54+00  
 FEDERAL AID PROJECT

G:\MCDOT\20950\001\Drawings\RDW\shs\rd\5\_PP\_19\_Virginia.dgn