





DATE: _____ BY: _____
 SURVEYED: _____ PLOTTED: _____
 PLAN: _____ CHECKED: _____
 NOTE BOOK: _____ AT: _____
 NO. _____ OF WAY CHECKED: _____
 DATE FILE NAME: _____

DATE: _____ BY: _____
 PROFILE: _____ SURVEYED: _____
 NOTE BOOK: _____ CHECKED: _____
 NO. _____ OF WAY CHECKED: _____
 STRUCTURE NOTATIONS CHECKED: _____

-  PAVEMENT REMOVAL
-  DRIVEWAY PAVEMENT REMOVAL
-  PAVED SHOULDER REMOVAL
-  SIDEWALK REMOVAL
-  TREE REMOVAL
-  TREE LINE

EXIST
PROP

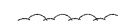
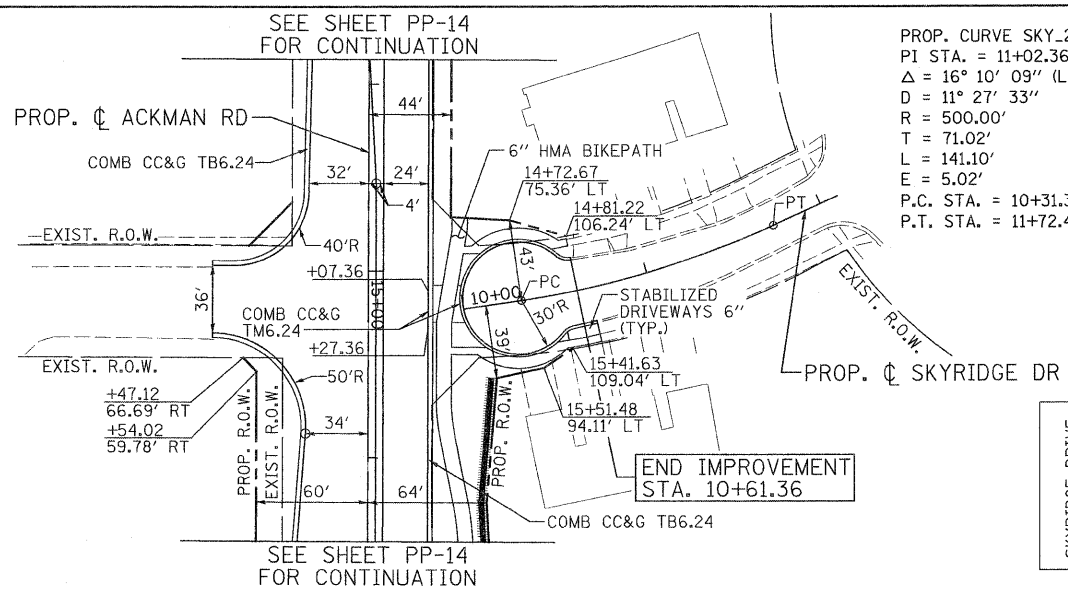
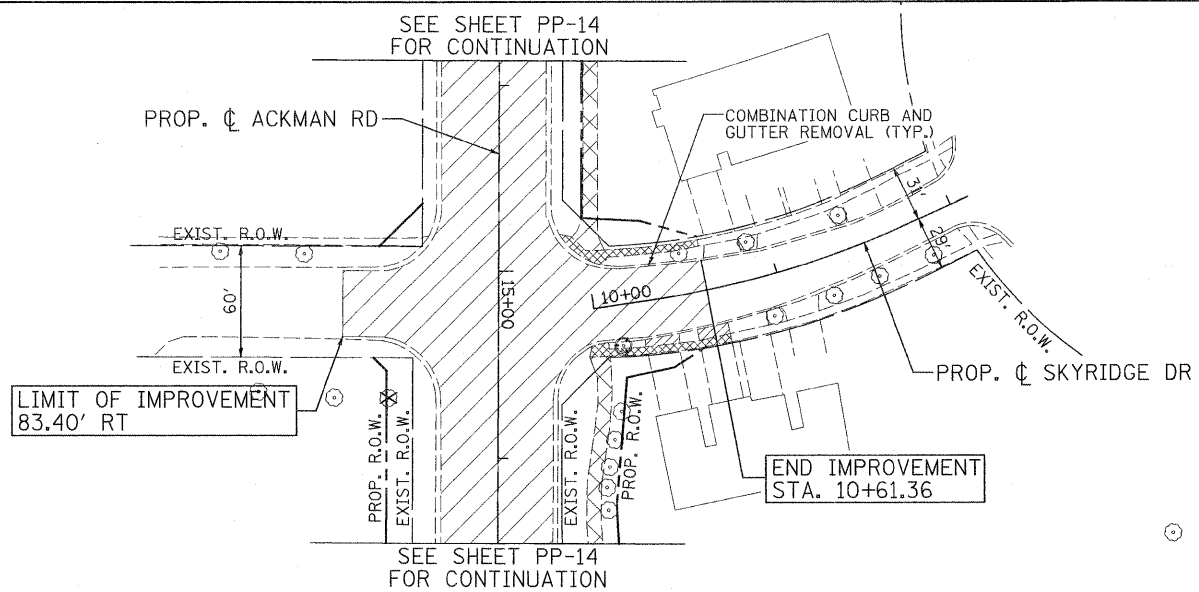
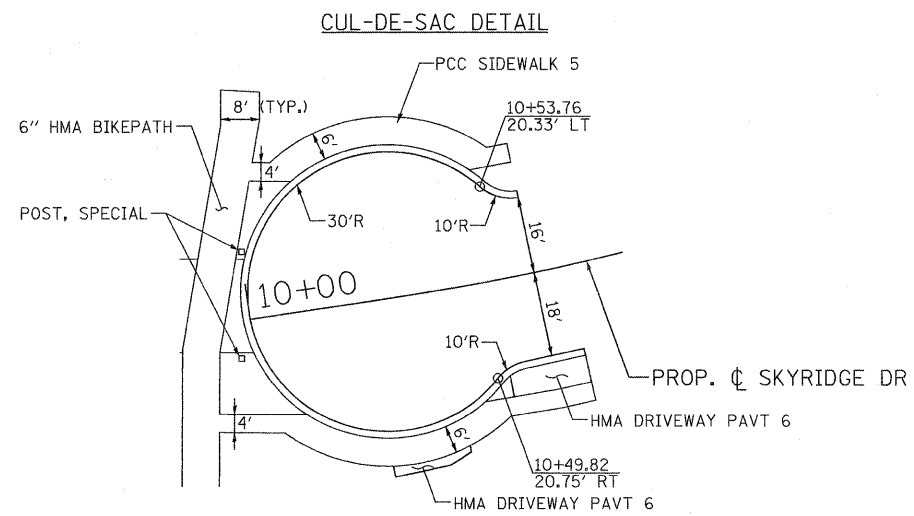

PROP. CURVE SKY_2
 PI STA. = 11+02.36
 $\Delta = 16^\circ 10' 09''$ (LT)
 $D = 11^\circ 27' 33''$
 $R = 500.00'$
 $T = 71.02'$
 $L = 141.10'$
 $E = 5.02'$
 P.C. STA. = 10+31.33
 P.T. STA. = 11+72.44

SKYRIDGE DRIVE COORDINATE TABLE				
	DESCRIPTION	ALIGNMENT POINT	N	E
SKYRIDGE DRIVE	BEGIN IMPROVEMENT	POT 10+00.00	2017161.974	982909.726
	CURVE SKY_2	PC 10+31.33	2017192.964	982905.112
		END IMP. 10+61.61	2017222.760	982899.743
		PI 11+02.36	2017263.214	982894.654
		PT 11+72.44	2017327.772	982865.047

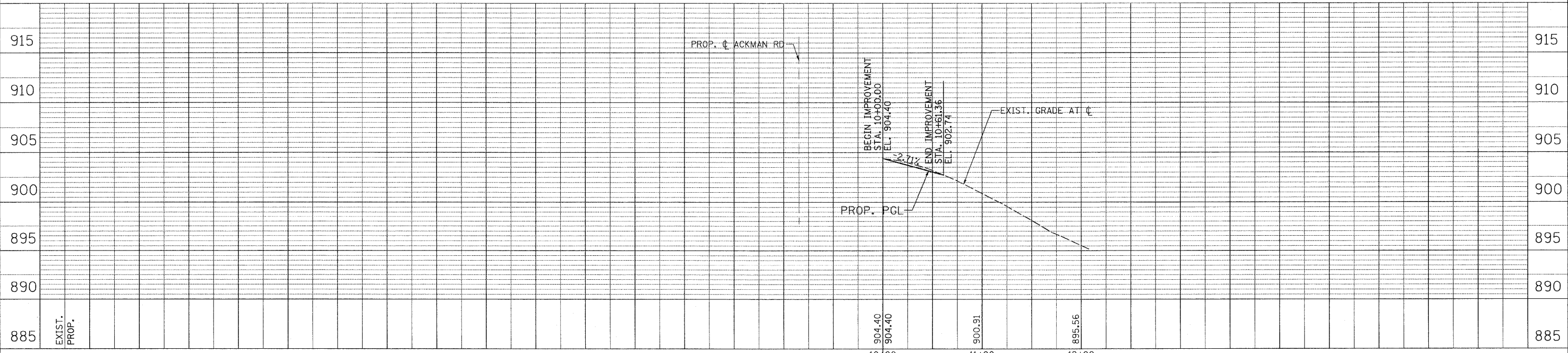

PATRICK ENGINEERING INC. LISLE, ILLINOIS	USER NAME = mpune(Rdwy_Lisle)	DESIGNED - MJP	REVISED -		MCHENRY COUNTY DIVISION OF TRANSPORTATION	RAKOW ROAD FROM ACKMAN ROAD TO ILLINOIS ROUTE 31 SKYRIDGE DRIVE PROPOSED ROADWAY PLAN AND PROFILE	F.A. RTE. 0336	SECTION 05-00308-00-WR	COUNTY MCHENRY	TOTAL SHEETS 606	SHEET NO. 169
	PLOT CONFIG = PDF(Gray_Large).plt	DRAWN - TCK	REVISED -				SCALE: 1"=50'	SHEET NO. PP 23 OF 25	STA. 10+00 TO STA. 10+61.36	FED. ROAD DIST. NO. ILLINOIS	FED. AID PROJECT
	PLOT SCALE = 1/8"=1'	CHECKED - JAH	REVISED -								
	PLOT DATE = 8/23/2010 9:57:58 AM	DATE - 8/2/2010	REVISED -								

G:\MCDOT\201508_021\Drawings\RDWY\shita\Rd\N_S_PP_23_(SkyridgeDr).dgn