

LEGEND

SECTION CORNER 16 15 QUARTER SECTION CORNER

SECTION LINE
QUARTER SECTION LINE
QUARTER, QUARTER SECTION LINE
PLATTED LOT LINE
PROPERTY (DEED) LINE

APL APPARENT PROPERTY LINE
CENTER LINE
EXISTING RIGHT OF WAY LINE
PROPOSED RIGHT OF WAY LINE
PROPOSED EASEMENT

120.32'
129.32'(Comp.) MEASURED DIMENSION
COMPUTED DIMENSION
RECORD DATA

EXISTING BUILDING

Bearings and Coordinates are referenced to the Illinois Coordinate System NAD 83(2007) East Zone.

○ IRON PIPE OR ROD FOUND ⊕ "MAG" NAIL SET
+ CUT CROSS FOUND OR SET ● 5/8" REBAR SET

● T1 THESE STAKES REFERENCE FOUND OR SET MONUMENTATION. SET 5/8 INCH IRON ROD FLUSH WITH GROUND TO THE FOUND IRON STAKE. IDENTIFIED BY COLORED PLASTIC CAP BEARING SURVEYORS REGISTRATION NUMBER.
● T2
● T3

● BT1 THESE STAKES, IN CULTIVATED AREAS, REFERENCE FOUND OR SET MONUMENTATION. BURIED 5/8 INCH IRON ROD 20 INCHES BELOW GROUND TO THE FOUND IRON STAKE. IDENTIFIED BY COLORED PLASTIC CAP BEARING SURVEYORS REGISTRATION NUMBER.
● BT2
● BT3

■ STAKING OF PROPOSED RIGHT OF WAY. SET DIVISION OF HIGHWAYS SURVEY MARKER TO MONUMENT THE POSITION SHOWN. IDENTIFIED BY INSCRIPTION DATA AND SURVEYORS REGISTRATION NUMBER.

■ M STAKING OF PROPOSED RIGHT OF WAY IN CULTIVATED AREAS. BURIED 5/8 INCH METAL ROD 20 INCHES BELOW GROUND TO MARK FUTURE SURVEY MARKER POSITION IDENTIFIED BY COLORED PLASTIC CAP BEARING SURVEYORS REGISTRATION NUMBER.

⊙ PERMANENT SURVEY MARKER, I.D.O.T STD 2135 (TO BE SET BY OTHERS)

□ RIGHT OF WAY STAKING PROPOSED TO BE SET.

STATE OF ILLINOIS }
COUNTY OF LAKE }SS

0 200' 400'
SCALE: 1"=200'

THIS IS TO CERTIFY THAT WE, JORGENSEN & ASSOCIATES, INC., AN ILLINOIS PROFESSIONAL DESIGN FIRM LAND SURVEYING CORPORATION, NUMBER 184-2771, HAVE SURVEYED THE PLAT OF HIGHWAYS SHOWN HEREON BETWEEN SECTION 16, TOWNSHIP 43N., RANGE 8E. AND SECTION 17, TOWNSHIP 43N., RANGE 8E., OF THE THIRD PRINCIPAL MERIDIAN, McHENRY COUNTY, THAT THE SURVEY IS TRUE AND COMPLETE AS SHOWN TO THE BEST OF MY KNOWLEDGE AND BELIEF, THAT THE PLAT CORRECTLY REPRESENTS SAID SURVEY, THAT ALL MONUMENTS FOUND AND ESTABLISHED ARE OF PERMANENT QUALITY AND OCCUPY THE POSITIONS SHOWN THEREON AND THAT THE MONUMENTS ARE SUFFICIENT TO ENABLE THE SURVEY TO BE RETRACED. MADE FOR THE DEPARTMENT OF TRANSPORTATION, STATE OF ILLINOIS.

DATED AT LAKE VILLA, ILLINOIS THIS ____ DAY OF ____ 20__ A.D.

ILLINOIS PROFESSIONAL LAND SURVEYOR NO. 35-2797
LICENSE EXPIRATION DATE: NOVEMBER 30, 2010
THIS PROFESSIONAL SERVICE CONFORMS TO THE CURRENT ILLINOIS MINIMUM STANDARDS FOR A BOUNDARY SURVEY.
Note: Surface Coordinates are Shown.

JORGENSEN & ASSOCIATES, INC.
120 PARK AVENUE
LAKE VILLA, ILLINOIS 60046
(847) 356-3371

SHEET 1 IS A COVER SHEET AND IS NOT RECORDED.

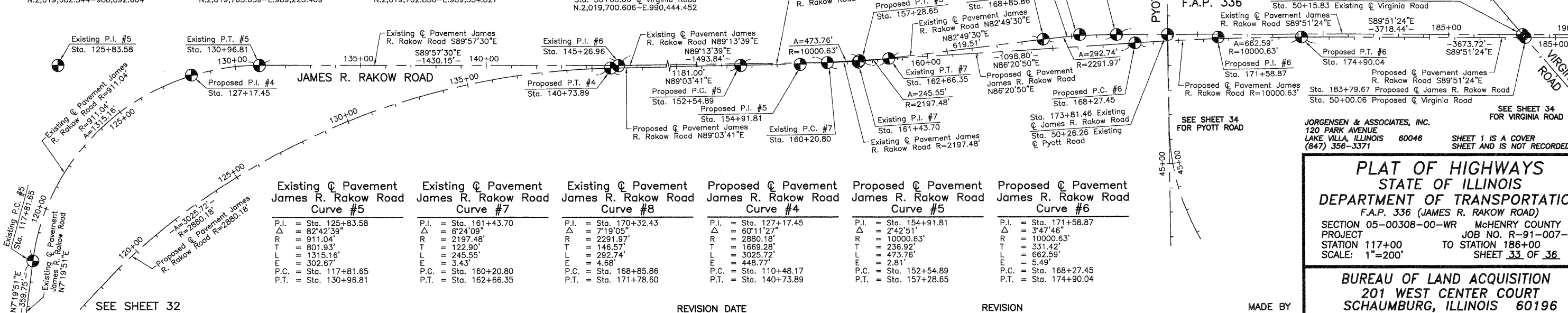

Curve #	P.I.	Sta.	Δ	R	T	L	E	P.C.	P.T.
Existing Pavement James R. Rakow Road Curve #5		125+83.58	82°42'39"	911.04'	801.93'	1315.16'	302.67'	117+81.65	130+96.81
Existing Pavement James R. Rakow Road Curve #7		161+43.70	6°24'09"	2197.48'	122.90'	245.55'	3.43'	160+20.80	162+66.35
Existing Pavement James R. Rakow Road Curve #8		170+32.43	7°19'05"	2291.97'	146.57'	292.74'	4.68'	168+85.86	171+78.60
Proposed Pavement James R. Rakow Road Curve #4		127+17.45	60°11'27"	2880.18'	1669.28'	3025.72'	448.77'	110+48.17	140+73.89
Proposed Pavement James R. Rakow Road Curve #5		154+91.81	2°42'51"	10000.63'	236.92'	473.76'	2.81'	152+54.89	157+28.65
Proposed Pavement James R. Rakow Road Curve #6		171+58.87	3°47'46"	10000.63'	331.42'	662.59'	5.49'	168+27.45	174+90.04