

| | | | |
|--|-------------------------|--|-------------------------|
| | SEEDING, CLASS 1 (MOD) | | SEEDING, CLASS 2A (MOD) |
| | SEEDING CLASS 4 | | SEEDING CLASS 4A |
| | SEEDING, CLASS 4A (MOD) | | SODDING, SALT TOLERANT |

- NOTES:**
- SEEDING CLASS 4A SHALL BE USED AT DITCH/SWALE BOTTOMS FROM STA. 86+42.45 TO STA. 141+00.
 - SEEDING CLASS 4A (MOD) SHALL BE USED AT DITCH/SWALE BOTTOMS FROM STA. 141+00 TO STA. 248+17.62.
 - SEEDING CLASS 4 SHALL BE USED AT THE FIRST 10 FEET OF DITCH BOTTOM UPSTREAM OF DITCH CHECK RESTRICTORS.
 - A 10 FOOT MOW-STRIP OF SEEDING CLASS 2A (MOD) SHALL BE PLACED BEHIND CURB/SHOULDER ADJACENT TO AREAS OF SEEDING CLASS 4A AND SEEDING CLASS 4A (MOD).
 - HEAVY DUTY EROSION CONTROL BLANKET SHALL BE PLACED ON ALL SEEDED AREAS.
 - ALL PAVEMENT MARKINGS SHALL BE WET REFLECTIVE PREFORMED PLASTIC UNLESS OTHERWISE NOTED.

| FERTILIZER NUTRIENTS | APPLICATION RATE (SEEDED AREAS) | APPLICATION RATE (SODDED AREAS) |
|----------------------|---------------------------------|---------------------------------|
| NITROGEN | 90 LB/ACRE | 60 LB/ACRE |
| PHOSPHORUS | 90 LB/ACRE | 60 LB/ACRE |
| POTASSIUM | 90 LB/ACRE | 60 LB/ACRE |

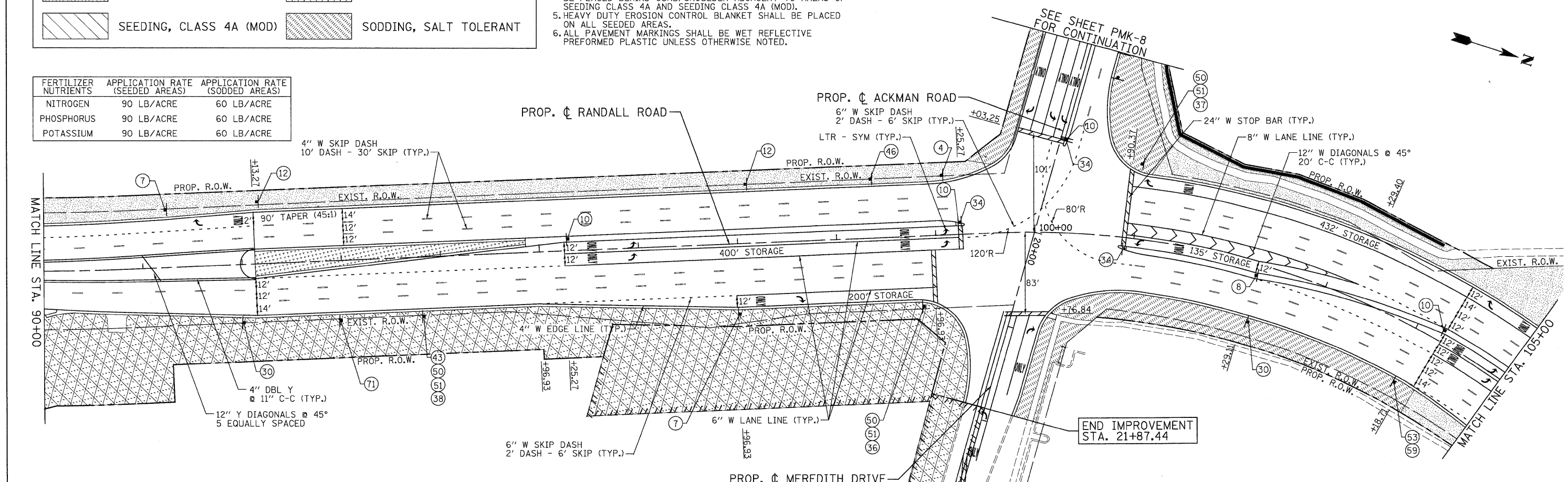

USER NAME = Rdky_Lisle
 PLOT CONFIG = PDF(Greg_Large).plt
 PLOT SCALE = 1:50
 PLOT DATE = 7/29/2010

DESIGNED - MJP
 DRAWN - TCK
 CHECKED - JAH
 DATE - 8/2/2010



**MCHENRY COUNTY
 DIVISION OF TRANSPORTATION**

**RAKOW ROAD FROM ACKMAN ROAD TO ILLINOIS ROUTE 31
 PROPOSED PAVEMENT MARKING/LANDSCAPING PLAN**

SCALE: 1"=50' SHEET NO. PMK 1 OF 21 STA. PROJ. START TO STA. 105+00

| | | | | |
|------------------------------|------------------------|------------------|------------------|---------------|
| F.A.P. RTE. 0336 | SECTION 05-00308-00-WR | COUNTY MCHENRY | TOTAL SHEETS 606 | SHEET NO. 268 |
| FED. ROAD DIST. NO. ILLINOIS | | FED. AID PROJECT | | |

G:\MCDOT\20950_001\Drawings\RDW\ahb\5-Strip\5-Strip.dgn