

	SEEDING, CLASS 1 (MOD)		SEEDING, CLASS 2A (MOD)
	SEEDING CLASS 4		SEEDING CLASS 4A
	SEEDING, CLASS 4A (MOD)		SODDING, SALT TOLERANT

- NOTES:**
- SEEDING CLASS 4A SHALL BE USED AT DITCH/SWALE BOTTOMS FROM STA. 86+42.45 TO STA. 141+00.
 - SEEDING CLASS 4A (MOD) SHALL BE USED AT DITCH/SWALE BOTTOMS FROM STA. 141+00 TO STA. 248+17.62.
 - SEEDING CLASS 4 SHALL BE USED AT THE FIRST 10 FEET OF DITCH BOTTOM UPSTREAM OF DITCH CHECK RESTRICTORS.
 - A 10 FOOT MOW-STRIP OF SEEDING CLASS 2A (MOD) SHALL BE PLACED BEHIND CURB/SHOULDER ADJACENT TO AREAS OF SEEDING CLASS 4A AND SEEDING CLASS 4A (MOD).
 - HEAVY DUTY EROSION CONTROL BLANKET SHALL BE PLACED ON ALL SEEDED AREAS.
 - ALL PAVEMENT MARKINGS SHALL BE WET REFLECTIVE PREFORMED PLASTIC UNLESS OTHERWISE NOTED.
 - REFER TO PMK SHEETS 2, 5, AND 9 FOR PAVEMENT MARKING INFORMATION.
 - SEEDING TYPE FOR 2' BIKEPATH SHOULDER IS SEEDING CLASS 2A (MOD). SEEDING TYPE FOR ALL OTHER BIKE PATH AREAS IS SEEDING CLASS 4A (MOD).

FERTILIZER NUTRIENTS	APPLICATION RATE (SEEDED AREAS)	APPLICATION RATE (SODDED AREAS)
NITROGEN	90 LB/ACRE	60 LB/ACRE
PHOSPHORUS	90 LB/ACRE	60 LB/ACRE
POTASSIUM	90 LB/ACRE	60 LB/ACRE

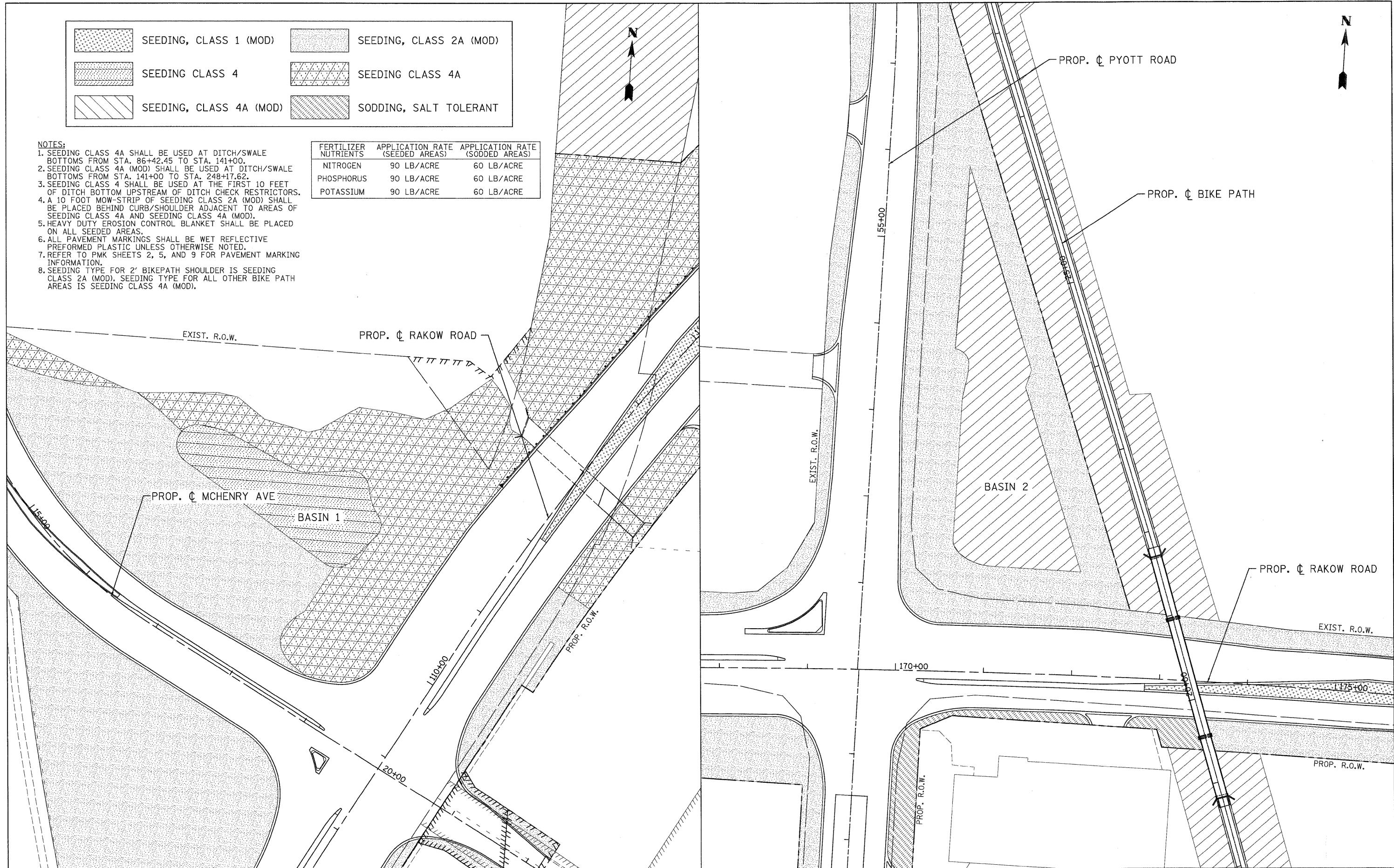

USER NAME = Rdwy_Lisle
 PLOT CONFIG = PDF(Grey, Large).plt
 PLOT SCALE = 1:50
 PLOT DATE = 7/29/2010

DESIGNED - MJP
 DRAWN - TCK
 CHECKED - JAH
 DATE - 8/2/2010

REVISED -
 REVISED -
 REVISED -
 REVISED -



**MCHENRY COUNTY
 DIVISION OF TRANSPORTATION**

**RAKOW ROAD FROM ACKMAN ROAD TO ILLINOIS ROUTE 31
 RAKOW ROAD PROPOSED PAVEMENT MARKING/LANDSCAPING PLAN**

SCALE: 1"=50' SHEET NO. PMK 14 OF 21 STA. TO STA.

F.A.P. RTE. 0336	SECTION 05-00308-00-WR	COUNTY MCHENRY	TOTAL SHEETS 606	SHEET NO. 281
FED. ROAD DIST. NO. ILLINOIS FED. AID PROJECT		CONTRACT NO. 63398		

G:\MCD01\28958_02\Drawings\RDWY\shits\Strp\S.Strp.14.Ponds.dgn