

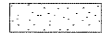



**LEGEND:**

-  TEMPORARY EROSION CONTROL SEEDING W/HEAVY DUTY EROSION CONTROL BLANKET
-  PERIMETER EROSION BARRIER
-  INLET FILTERS
-  TEMPORARY DITCH CHECK
-  INLET AND PIPE PROTECTION

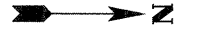

SEE ERO-6 FOR CONTINUATION

PROP. C RAKOW ROAD

EXIST. C RAKOW ROAD

C ILLINOIS ROUTE 31

END IMPROVEMENT  
STA. 57+51.37

BEGIN IMPROVEMENT  
STA. 48+69.04

END PROJECT  
STA. 248+17.62

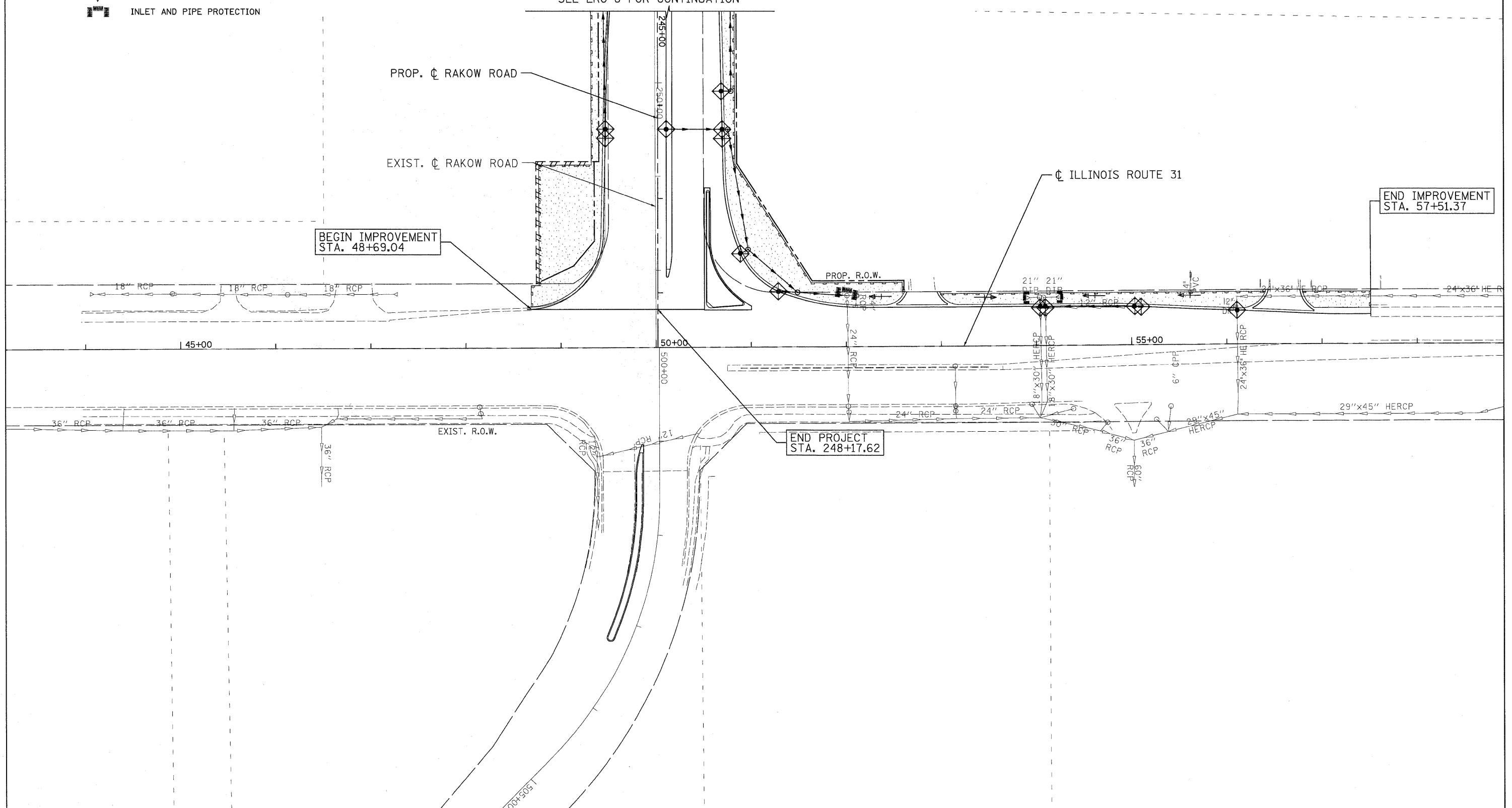

USER NAME = jmoocke(Chicago_R)	DESIGNED - D. DOERFLER	REVISED -
PLOT CONFIG = PDF(Grey_Large).plt	DRAWN - D. DOERFLER	REVISED -
PLOT SCALE = 1:50	CHECKED - E. CHOW	REVISED -
PLOT DATE = 7/29/2010	DATE - 8/2/2010	REVISED -



**MCHENRY COUNTY  
DIVISION OF TRANSPORTATION**

**RAKOW ROAD FROM ACKMAN ROAD TO ILLINOIS ROUTE 31  
IL RTE 31 EROSION AND SEDIMENT CONTROL**

SCALE: 1"=50' SHEET NO. ERO 13 OF 19 STA. 48+69.04 TO STA. 57+51.37

F.A.P. RTE. 0336	SECTION 05-00308-00-WR	COUNTY MCHENRY	TOTAL SHEETS 606	SHEET NO. 301
FED. ROAD DIST. NO. ILLINOIS FED. AID PROJECT		CONTRACT NO. 63398		

pr:\chicago\mcdot\20950\_001\drawings\rdwy\shfts\eros\13\_S\_Eros\_(ILRte31).dgn