

McHENRY AVENUE
TEMPORARY CABLE PLAN

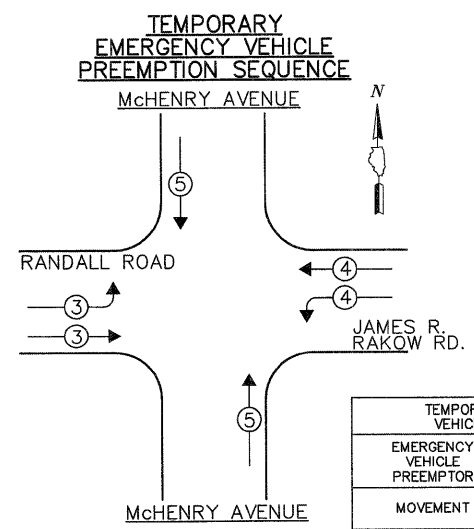

TEMPORARY
EMERGENCY VEHICLE
PREEMPTION SEQUENCE
McHENRY AVENUE

TEMPORARY EMERGENCY VEHICLE PREEMPTORS			
EMERGENCY VEHICLE PREEMPTOR	3	4	5
MOVEMENT			

OVERLAP LETTER	PERMISSIVE PHASE	PROTECTED PHASE
B	= 4	+ 5
C	= 6	+ 7
D	= 8	+ 1

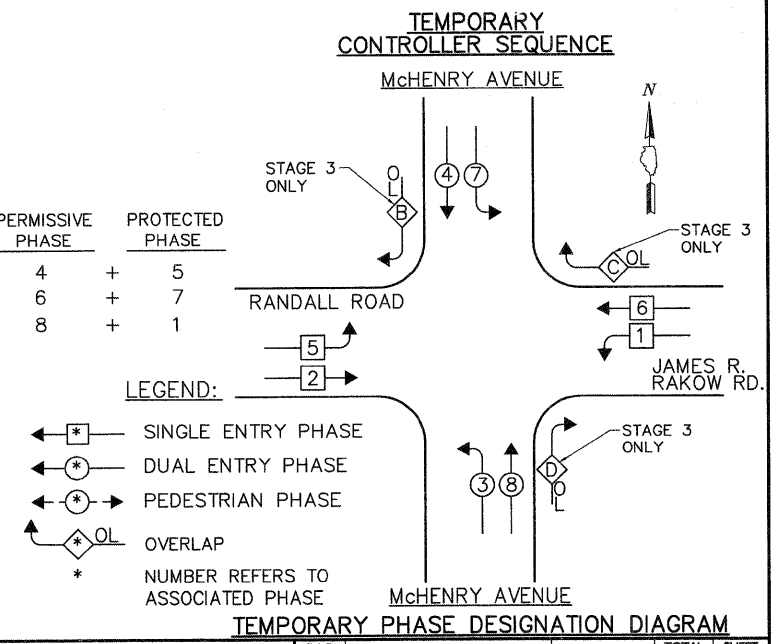

TEMPORARY
CONTROLLER SEQUENCE
McHENRY AVENUE

TEMPORARY PHASE DESIGNATION DIAGRAM

THE TRAFFIC SIGNAL CONTROL EQUIPMENT FOR THIS PROJECT SHALL BE "ECONOLITE" TO MATCH THE EXISTING ADJACENT SYSTEM.

GHA GEWALT HAMILTON ASSOCIATES, INC.
850 Forest Edge Drive • Vernon Hills, IL 60061
Consulting Engineers & Surveyors
847-479-9700
FAX: 847-479-9701

PATRICK ENGINEERING INC.
LISLE, ILLINOIS

McHENRY COUNTY DIVISION OF TRANSPORTATION TRAFFIC SIGNAL INSTALLATION ELECTRICAL SERVICE REQUIREMENTS					TOTAL WATTAGE
TYPE	NO LAMPS	WATTAGE		% OPERATION	
		INCAND.	L.E.D.		
SIGNAL (RED)	20	135	17	0.50	170.0
SIGNAL (YELLOW)	20	135	25	0.25	125.0
SIGNAL (GREEN)	20	135	15	0.25	75.0
ARROW	20	135	12	0.10	24.0
PED.SIGNAL		90	25	1.00	
CONTROLLER	1	100	100	1.00	100.0
BATTERY BACKUP	1		25	1.00	25.0
VIDEO SYSTEMS	1		150	1.00	150.0
LUMINAIRE	4	400		0.50	800.0
FLASHER				0.05	
TOTAL =					1,469.0

ENERGY COSTS - BILLED TO: CITY OF CRYSTAL LAKE
(ADDRESS) 100 WEST MUNICIPAL COMPLEX

ENERGY SUPPLY - CONTACT: MS. AUDREY HELGESEN
PHONE: (847) 816-5225
COMPANY: COMED-LIBERTYVILLE

FILE NAME = 4153.800-tr1.dwg	USER NAME = GHA	DESIGNED - DPB	REVISED -
		DRAWN - ZCW	REVISED -
	PLOT SCALE = N.T.S.	CHECKED - DPB	REVISED -
	PLOT DATE = 8/2/10	DATE - 8/2/10	REVISED -

MCHENRY COUNTY DIVISION OF TRANSPORTATION

**TEMPORARY CABLE PLAN AND TEMPORARY PHASE DESIGNATION DIAGRAM
JAMES R. RAKOW RD. AND MCHENRY AVE.**

SCALE: N.A. | SIGNAL SHEET # 12 OF 65 SHEETS | STA. TO STA.

F.A.P. RTE. 0336	SECTION 05-00308-WR	COUNTY McHENRY	TOTAL SHEETS 606	SHEET NO. 321
CONTRACT #:			63398	
ILLINOIS FED. AID PROJECT				