

INTERCONNECT SCHEMATIC LEGEND

EXISTING INTERSECTION CONTROLLER		EXISTING FIBER OPTIC CABLE IN CONDUIT, NO. 62.5/125, MM12F SM12F	
PROPOSED INTERSECTION CONTROLLER		PROPOSED FIBER OPTIC CABLE IN CONDUIT, NO. 62.5/125, MM12F SM12F	
EXISTING MASTER CONTROLLER		EXISTING INTERCONNECT CABLE - NO. 62.5/125 12F FIBER OPTIC CABLE	
PROPOSED MASTER CONTROLLER		PROPOSED INTERCONNECT CABLE - NO. 18 3 PAIR TWISTED, SHIELDED	
MASTER MASTER CONTROLLER		PROPOSED INTERCONNECT CABLE - NO. 18 3 PAIR TWISTED, SHIELDED	
EXISTING INTERSECTION & SAMPLING (SYSTEM) DETECTORS		EXISTING LOOP DETECTOR CABLE 2/C TWISTED, SHIELDED	
PROPOSED INTERSECTION & SAMPLING (SYSTEM) DETECTORS		PROPOSED LOOP DETECTOR CABLE 2/C TWISTED, SHIELDED	
EXISTING INTERSECTION LOOP DETECTORS		EXISTING ELECTRIC CABLE, 1/C (AS SPECIFIED)	
PROPOSED SAMPLING (SYSTEM) DETECTORS		PROPOSED ELECTRIC CABLE, 1/C (AS SPECIFIED)	
EXISTING SAMPLING (SYSTEM) DETECTORS		EXISTING INTERCONNECT CABLE - NO. 62.5/125, 36F FIBER OPTIC CABLE	
PROPOSED SAMPLING (SYSTEM) DETECTORS		PROPOSED FIBER OPTIC CABLE IN CONDUIT - NO. 62.5/125, MM12F SM24F	
EXISTING PREFORMED INTERSECTION & SAMPLING (SYSTEM) DETECTORS		PROPOSED INTERCONNECT CABLE - NO. 62.5/125, MM12F SM12F	
PROPOSED PREFORMED INTERSECTION & SAMPLING (SYSTEM) DETECTORS		EXISTING INTERCONNECT CABLE - NO. 62.5/125, MM12F SM12F	
EXISTING SAMPLING (SYSTEM) PREFORMED DETECTORS		EXISTING TELEPHONE CONNECTION	
PROPOSED SAMPLING (SYSTEM) PREFORMED DETECTORS		PROPOSED TELEPHONE CONNECTION	
		EXISTING ISDN TELEPHONE CONNECTION	
		PROPOSED ISDN TELEPHONE CONNECTION	

SCHEDULE OF QUANTITIES
TRAFFIC SIGNAL INTERCONNECT - JAMES R. RAKOW RD. FROM ACKMAN RD./MEREDITH DR. TO IL RTE 31

NO.	QUANT.	UNIT	DESCRIPTION
1.	3,697	FOOT	CONDUIT IN TRENCH, 2" DIA., GALVANIZED STEEL
2.	10,298	FOOT	CONDUIT IN TRENCH, 2" DIA., COILABLE NONMETALLIC CONDUIT
3.	395	FOOT	CONDUIT PUSHED, 2" DIA., GALVANIZED STEEL
4.	23	EACH	HANDHOLE
5.	14,070	FOOT	TRENCH AND BACKFILL FOR ELECTRICAL WORK
6.	1	EACH	MASTER CONTROLLER (SPECIAL)
7.	15,691	FOOT	ELECTRIC CABLE IN CONDUIT, TRACER, NO. 14 1C
8.	1	EACH	OPTIMIZE TRAFFIC SIGNAL SYSTEM
9.	1	EACH	RE-OPTIMIZE TRAFFIC SIGNAL SYSTEM LEVEL 2
10.	15,691	FOOT	FIBER OPTIC CABLE IN CONDUIT, NO. 62.5/125, MM12F SM12F

SCHEDULE OF QUANTITIES
MISCELLANEOUS COMMUNICATION CONDUIT

NO.	QUANT.	UNIT	DESCRIPTION
1.	14,126	FOOT	CONDUIT IN TRENCH, 2" DIA., COILABLE NONMETALLIC CONDUIT
2.	877	FOOT	CONDUIT PUSHED, 2" DIA., GALVANIZED STEEL
3.	33	EACH	GULFBOX JUNCTION, COMPOSITE CONCRETE
4.	14,126	FOOT	TRENCH AND BACKFILL FOR ELECTRICAL WORK
5.	15,003	FOOT	ELECTRIC CABLE IN CONDUIT, TRACER, NO. 14 1C

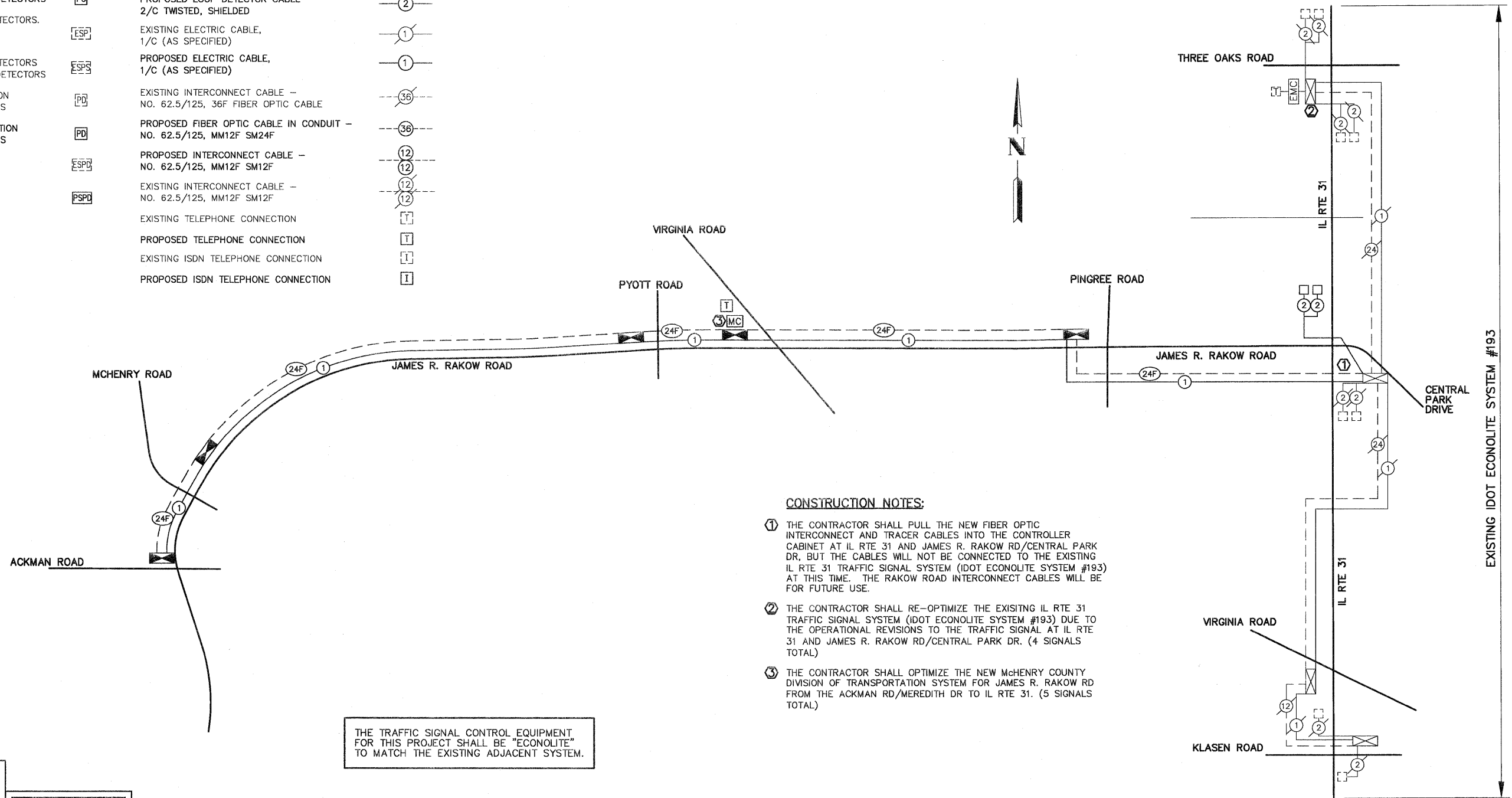

- CONSTRUCTION NOTES:**
- 1 THE CONTRACTOR SHALL PULL THE NEW FIBER OPTIC INTERCONNECT AND TRACER CABLES INTO THE CONTROLLER CABINET AT IL RTE 31 AND JAMES R. RAKOW RD/CENTRAL PARK DR, BUT THE CABLES WILL NOT BE CONNECTED TO THE EXISTING IL RTE 31 TRAFFIC SIGNAL SYSTEM (IDOT ECONOLITE SYSTEM #193) AT THIS TIME. THE RAKOW ROAD INTERCONNECT CABLES WILL BE FOR FUTURE USE.
 - 2 THE CONTRACTOR SHALL RE-OPTIMIZE THE EXISTING IL RTE 31 TRAFFIC SIGNAL SYSTEM (IDOT ECONOLITE SYSTEM #193) DUE TO THE OPERATIONAL REVISIONS TO THE TRAFFIC SIGNAL AT IL RTE 31 AND JAMES R. RAKOW RD/CENTRAL PARK DR. (4 SIGNALS TOTAL)
 - 3 THE CONTRACTOR SHALL OPTIMIZE THE NEW McHENRY COUNTY DIVISION OF TRANSPORTATION SYSTEM FOR JAMES R. RAKOW RD FROM THE ACKMAN RD/MEREDITH DR TO IL RTE 31. (5 SIGNALS TOTAL)

THE TRAFFIC SIGNAL CONTROL EQUIPMENT FOR THIS PROJECT SHALL BE "ECONOLITE" TO MATCH THE EXISTING ADJACENT SYSTEM.

GHA GENWALT HAMILTON ASSOCIATES, INC.
850 Forest Edge Drive • Vernon Hills, IL 60061
Consulting Engineers & Surveyors
847.478.9700
FAX: 847.478.9701

PATRICK ENGINEERING INC.
LISLE, ILLINOIS

FILE NAME = 4153.800-tr1.dwg	USER NAME = GHA	DESIGNED - DPB	REVISED -	<p>MCHENRY COUNTY DIVISION OF TRANSPORTATION</p>	INTERCONNECT SCHEMATIC		F.A.P. RTE 0336	SECTION 05-00308-WR	COUNTY McHENRY	TOTAL SHEETS 606	SHEET NO. 365	
	PLOT SCALE = N.T.S.	DRAWN - ZCW	REVISED -		JAMES R. RAKOW RD. - ACKMAN RD./MEREDITH DR. TO IL RTE 31		SCALE N.A.	SGNL SHEET # 56 OF 65 SHEETS	STA. TO STA.	CONTRACT # 63398	ILLINOIS FED. AID PROJECT	
	PLOT DATE = 8/2/10	DATE - 8/2/10	REVISED -									