

DEVELOPED ELEVATION

(Looking West)
(Stations along Rakow Road.)

CURVE DATA RAK 3

$\Delta = 46^\circ 45' 07''$ (RT)
 $D = 7^\circ 00' 00''$
 $T = 353.79'$
 $L = 667.88'$
 $E = 73.19'$
 $R = 818.51'$
 $S.E. = 4.0\%$
 $P.C. = \text{Sta. } 99+58.00$
 $P.T. = \text{Sta. } 106+25.88$
 $P.I. = \text{Sta. } 103+11.79$

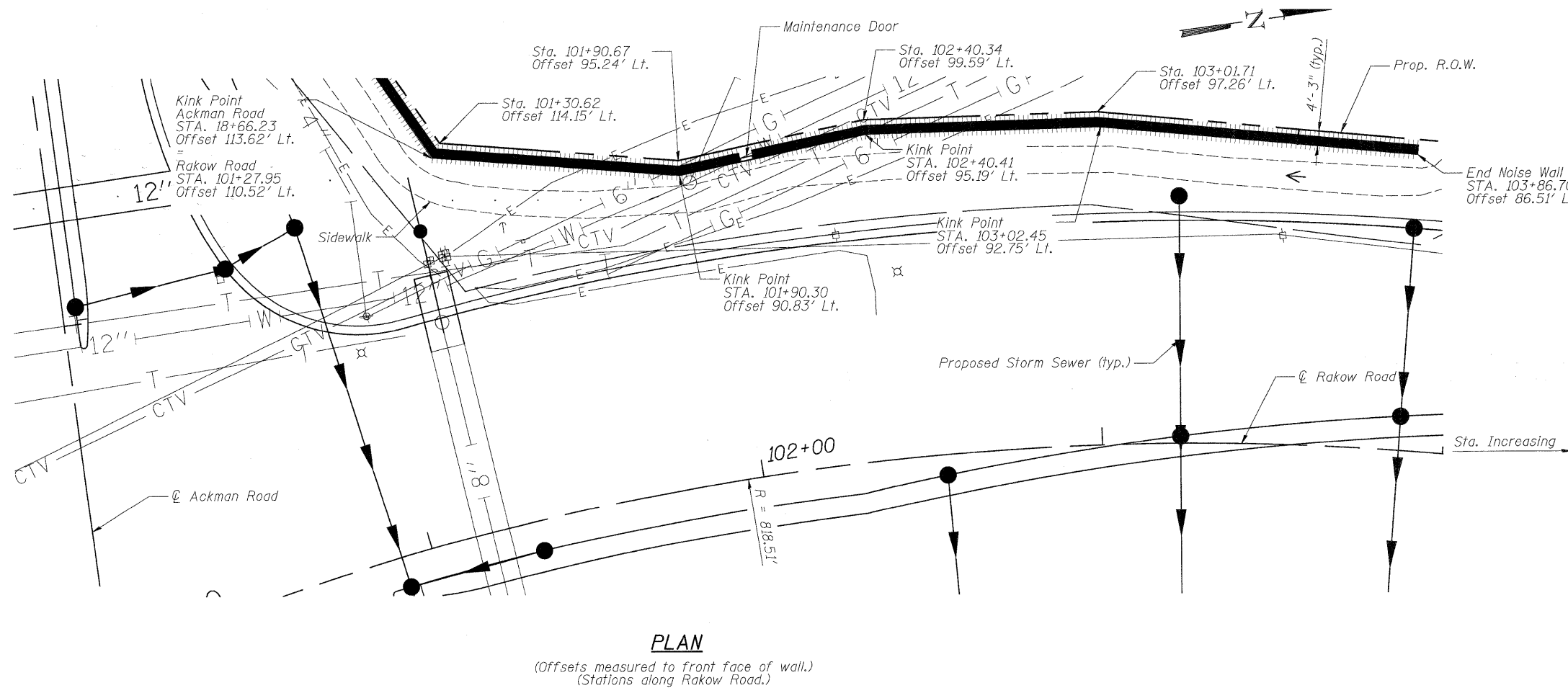

PLAN

(Offsets measured to front face of wall.)
(Stations along Rakow Road.)

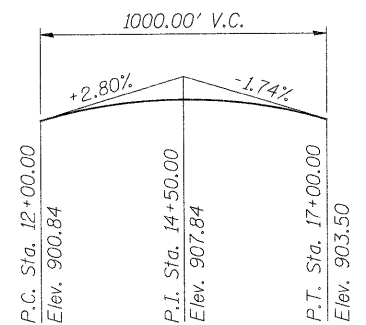

PROFILE GRADE
(along P.G. Rakow Road)

Note:
See Sheet STR 18 of 22 for typical section and Noise Abatement Wall Notes.

LEGEND

- |W|— Water Line
- |CTV|— Cable TV Line
- |T|— Telephone Line
- |G|— Gas Line
- |E|— Electric Line

GENERAL PLAN II

	USER NAME = Rduy_Lisle	DESIGNED - A. Durbak	REVISED -		RAKOW ROAD FROM ACKMAN ROAD TO ILLINOIS ROUTE 31 NOISEWALL			F.A. RTE. 0336	SECTION 05-00308-00-WR	COUNTY MCHENRY	TOTAL SHEETS 606	SHEET NO. 419
	PLOT CONFIG = PDFGrey_Large.plt	DRAWN - A. Durbak	REVISED -					SCALE: NONE	SHEET NO. STR 17 OF 22	STA. TO STA.	FED. ROAD DIST. NO. ILLINOIS	FED. AID PROJECT
PLOT SCALE = 1:20	CHECKED - A. Yarglooglu	REVISED -										
PLOT DATE = 7/28/2010	DATE - 8/2/2010	REVISED -										

Q:\MCDOT\20950_001\Drawings\STRUCT\Final\Plans\S17 NoiseWall GPE2.dgn