

150 140 130 120 110 100 90 80 70 60 50 40 30 20 10 0 10 20 30 40 50 60 70 80 90 100 110 120 130 140 150

DATE _____
 BY _____
 SURVEYED _____
 PLOTTED _____
 FINAL SURVEY NOTE BOOK NO. _____

DATE _____
 BY _____
 SURVEYED _____
 PLOTTED _____
 ORIGINAL SURVEY NOTE BOOK NO. _____

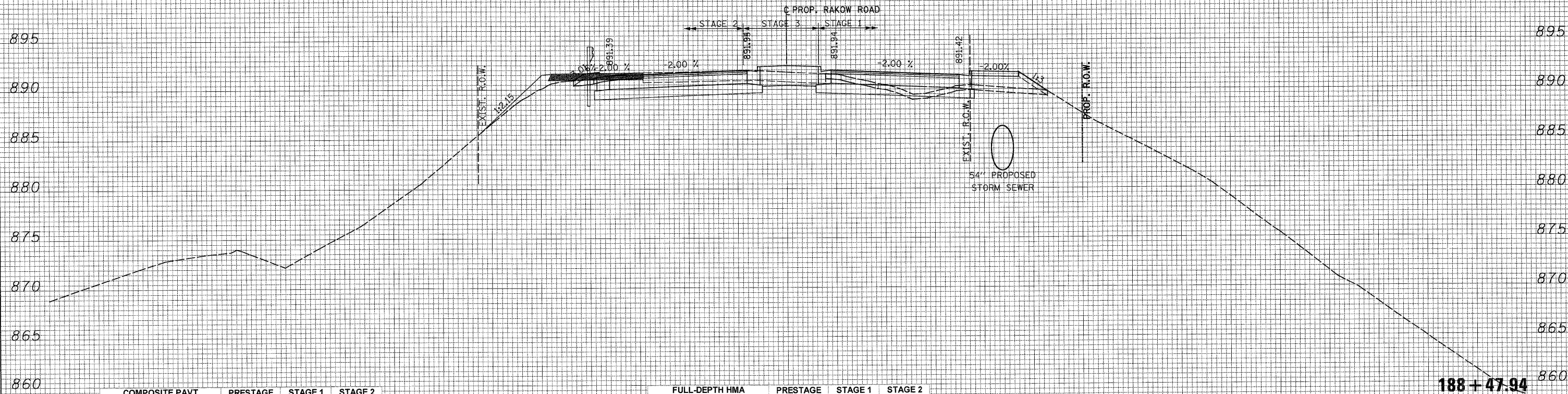

COMPOSITE PAVT	PRESTAGE	STAGE 1	STAGE 2
188+47.94 UNSUITABLE	7.14	22.94	7.14
EXCAVATION	0.00	10.68	43.14
EMBANKMENT	14.24	23.64	2.31

ALL UNITS ARE SQ FT

FULL-DEPTH HMA	PRESTAGE	STAGE 1	STAGE 2
188+47.94 UNSUITABLE	7.14	22.94	7.14
EXCAVATION	0.00	19.76	56.63
EMBANKMENT	14.24	20.53	2.46

ALL UNITS ARE SQ FT

188 + 47.94

150 140 130 120 110 100 90 80 70 60 50 40 30 20 10 0 10 20 30 40 50 60 70 80 90 100 110 120 130 140 150



USER NAME = Rduy.Lisle
 DESIGNED - CPK
 REVISIONS:
 PLOT CONFIG = PDF(Gray, Large).plt
 DRAWN - TCK
 REVISIONS -
 PLOT SCALE = 1:10
 CHECKED - JAH
 REVISIONS -
 PLOT DATE = 7/28/2010 8:58:46 PM
 DATE - 8/2/2010
 REVISIONS -



MCHENRY COUNTY
 DIVISION OF TRANSPORTATION

RAKOW ROAD
 CROSS SECTIONS

SCALE: 1H:2V SHEET NO. STA. 188+47.94 TO STA. 188+47.94

F.A. RTE.	SECTION	COUNTY	TOTAL SHEETS	SHEET NO.
0336	05-00308-00-WR	MCHENRY	606	487
			CONTRACT NO. 63398	

ILLINOIS FED. AID PROJECT

D:\MCDOT\2010\01\Drawings\RDWY\ah\Xeco\XS.XS_01_Rakow.dgn