

150 140 130 120 110 100 90 80 70 60 50 40 30 20 10 0 10 20 30 40 50 60 70 80 90 100 110 120 130 140 150

DATE \_\_\_\_\_  
 BY \_\_\_\_\_  
 SURVEYED \_\_\_\_\_  
 PLOTTED \_\_\_\_\_  
 NOTE BOOK \_\_\_\_\_  
 AREAS CHECKED \_\_\_\_\_  
 NO. \_\_\_\_\_

DATE \_\_\_\_\_  
 BY \_\_\_\_\_  
 SURVEYED \_\_\_\_\_  
 PLOTTED \_\_\_\_\_  
 NOTE BOOK \_\_\_\_\_  
 AREAS CHECKED \_\_\_\_\_  
 NO. \_\_\_\_\_

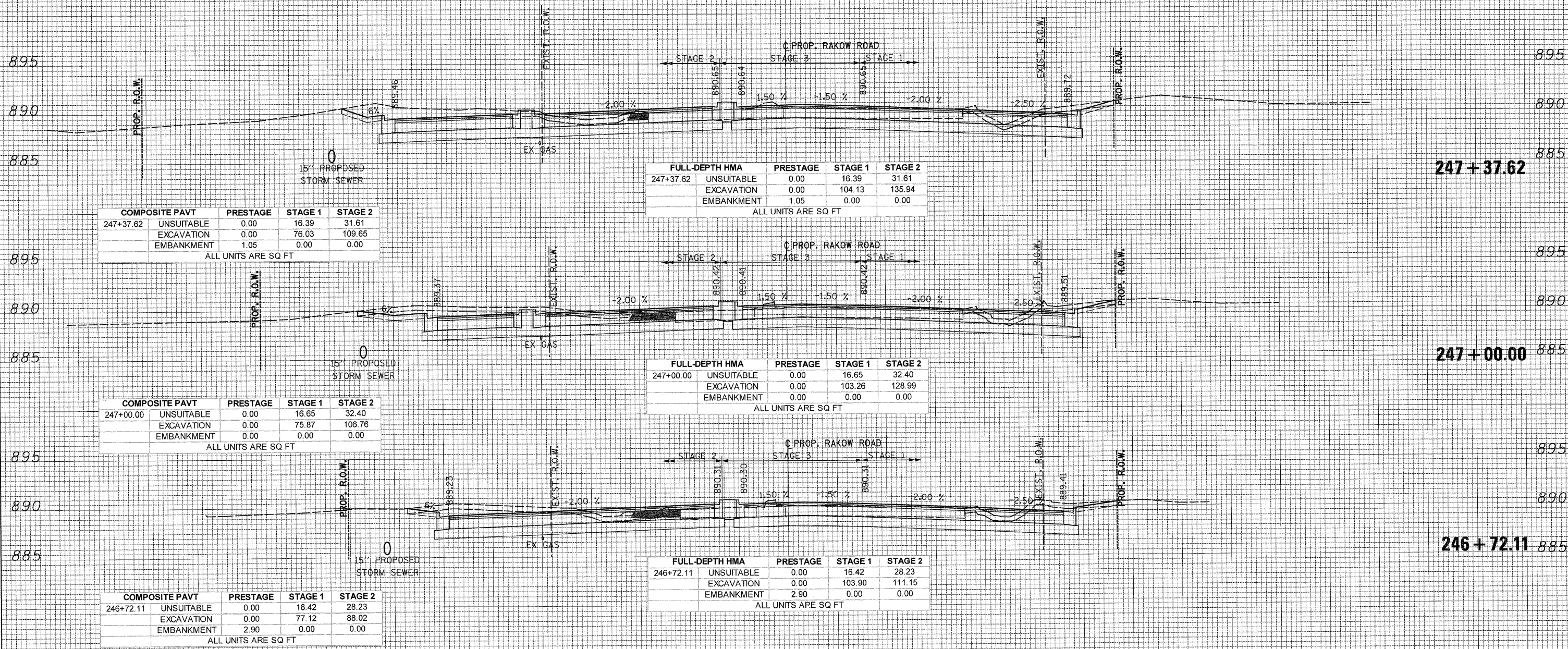

150 140 130 120 110 100 90 80 70 60 50 40 30 20 10 0 10 20 30 40 50 60 70 80 90 100 110 120 130 140 150



USER NAME = Rdwy.Lisle  
 PLOT CONFIG = PDF(Grey, Large).plt  
 PLOT SCALE = 1:10  
 PLOT DATE = 7/28/2010 9:01:29 PM

DESIGNED - CPK  
 DRAWN - TCK  
 CHECKED - JAH  
 DATE - 8/2/2010

REVISED -  
 REVISED -  
 REVISED -  
 REVISED -



MCHENRY COUNTY  
 DIVISION OF TRANSPORTATION

RAKOW ROAD  
 CROSS SECTIONS

SCALE: 1H:2V

SHEET NO.

STA. 246+72.11 TO STA. 247+37.62

F.A. RTE.	SECTION	COUNTY	TOTAL SHEETS	SHEET NO.
0336	05-00308-00-WR	MCHENRY	606	522
			CONTRACT NO. 63398	
ILLINOIS FED. AID PROJECT				