

DATE \_\_\_\_\_  
 BY \_\_\_\_\_  
 SURVEYED \_\_\_\_\_  
 PLOTTED \_\_\_\_\_  
 NOTE BOOK \_\_\_\_\_  
 AREAS CHECKED \_\_\_\_\_  
 NO. \_\_\_\_\_

DATE \_\_\_\_\_  
 BY \_\_\_\_\_  
 SURVEYED \_\_\_\_\_  
 PLOTTED \_\_\_\_\_  
 NOTE BOOK \_\_\_\_\_  
 AREAS CHECKED \_\_\_\_\_  
 NO. \_\_\_\_\_

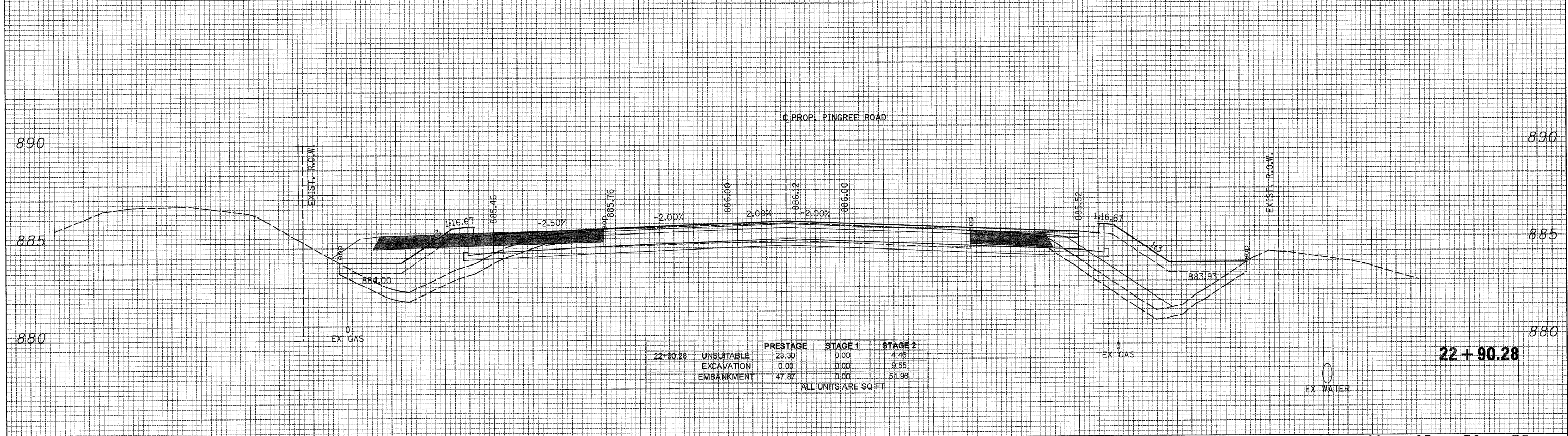

75 70 65 60 55 50 45 40 35 30 25 20 15 10 5 0 5 10 15 20 25 30 35 40 45 50 55 60 65 70 75

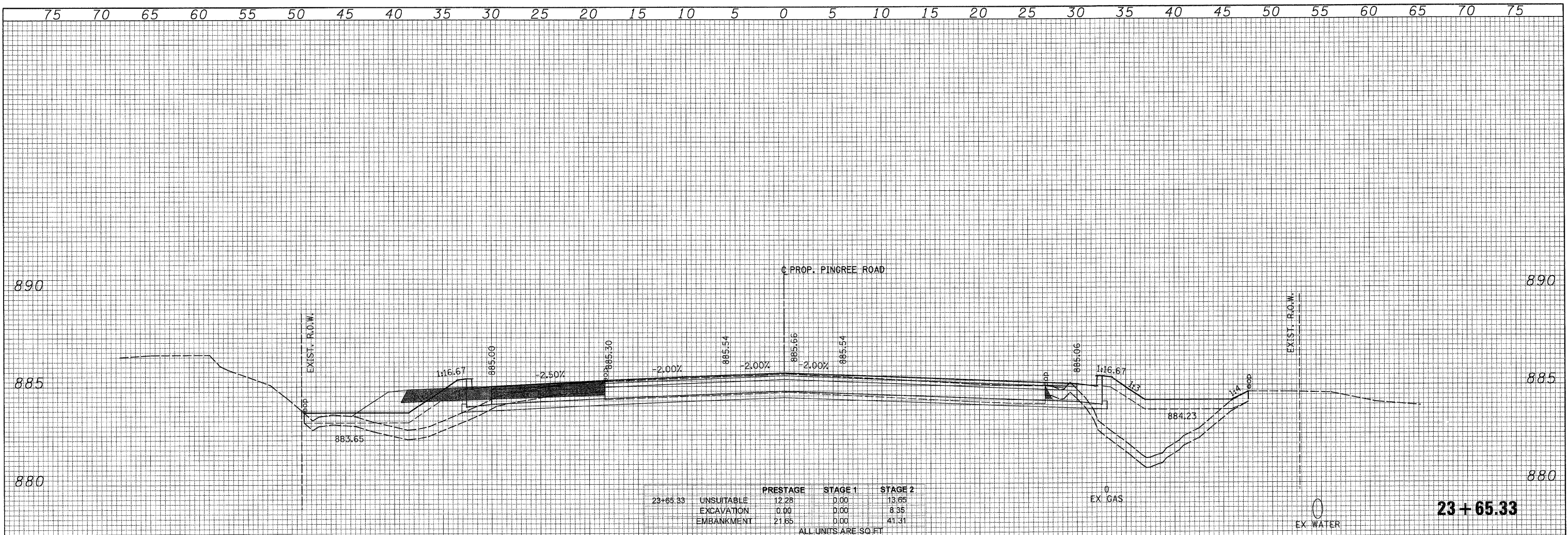

USER NAME = Rdy.Lislo  
 PLOT CONFIG = PDF(Gray, Large).plt  
 PLOT SCALE = 1/5  
 PLOT DATE = 7/28/2010 9:05:21 PM

DESIGNED - CPK  
 DRAWN - TCK  
 CHECKED - JAH  
 DATE - 8/2/2010

REVISED -  
 REVISED -  
 REVISED -  
 REVISED -



MCHENRY COUNTY  
 DIVISION OF TRANSPORTATION

SCALE: 1H:2V SHEET NO. STA. 22+90.28 TO STA. 23+65.33

PINGREE ROAD  
 CROSS SECTIONS

F.A. RTE. 0336	SECTION 05-00308-00-WR	COUNTY MCHENRY	TOTAL SHEETS 606	SHEET NO. 579
CONTRACT NO. 63398			ILLINOIS FED. AID PROJECT	

Q:\MCDOT\2010\Drawings\RDWY\shita\Xseo\XS\_06\_Pingree.dgn