

| | |
|---------------|--|
| DATE | |
| BY | |
| FINAL SURVEY | |
| SURVEYED | |
| PL | |
| NOTE BOOK | |
| AREAS CHECKED | |
| NO. | |

| | |
|-----------------|--|
| DATE | |
| BY | |
| ORIGINAL SURVEY | |
| SURVEYED | |
| PL | |
| NOTE BOOK | |
| AREAS CHECKED | |
| NO. | |

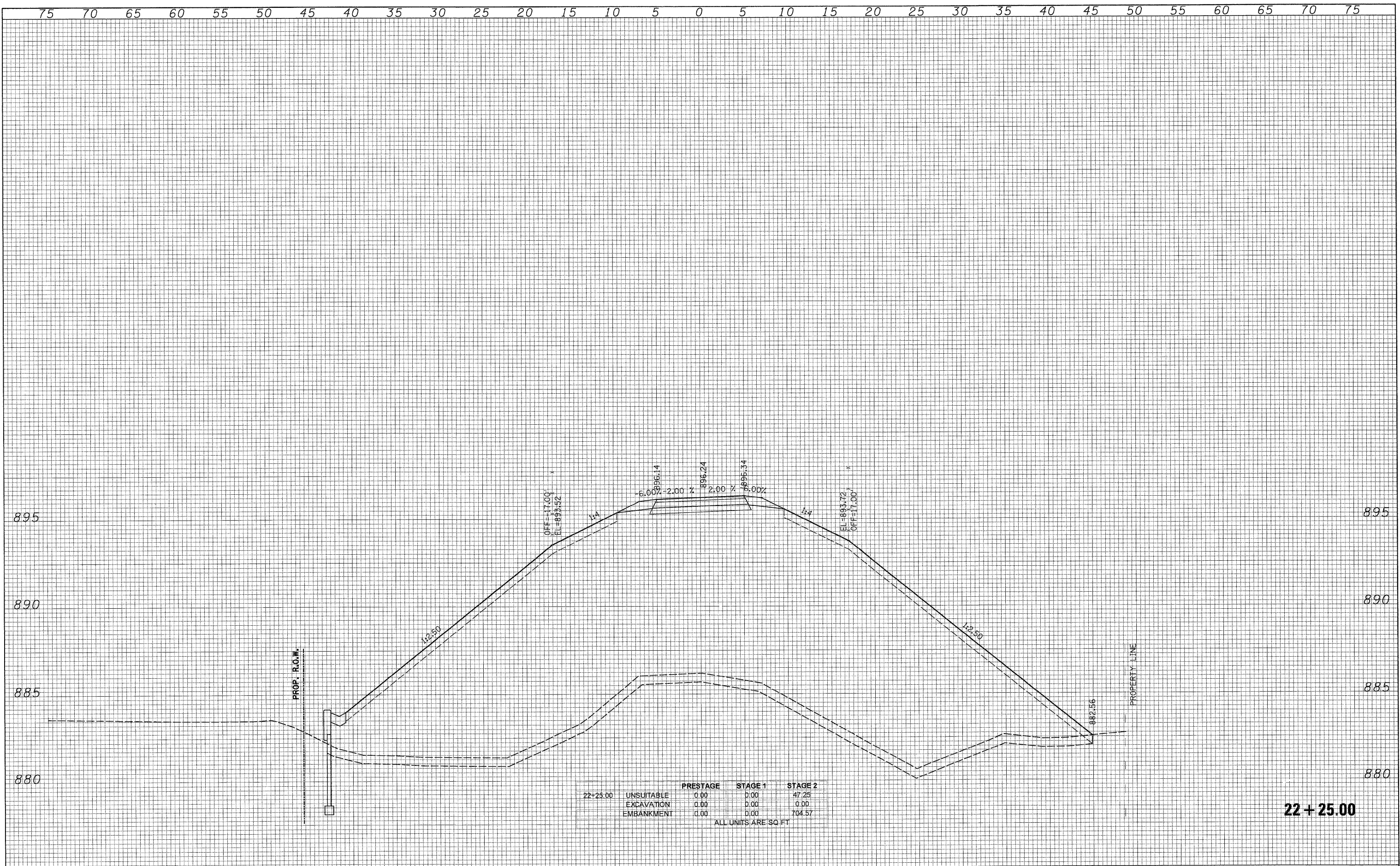

75 70 65 60 55 50 45 40 35 30 25 20 15 10 5 0 5 10 15 20 25 30 35 40 45 50 55 60 65 70 75



USER NAME = Rdwy.Lisle
 DESIGNED - CPK
 DRAWN - TCK
 CHECKED - JAH
 DATE - 8/2/2010
 PLOT CONFIG = PDF(Gregy.Large).plt
 PLOT SCALE = 1/8"
 PLOT DATE = 7/28/2010 9:06:42 PM

REVISIED -
 REVISIED -
 REVISIED -
 REVISIED -



MCHENRY COUNTY
 DIVISION OF TRANSPORTATION

BIKE PATH
 CROSS SECTIONS
 SCALE: 1/8"=1'-0"
 SHEET NO.
 STA. 22+25.00 TO STA. 22+25.00

| | | | | |
|--------------------|------------------------|----------------|---------------------------|---------------|
| F.A. RTE. 0336 | SECTION 05-00308-00-WR | COUNTY MCHENRY | TOTAL SHEETS 606 | SHEET NO. 601 |
| CONTRACT NO. 63398 | | | ILLINOIS FED. AID PROJECT | |

G:\MCDOT\20950_001\Drawings\RDWY\shite\Xsec\S.XS.08_bikepath.dgn