

SCHEDULE OF QUANTITIES
GRAND AVENUE AT LEWIS AVENUE TRAFFIC SIGNAL MODERNIZATION

NO.	QUANT.	UNIT
1.	1,440	SQ FT PORTLAND CEMENT CONCRETE SIDEWALK 5 INCH
2.	106	SQ FT DETECTABLE WARNINGS
3.	210	FOOT COMBINATION CURB AND GUTTER REMOVAL
4.	1,440	SQ FT SIDEWALK REMOVAL
5.	210	FOOT COMBINATION CONCRETE CURB AND GUTTER, TYPE B-6-12
6.	455	FOOT THERMOPLASTIC PAVEMENT MARKING - LINE 6"
7.	125	FOOT THERMOPLASTIC PAVEMENT MARKING - LINE 24"
8.	260	SQ FT PAVEMENT MARKING REMOVAL
9.	45	FOOT CONDUIT IN TRENCH, 2-1/2" DIA., GALVANIZED STEEL
10.	77	FOOT CONDUIT IN TRENCH, 3" DIA., GALVANIZED STEEL
11.	25	FOOT CONDUIT IN TRENCH, 4" DIA., GALVANIZED STEEL
12.	951	FOOT CONDUIT PUSHED, 2" DIA., GALVANIZED STEEL
13.	184	FOOT CONDUIT PUSHED, 4" DIA., GALVANIZED STEEL
14.	4	EACH HANDHOLE
15.	4	EACH HEAVY-DUTY HANDHOLE
16.	2	EACH DOUBLE HANDHOLE
17.	127	FOOT TRENCH AND BACKFILL FOR ELECTRICAL WORK
18.	1	EACH FULL-ACTUATED CONTROLLER AND TYPE IV CABINET, SPECIAL
19.	1,714	FOOT ELECTRIC CABLE IN CONDUIT, SIGNAL NO. 14 2C
20.	1,566	FOOT ELECTRIC CABLE IN CONDUIT, SIGNAL NO. 14 3C
21.	1,394	FOOT ELECTRIC CABLE IN CONDUIT, SIGNAL NO. 14 5C
22.	1,216	FOOT ELECTRIC CABLE IN CONDUIT, SIGNAL NO. 14 7C
23.	2,568	FOOT ELECTRIC CABLE IN CONDUIT, LEAD-IN, NO. 14 1 PAIR
24.	238	FOOT ELECTRIC CABLE IN CONDUIT, SERVICE, NO. 6 2C
25.	2	EACH STEEL MAST ARM ASSEMBLY AND POLE 30 FT. (SPECIAL)
26.	1	EACH STEEL MAST ARM ASSEMBLY AND POLE 36 FT. (SPECIAL)
27.	1	EACH STEEL COMBINATION MAST ARM ASSEMBLY AND POLE 30 FT. (SPECIAL)
28.	16	FOOT CONCRETE FOUNDATION, TYPE A
29.	4	FOOT CONCRETE FOUNDATION, TYPE C
30.	30	FOOT CONCRETE FOUNDATION, TYPE E 30-INCH DIAMETER
31.	30	FOOT CONCRETE FOUNDATION, TYPE E 36-INCH DIAMETER
32.	8	EACH SIGNAL HEAD, LED, 1-FACE, 3-SECTION, MAST-ARM MOUNTED
33.	4	EACH SIGNAL HEAD, LED, 1-FACE, 5-SECTION, BRACKET MOUNTED
34.	4	EACH SIGNAL HEAD, LED, 1-FACE, 5-SECTION, MAST-ARM MOUNTED
35.	4	EACH PEDESTRIAN SIGNAL HEAD, LED, 1-FACE, BRACKET MOUNTED WITH COUNTDOWN TIMER
36.	2	EACH PEDESTRIAN SIGNAL HEAD, LED, 2-FACE, BRACKET MOUNTED WITH COUNTDOWN TIMER
37.	12	EACH TRAFFIC SIGNAL BACKPLATE, LOUVERED, ALUMINIUM
38.	14	EACH INDUCTIVE LOOP DETECTOR
39.	731	FOOT DETECTOR LOOP, TYPE 1
40.	2	EACH LIGHT DETECTOR
41.	1	EACH LIGHT DETECTOR AMPLIFIER
42.	8	EACH PEDESTRIAN PUSH-BUTTON
43.	1	EACH TEMPORARY TRAFFIC SIGNAL INSTALLATION
44.	1	EACH REMOVE EXISTING TRAFFIC SIGNAL EQUIPMENT
45.	7	EACH REMOVE EXISTING HANDHOLE
46.	9	EACH REMOVE EXISTING CONCRETE FOUNDATION
47.	1	EACH TEMPORARY TRAFFIC SIGNAL TIMINGS
48.	1	EACH SERVICE INSTALLATION POLE MOUNT
49.	1	EACH UNINTERRUPTIBLE POWER SUPPLY
50.	600	FOOT ELECTRIC CABLE IN CONDUIT, GROUNDING, NO. 6 1C
51.	477	FOOT ELECTRIC CABLE IN CONDUIT NO. 20 3/C, TWISTED, SHIELDED
52.	174	FOOT ELECTRIC CABLE IN CONDUIT, COAXIAL
53.	4	EACH TRAFFIC SIGNAL POST, 16 FOOT (SPECIAL)
54.	4	EACH LED INTERNALLY ILLUMINATED STREET NAME SIGN
55.	1	EACH REMOTE CONTROLLED VIDEO SYSTEM
56.	1	EACH LAYER II (DATA LINK) SWITCH
57.	1	EACH VIDEO ENCODER

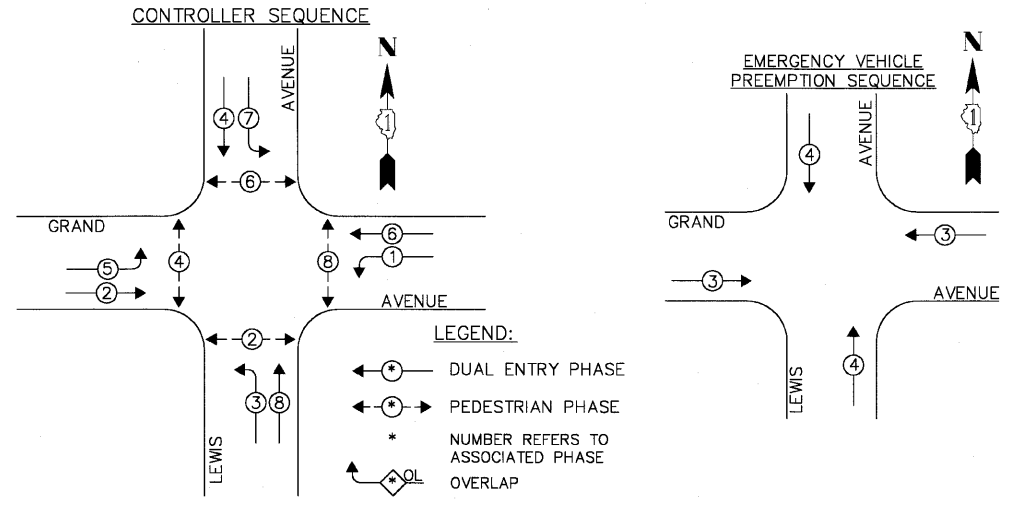
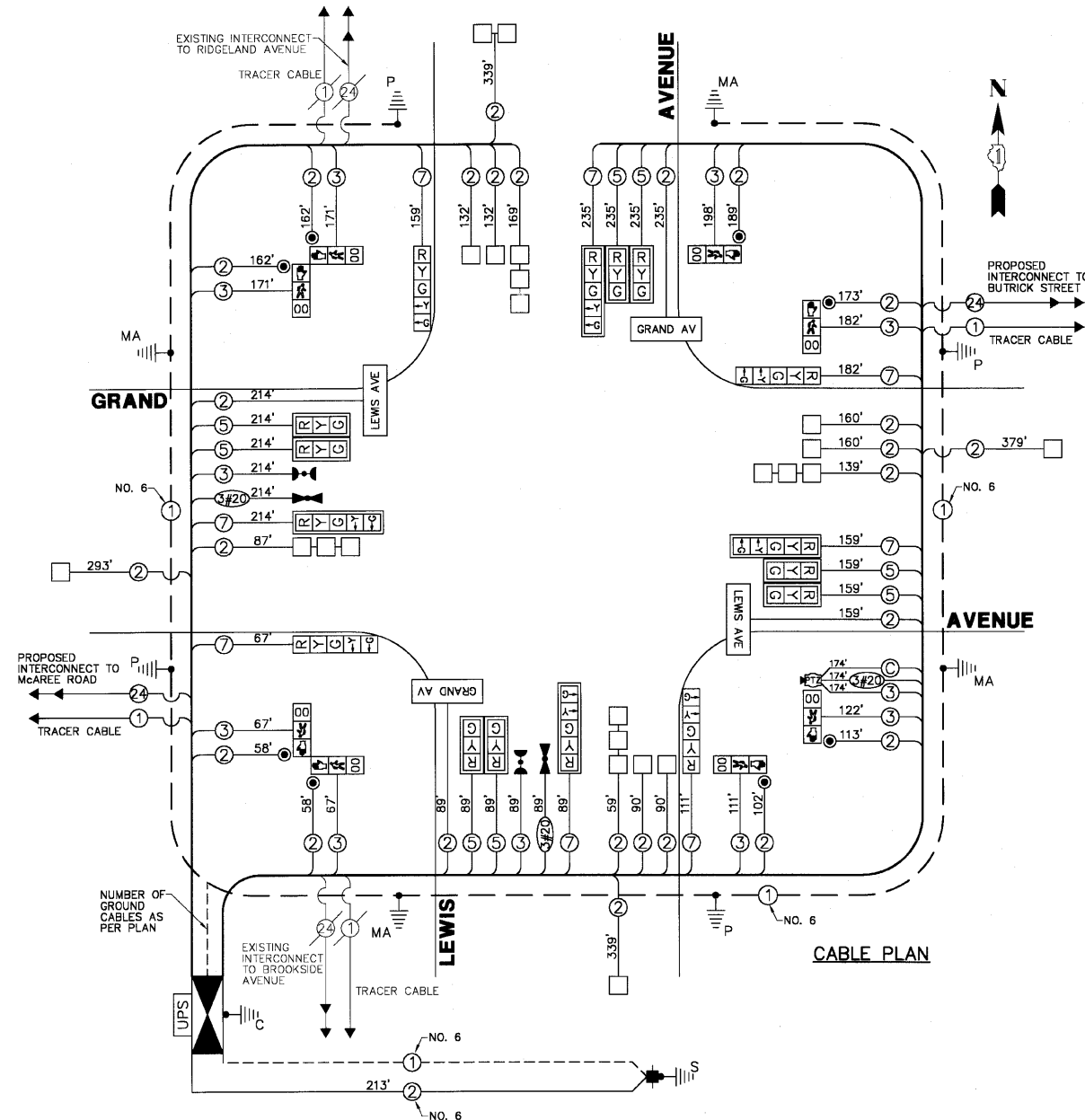

EMERGENCY VEHICLE PREEMPTOR	3	4
MOVEMENT	←	↑

L.C.D.O.T. TRAFFIC SIGNAL INSTALLATION ELECTRICAL SERVICE REQUIREMENTS				TOTAL WATTAGE
TYPE	NO LAMPS	WATTAGE INCAND. I.E.D.	% OPERATION	
SIGNAL (RED)	16	135	10	80.0
SIGNAL (YELLOW)	16	135	19	30.4
SIGNAL (GREEN)	16	135	11	70.4
ARROW	16	135	9	14.4
PED. SIGNAL	8	90	9	72.0
CONTROLLER	1	-	100	100.0
LUMINAIRE	-	250	0.50	-
I.E.D. ST. NAME SIGN	4	64	0.50	128.0
VIDEO SYSTEM	1	150	1.00	150.0
BATTERY BACKUP	1	25	1.00	25.0
TOTAL =				670.2

THE TRAFFIC SIGNAL CONTROL EQUIPMENT FOR THIS PROJECT SHALL BE "NTCIP" COMPLIANT.

FOUNDATION (DEPTH)	(FT.)	CABLE SLACK	(FT.)	VERTICAL	(FT.)
TYPE A - POST	4	HANDHOLE	6.5	ALL FOUNDATIONS	3.5
TYPE D - CONTROLLER	4	DOUBLE HANDHOLE	13	MAST ARM (L) POLE	20'-L-25
TYPE E - M.ARM POLE	15	SIGNAL POST	2	BRACKET MOUNTED	13
		CONTROLLER CAB.	1	PED. PUSHBUTTON	4
		FIBER OPTIC	13	ELECTRIC SERVICE	13.5
		ELECTRIC SERVICE	1	SERVICE TO GROUND	13.5
		GROUND CABLE	1	POST MOUNTED	6

ENERGY COSTS - BILLED TO: CITY OF WAUKEGAN (ADDRESS) 100 N. M.L.K. JR. AVENUE (ADDRESS) WAUKEGAN, IL
ENERGY SUPPLY - CONTACT: GERRY GRANDBERRY PHONE: (847) 816-5463 COMPANY: COM-ED, LIBERTYVILLE

FILE NAME = 4136.800-TR2.dwg USER NAME = GH
PLOT SCALE = 1" = .0833' PLOT DATE = 3/10/10

DESIGNED - JRD REVISIONS -
DRAWN - ZCW REVISIONS -
CHECKED - DPB REVISIONS -
DATE - 3/10/10 REVISIONS -



CABLE PLAN, PHASE DESIGNATION DIAGRAM AND SCHEDULE OF QUANTITIES
GRAND AVENUE AT LEWIS AVENUE
SCALE: NONE SHEET NO. OF SHEETS STA. TO STA.

FAP RTE	SECTION	COUNTY	TOTAL SHEETS	SHEET NO.
541	08-00279-00-TL	LAKE	64	24
CONTRACT #:			63436	

GHA #4136.800

ILLINOIS FED. AID PROJECT