

TEMPORARY CABLE PLAN

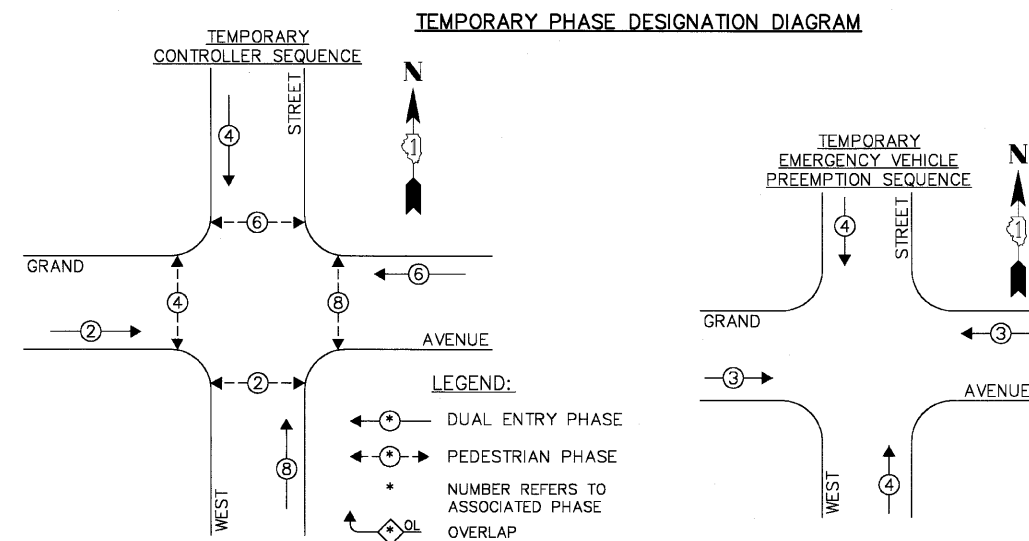

TEMPORARY PHASE DESIGNATION DIAGRAM

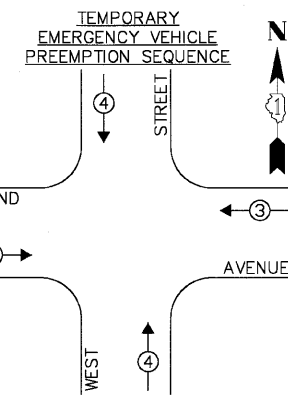

TEMPORARY EMERGENCY VEHICLE PREEMPTORS	
EMERGENCY VEHICLE PREEMPTOR	3 4
MOVEMENT	==

L.C.D.O.T. TRAFFIC SIGNAL INSTALLATION ELECTRICAL SERVICE REQUIREMENTS					TOTAL WATTAGE
TYPE	NO LAMPS	WATTAGE INCAND. L.E.D.	% OPERATION		
SIGNAL (RED)	12	135 10	0.50		60.0
SIGNAL (YELLOW)	12	135 19	0.10		22.8
SIGNAL (GREEN)	12	135 11	0.40		52.8
ARROW	-	135 9	0.10		-
PEJ.SIGNAL	8	90 9	1.00		72.0
CONTROLLER	-	- 100	1.00		100.0
LUMINAIRE	-	- 250	0.50		-
L.E.D. ST. NAME SIGN	-	- 64	0.50		-
VIDEO SYSTEM	-	- 150	1.00		-
BATTERY BACKUP	-	- 25	1.00		-
TOTAL =					307.6

ENERGY COSTS - BILLED TO: CITY OF WAUKEGAN
 (ADDRESS) 100 N. M.L.K. JR. AVENUE
 (ADDRESS) WAUKEGAN, IL
 ENERGY SUPPLY - CONTACT: GERRY GRANDBERRY
 PHONE: (847) 816-5463
 COMPANY: COM-ED, LIBERTYVILLE

FILE NAME = 4136.800-TR2.dwg	USER NAME = GHA	DESIGNED - JRD	REVISED -
	PLOT SCALE = 1" = .0833'	DRAWN - ZCW	REVISED -
	PLOT DATE = 3/10/10	CHECKED - DPB	REVISED -
		DATE - 3/10/10	REVISED -



TEMPORARY CABLE PLAN AND PHASE DESIGNATION DIAGRAM
GRAND AVENUE AT WEST STREET
 SCALE: NONE SHEET NO. OF SHEETS STA. TO STA.

F&P R.T.E. 541	SECTION 08-00279-00-TL	COUNTY LAKE	TOTAL SHEETS 64	SHEET NO. 34
CONTRACT # 63436			GHA #4136.800	
ILLINOIS FED. AID PROJECT				