

LEGEND

- STREET NAME SIGN
- COMBINATION CONCRETE CURB & GUTTER, TYPE B-6.12 OR TYPE B-6.24
- PORTLAND CEMENT CONCRETE SIDEWALK, 5"
- DETECTABLE WARNING
- LED ILLUMINATED STREET NAME SIGN
- BRICK PAVER REINSTALLATION

PROPOSED



Restoration of Work Area. Restoration of the traffic signal work area shall be incidental to the related pay items such as foundation, conduit, handhole, trench and backfill, etc., and no extra compensation shall be allowed. All roadway surfaces such as shoulders, medians, sidewalks, pavement, etc. shall be replaced in kind. All damage to mowed lawns shall be replaced with an approved sod, and all damage to unmowed fields shall be seeded in accordance with Standard Specifications 252 and 250 respectively.

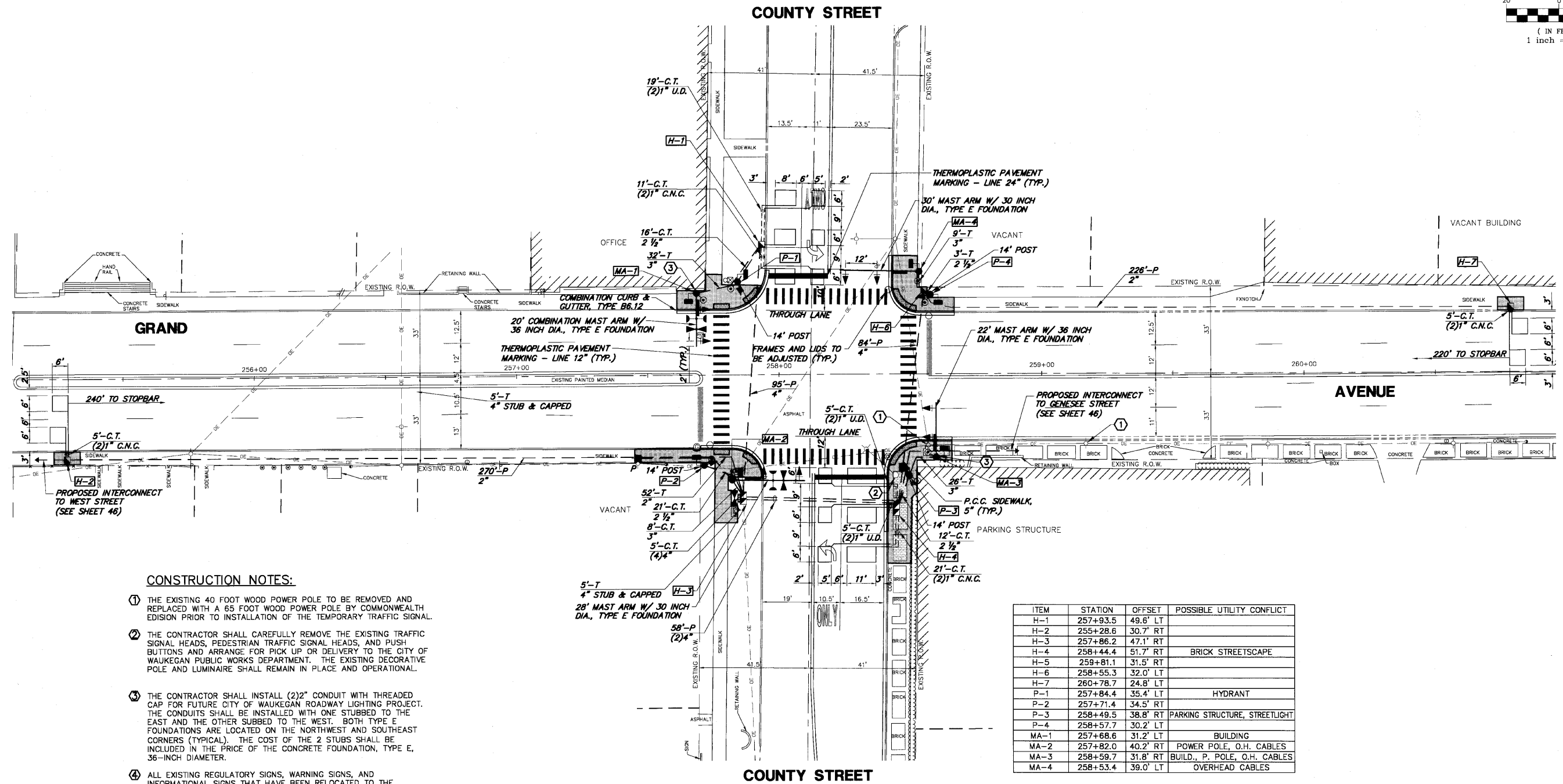
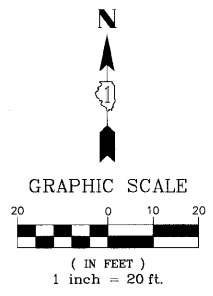

CONSTRUCTION NOTES:

- 1 THE EXISTING 40 FOOT WOOD POWER POLE TO BE REMOVED AND REPLACED WITH A 65 FOOT WOOD POWER POLE BY COMMONWEALTH EDISON PRIOR TO INSTALLATION OF THE TEMPORARY TRAFFIC SIGNAL.
- 2 THE CONTRACTOR SHALL CAREFULLY REMOVE THE EXISTING TRAFFIC SIGNAL HEADS, PEDESTRIAN TRAFFIC SIGNAL HEADS, AND PUSH BUTTONS AND ARRANGE FOR PICK UP OR DELIVERY TO THE CITY OF WAUKEGAN PUBLIC WORKS DEPARTMENT. THE EXISTING DECORATIVE POLE AND LUMINAIRE SHALL REMAIN IN PLACE AND OPERATIONAL.
- 3 THE CONTRACTOR SHALL INSTALL (2)2" CONDUIT WITH THREADED CAP FOR FUTURE CITY OF WAUKEGAN ROADWAY LIGHTING PROJECT. THE CONDUITS SHALL BE INSTALLED WITH ONE STUBBED TO THE EAST AND THE OTHER STUBBED TO THE WEST. BOTH TYPE E FOUNDATIONS ARE LOCATED ON THE NORTHWEST AND SOUTHEAST CORNERS (TYPICAL). THE COST OF THE 2 STUBS SHALL BE INCLUDED IN THE PRICE OF THE CONCRETE FOUNDATION, TYPE E, 36-INCH DIAMETER.
- 4 ALL EXISTING REGULATORY SIGNS, WARNING SIGNS, AND INFORMATIONAL SIGNS THAT HAVE BEEN RELOCATED TO THE TEMPORARY TRAFFIC SIGNALS SHALL BE RELOCATED SECURELY TO THE PERMANENT TRAFFIC SIGNAL MAST ARM POLE OR POST AS DIRECTED BY THE ENGINEER. THE COST FOR THE RELOCATION OF THE EXISTING SIGNS SHALL BE INCLUDED IN THE PRICE FOR TRAFFIC CONTROL AND PROTECTION (SPECIAL).

ITEM	STATION	OFFSET	POSSIBLE UTILITY CONFLICT
H-1	257+93.5	49.6' LT	
H-2	255+28.6	30.7' RT	
H-3	257+86.2	47.1' RT	
H-4	258+44.4	51.7' RT	BRICK STREETSCAPE
H-5	259+81.1	31.5' RT	
H-6	258+55.3	32.0' LT	
H-7	260+78.7	24.8' LT	
P-1	257+84.4	35.4' LT	HYDRANT
P-2	257+71.4	34.5' RT	
P-3	258+49.5	38.8' RT	PARKING STRUCTURE, STREETLIGHT
P-4	258+57.7	30.2' LT	
MA-1	257+68.6	31.2' LT	BUILDING
MA-2	257+82.0	40.2' RT	POWER POLE, O.H. CABLES
MA-3	258+59.7	31.8' RT	BUILD., P. POLE, O.H. CABLES
MA-4	258+53.4	39.0' LT	OVERHEAD CABLES

NOTE: THE LUMINAIRE ARM SHALL BE TWENTY (20) FEET IN LENGTH.

THE TRAFFIC SIGNAL CONTROL EQUIPMENT FOR THIS PROJECT SHALL BE "NTCIP" COMPLIANT.

GHA #4136.800

FILE NAME = 4136.800-TR2.dwg	USER NAME = GHA	DESIGNED - JRD	REVISED -		TRAFFIC SIGNAL MODERNIZATION PLAN			F&P RTE = 541	SECTION = 08-00279-00-TL	COUNTY = LAKE	TOTAL SHEETS = 64	SHEET NO. = 39	
	PLOT SCALE = 1" = .0833'	DRAWN - ZCW	REVISED -		GRAND AVENUE AT COUNTY STREET								
	PLOT DATE = 3/10/10	CHECKED - DPB	REVISED -		SCALE: 1" = 20'			SHEET NO. OF SHEETS	STA. TO STA.	ILLINOIS FED. AID PROJECT			
		DATE - 3/10/10	REVISED -		CONTRACT #: 63436								