

SHERIDAN ROAD

Restoration of Work Area. Restoration of the traffic signal work area shall be incidental to the related pay items such as foundation, conduit, handhole, trench and backfill, etc., and no extra compensation shall be allowed. All roadway surfaces such as shoulders, medians, sidewalks, pavement, etc. shall be replaced in kind. All damage to mowed lawns shall be replaced with an approved sod, and all damage to unmowed fields shall be seeded in accordance with Standard Specifications 252 and 250 respectively.

THE TRAFFIC SIGNAL CONTROL EQUIPMENT FOR THIS PROJECT SHALL BE "NTCIP" COMPLIANT.

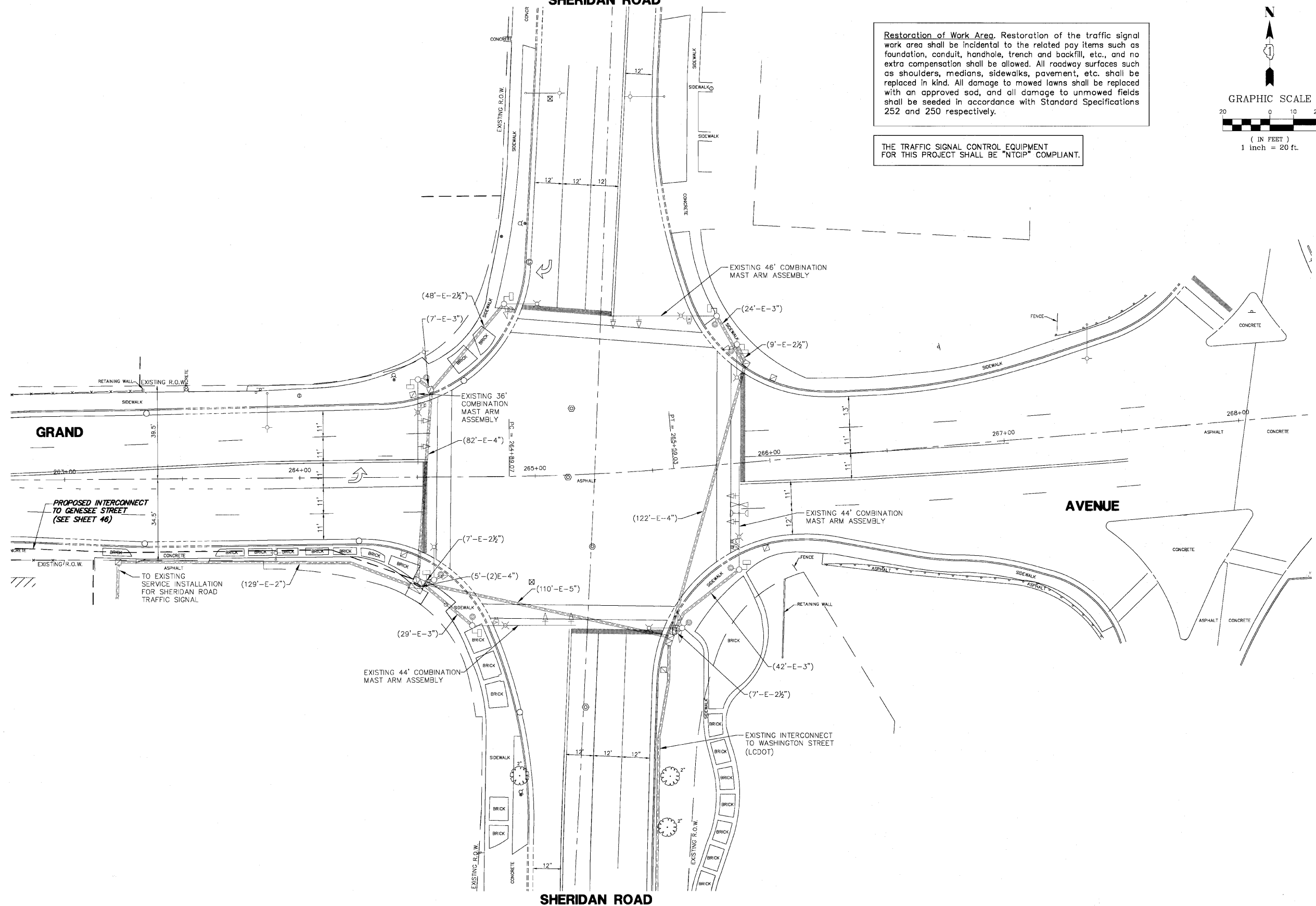
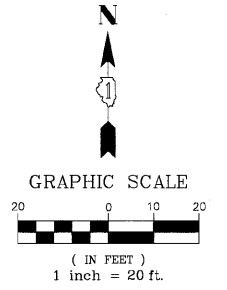

GHA #4136.800

FILE NAME = 4136.800-TR2.dwg

USER NAME = GHA
 PLOT SCALE = 1" = .0833'
 PLOT DATE = 3/10/10

DESIGNED - JRD
 DRAWN - ZCW
 CHECKED - DPB
 DATE - 3/10/10

REVISED -
 REVISED -
 REVISED -
 REVISED -



TRAFFIC SIGNAL MODERNIZATION PLAN
GRAND AVENUE AT SHERIDAN ROAD
 SCALE: 1"=20'
 SHEET NO. OF SHEETS STA. TO STA.

| F.A.P. RTE. | SECTION | COUNTY | TOTAL SHEETS | SHEET NO. |
|---------------------------|----------------|--------|--------------|-----------|
| 541 | 08-00279-00-TL | LAKE | 64 | 45 |
| CONTRACT #: | | | 63436 | |
| ILLINOIS FED. AID PROJECT | | | | |