

**SCHEDULE OF QUANTITIES**

GRAND AVENUE FROM GREEN BAY ROAD TO SHERIDAN ROAD TRAFFIC SIGNAL MODERNIZATION

NO.	QUANT.	UNIT
1.	1,600	SQ YD TOPSOIL FURNISH AND PLACE, 4"
2.	45	POUND NITROGEN FERTILIZER NUTRIENT
3.	45	POUND PHOSPHORUS FERTILIZER NUTRIENT
4.	45	POUND POTASSIUM FERTILIZER NUTRIENT
5.	1,600	SQ YD SODDING, SALT TOLERANT
6.	8	UNIT SUPPLEMENTAL WATERING
7.	1,400	SQ FT PORTLAND CEMENT CONCRETE SIDEWALK 5 INCH
8.	1,000	SQ FT TEMPORARY SIDEWALK
9.	1,400	SQ FT SIDEWALK REMOVAL
10.	3,555	FOOT CONDUIT IN TRENCH, 2" DIA., GALVANIZED STEEL
11.	8,240	FOOT CONDUIT PUSHED, 2" DIA., GALVANIZED STEEL
12.	17	EACH HANDHOLE
13.	3,555	FOOT TRENCH AND BACKFILL FOR ELECTRICAL WORK
14.	2	EACH DRILL EXISTING HANDHOLE
15.	51.40	SQ FT TEMPORARY INFORMATION SIGNING
16.	15,734	FOOT ELECTRIC CABLE IN CONDUIT, TRACER, NO. 14 1C
17.	1	EACH OPTIMIZE TRAFFIC SIGNAL SYSTEM
18.	12	EACH TERMINATE FIBER IN CABINET
19.	15,735	FOOT FIBER OPTIC CABLE IN CONDUIT, 24 SINGLEMODE

**CONSTRUCTION NOTES:**

- ① THE CONTRACTOR SHALL TERMINATE 12 NEW SINGLEMODE FIBERS IN THE INTERSECTION CABINET AND GRAND AVENUE AND IL 131 (GREEN BAY ROAD) AND AT GRAND AVENUE AND SHERIDAN ROAD. ALL CONNECTORS, PIGTAILS, SPLICE TRAYS, BULKHEADS, TEST, DOCUMENTATION, AND SPLICING OF PIGTAILS FOR SINGLEMODE FIBERS IS INCLUDED IN THE COST OF "TERMINATE FIBER IN CABINET".

**INTERCONNECT SCHEMATIC LEGEND**

EXISTING INTERSECTION CONTROLLER		EXISTING FIBER OPTIC CABLE IN CONDUIT, NO. 62.5/125, MM12F SM12F	
PROPOSED INTERSECTION CONTROLLER		PROPOSED FIBER OPTIC CABLE IN CONDUIT, NO. 62.5/125, MM12F SM12F	
EXISTING MASTER CONTROLLER		EXISTING INTERCONNECT CABLE - NO. 62.5/125 12F FIBER OPTIC CABLE	
PROPOSED MASTER CONTROLLER		PROPOSED INTERCONNECT CABLE - NO. 18 3 PAIR TWISTED, SHIELDED	
MASTER MASTER CONTROLLER		EXISTING INTERCONNECT CABLE - NO. 18 3 PAIR TWISTED, SHIELDED	
EXISTING INTERSECTION & SAMPLING (SYSTEM) DETECTORS		PROPOSED INTERCONNECT CABLE - NO. 18 3 PAIR TWISTED, SHIELDED	
PROPOSED INTERSECTION & SAMPLING (SYSTEM) DETECTORS		EXISTING LOOP DETECTOR CABLE 2/C TWISTED, SHIELDED	
EXISTING INTERSECTION LOOP DETECTORS		PROPOSED LOOP DETECTOR CABLE 2/C TWISTED, SHIELDED	
PROPOSED INTERSECTION LOOP DETECTORS		EXISTING ELECTRIC CABLE, 1/C (AS SPECIFIED)	
EXISTING SAMPLING (SYSTEM) DETECTORS		PROPOSED ELECTRIC CABLE, 1/C (AS SPECIFIED)	
PROPOSED SAMPLING (SYSTEM) DETECTORS		EXISTING INTERCONNECT CABLE - NO. 62.5/125, 36F FIBER OPTIC CABLE	
EXISTING SAMPLING (SYSTEM) DETECTORS, PROPOSED INTERSECTION AND SAMPLING (SYSTEM) DETECTORS		PROPOSED FIBER OPTIC CABLE IN CONDUIT - 24 SINGLEMODE	
EXISTING SAMPLING (SYSTEM) DETECTORS, PROPOSED SAMPLING (SYSTEM) DETECTORS		EXISTING TELEPHONE CONNECTION	
EXISTING PREFORMED INTERSECTION & SAMPLING (SYSTEM) DETECTORS		PROPOSED TELEPHONE CONNECTION	
PROPOSED PREFORMED INTERSECTION & SAMPLING (SYSTEM) DETECTORS		EXISTING ISDN TELEPHONE CONNECTION	
EXISTING SAMPLING (SYSTEM) PREFORMED DETECTORS		PROPOSED ISDN TELEPHONE CONNECTION	
PROPOSED SAMPLING (SYSTEM) PREFORMED DETECTORS			

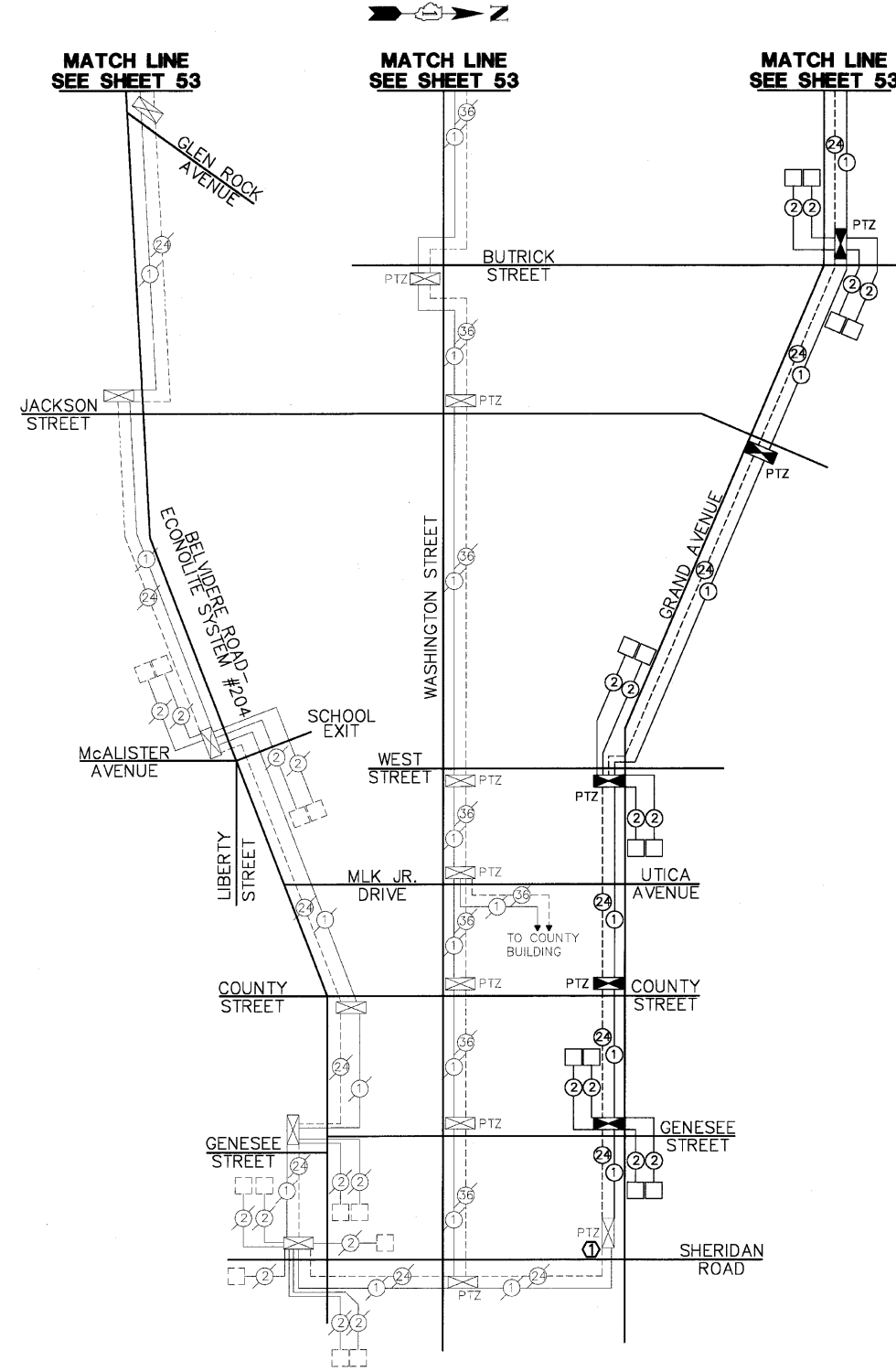

GHA #4136.800

FILE NAME = 4136.800-TR2.dwg	USER NAME = GHA	DESIGNED - JRD	REVISED -
	PLOT SCALE = 1" = .0833'	DRAWN - ZCW	REVISED -
	PLOT DATE = 3/10/10	CHECKED - DPB	REVISED -
		DATE - 3/10/10	REVISED -



**INTERCONNECT SCHEMATIC (SHEET 2 OF 2)  
GRAND AVENUE FROM IL RTE 131 (GREEN BAY RD) TO SHERIDAN ROAD**

SCALE: NONE SHEET NO. 2 OF 2 SHEETS STA. TO STA.

F&P RTE.	SECTION	COUNTY	TOTAL SHEETS	SHEET NO.
541	08-00279-00-TL	LAKE	64	54

CONTRACT #: 63436

ILLINOIS FED. AID PROJECT