









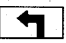

**ROUTE MARKERS**

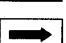
-  FOR U.S. ROUTES  
M1-40-2424
-  FOR ILLINOIS ROUTES  
M1-50-2424
-  R.R. UNMARKED ROUTES  
SPECIAL 24" x 18" VARIABLE  
4" BLACK LETTERS ON WHITE  
REFLECTIVE BACKGROUND

**ARROWS SIGNS**

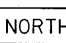
-  M5-1L-2115
-  M5-1R-2115
-  M6-1-2115
-  M6-1-2115
-  M6-3-2115

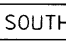
**CARDINAL DIRECTION & DETOUR SIGNS**

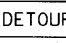
-  NORTH M3-1-2412
-  EAST M3-2-2412
-  SOUTH M3-3-2412
-  WEST M3-4-2412
-  DETOUR M4-8-2412

**STATE ROUTE**

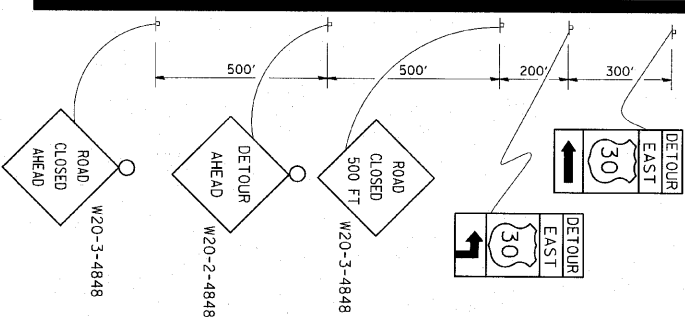

**COMPLETELY CLOSED PORTION**

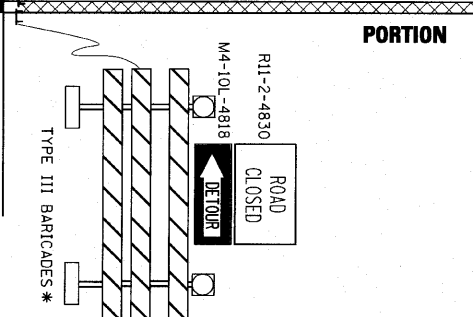

**PARTIALLY CLOSED PORTION**

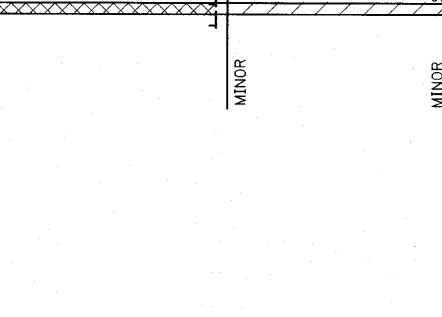

**STATE ROUTE**

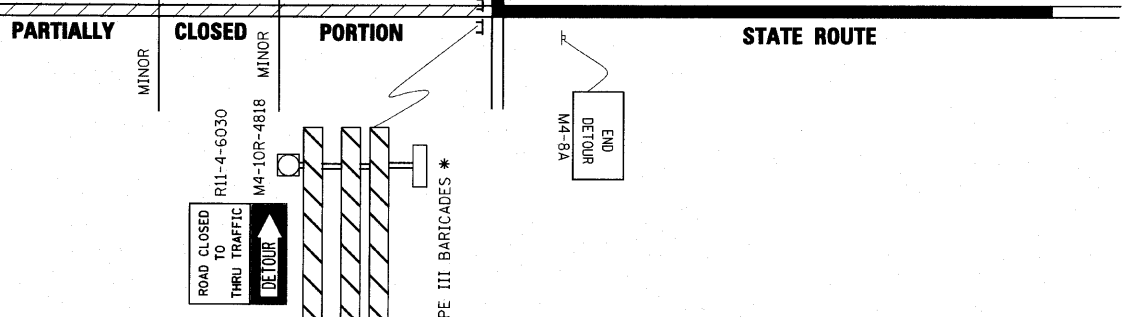

\* IF A TYPE III BARRICADE WITH AN ATTACHED SIGN PANEL WHICH MEETS NCHRP 350 REQUIREMENTS IS NOT AVAILABLE, THE SIGNS SHALL BE MOUNTED, ABOVE THE BARRICADES, ON SEPARATE SIGNS SUPPORTS THAT MEET NCHRP 350 REQUIREMENTS.

FILE NAME =	USER NAME = drivakosgn	DESIGNED -	REVISED - 10-18-02	<b>STATE OF ILLINOIS DEPARTMENT OF TRANSPORTATION</b>	<b>DETOUR SIGNING FOR CLOSING STATE HIGHWAYS</b>		F.A. RTE.	SECTION	COUNTY	TOTAL SHEETS	SHEET NO.
ct:\pw-work\PIWIDOT\DRIVAKOSGN\0108315\21.dgn		DRAWN	REVISED - R. BORO 09-14-09		SCALE: NONE	SHEET NO. 1 OF 1 SHEETS	STA.	03-00050-00-BR	DUPAGE	45	42
		CHECKED -	REVISED -				TO STA.	TC-21	CONTRACT NO. 63468		
		DATE -	REVISED -					FED. ROAD DIST. NO. 1	ILLINOIS FED. AID PROJECT	BMM-8003 (678)	