

GENERAL NOTES

- Precast concrete culverts, 10'x5' shall conform to the requirements of Article 540.06 of the Standard Specifications and the applicable requirements of AASHTO M 273.

The minimum precast concrete strength shall be 5,000 psi.

Lifting holes shall be filled with concrete plugs and mastic after box sections are in place.

Fill varies 1' to 2'
- BOX CULVERT END SECTIONS shall be paid for as noted in Article 540.08, and The Contract Unit Price for BOX CULVERT END SECTIONS shall include all porous granular bedding material, cast in place wingwalls, headwalls, and aprons, cast in place portions between cells, reinforcement, excavation, backfill, and preformed joint filler.
- Contractor shall maintain streamflow in accordance with the Standard Specifications Article 502.
- Reinforcement bars shall conform to the requirements of ASTM A 760 Gr 60. See Special Provisions.
- Reinforcement bars designated (E) shall be epoxy coated
- Diversion and Construction activities shall not be permitted to cause water levels upstream to rise more than 2'-0" above the normal pool, or above elevations = 916.50.
- "Exploration Trench-Special" is to be used to locate the existing water main and gas line (if not already relocated). See Removal Plan. The location shall be completed prior to full mobilization. Apparent conflicts shall be brought to the Engineer's attention and resolved prior to full mobilization.

TOTAL BILL OF MATERIAL

ITEM	UNIT	TOTAL
Stone Dumped Riprap, Class A3	Ton	45
Removal of Existing Structures	Each	1
Name Plates	Each	1
Parapet Railing	Foot	71
Box Culvert End Sections, Culvert No. 1	Each	2
Precast Concrete Box Culverts, 10'x5' (M273)	Foot	160
Expansion Bolts 3/4 Inch	Each	60

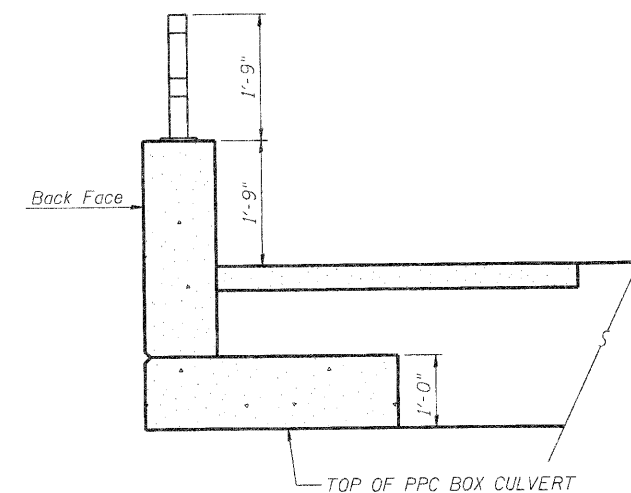

SECTION THRU SIDEWALK

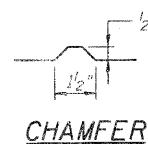
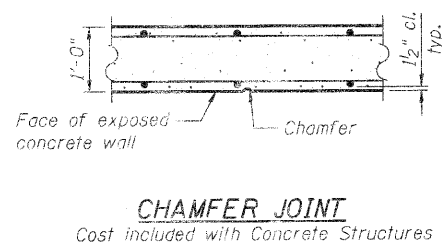
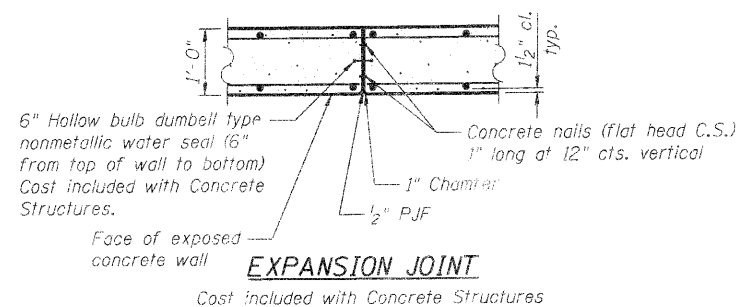

GENERAL NOTES
TOTAL BILL OF MATERIALS
AYER STREET (FAU ROUTE 0005)
OVER MOKELER CREEK
SECTION NO. 06-00057-00-BR
McHENRY COUNTY
STATION 203+07.55
STRUCTURE NO. 056-6203

DATE: 8/16/10

DESIGNED	MGH/JPG
CHECKED	KMA
DRAWN	WJH
CHECKED	RGD



SEC GROUP, INC.
An HR Green Company
420 N. Front Street, McHenry, IL 60050
t. 815.385.1778 f. 815.385.1781
www.secgroupinc.com

Illinois Professional Design Firm # 184-000108
McHenry, IL • Yorkville, IL • New Lenox, IL • Chicago, IL

SHEET NO. S-2	F.A.U. RTE.	SECTION	COUNTY	TOTAL SHEETS	SHEET NO.
	0005	06-00057-00-BR	McHENRY	22	13
S-5 SHEETS			CONTRACT NO. 63508		
FED. ROAD DIST. NO. 1 ILLINOIS FED. AID PROJECT					

FILE NAME: 060594-con.dwg 8/16/2010
PLOT DRIVER: pdtplot
PEN TABLE: Struct 22x34.tbl