

STATE OF ILLINOIS  
DEPARTMENT OF TRANSPORTATION

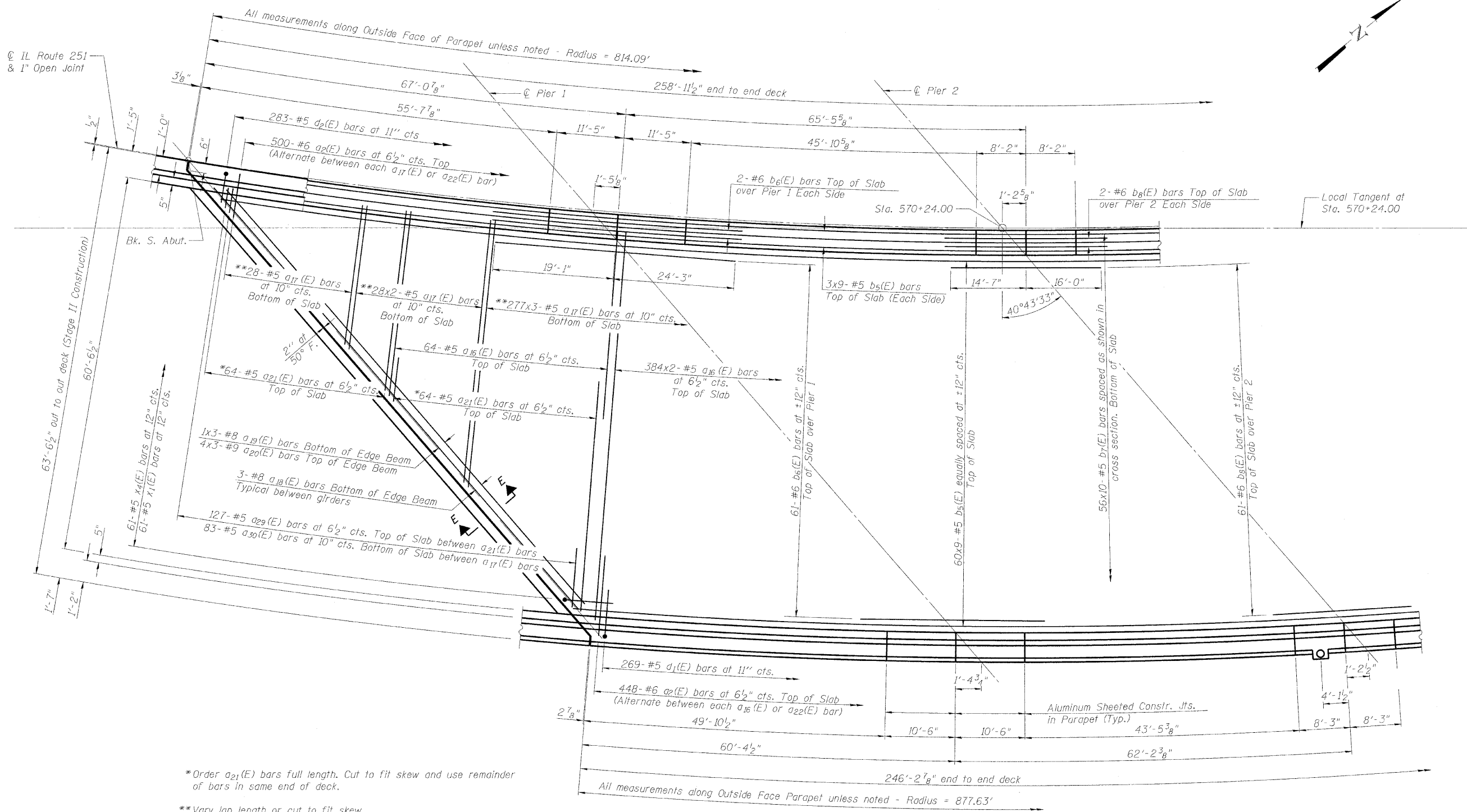

\*Order a<sub>21</sub>(E) bars full length. Cut to fit skew and use remainder of bars in same end of deck.  
\*\*Vary lap length or cut to fit skew.

**NORTHBOUND DECK PLAN - SPANS 1 AND 2**

**DECK PLAN - NORTHBOUND  
SPANS 1 AND 2  
STRUCTURE NO. 101-0190**

10/19/2010 11:12:35 AM g:\project\1082773\_001\cadd\structural\sheet\1010190-64B79-018-DeckPlan\_NB\_1&2.dgn

DESIGNED	JY
CHECKED	GSP
DRAWN	MJB
CHECKED	JY

**MINIMUM BAR LAPS**  
(Deck)

#5 Bar	- 2'-7"
#6 Bar	- 3'-1"
#8 Bar	- 6'-9"
#9 Bar	- 9'-8"

Notes:  
See Sheet 20 for deck cross section.  
See Sheets 22 and 23 for superstructure details, Section E-E and Bill of Material.  
Bars indicated thus 20 x 3-#5 etc. indicates 20 lines of bars with 3 lengths per line.  
See Sheet 21 for parapet reinforcement.  
Transverse bars shall be placed radially.  
Longitudinal bars shall be placed along the curve.

SHEET NO. 18  61 SHEETS	F.A.* RTE.	SECTION	COUNTY	TOTAL SHEETS	SHEET NO.
	*	1-HBR & 1-2HB-D	WINNEBAGO	216	73
IL RTE 251 & FOREST HILLS RD CONTRACT NO. 64B79					
FED. ROAD DIST. NO. 7 ILLINOIS FED. AID PROJECT					

\* F.A.P. 303 & F.A.U. 5146

Revised 10/25/10 BHS

