

STATE OF ILLINOIS
DEPARTMENT OF TRANSPORTATION

*Order a₂₂(E) bars full length. Cut to fit skew and use remainder of bars in same end of deck.

**Vary lap length or cut to fit skew.

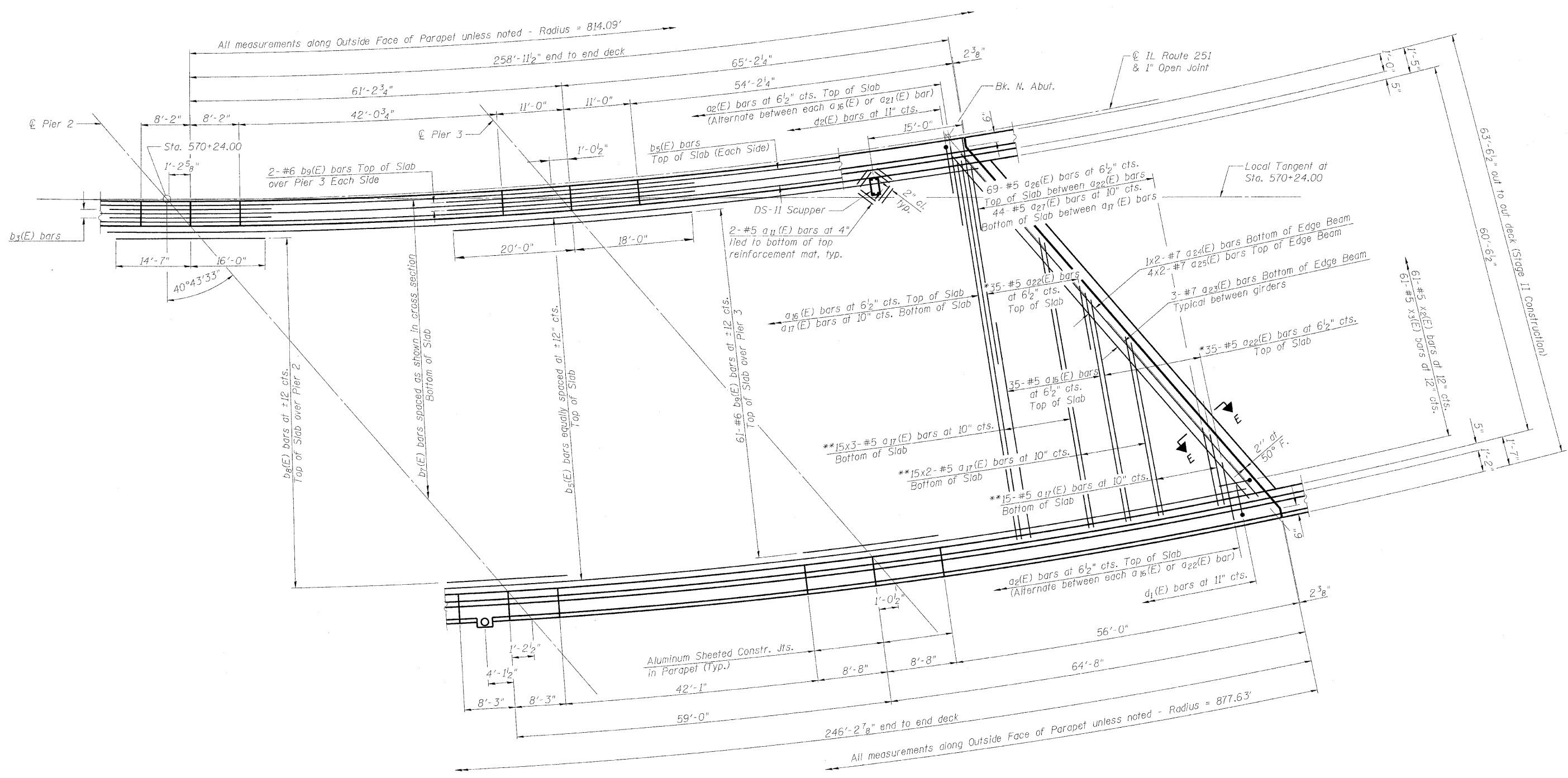
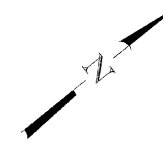

NORTHBOUND DECK PLAN - SPANS 3 AND 4

**DECK PLAN - NORTHBOUND
SPANS 3 AND 4
STRUCTURE NO. 101-0190**

DESIGNED	- JY
CHECKED	- GSP
DRAWN	- MJB
CHECKED	- JY

MINIMUM BAR LAPS
(Deck)

#5 Bar	- 2'-7"
#6 Bar	- 3'-1"
#7 Bar	- 5'-10"

Notes:
See Sheet 20 for deck cross section.
See Sheets 22 and 23 for superstructure details, Section F-F and Bill of Material.
Bars indicated thus 20 x 3-#5 etc. indicates 20 lines of bars with 3 lengths per line.
See Sheet 21 for parapet reinforcement.
Traverse bars shall be placed radially.
Longitudinal bars shall be placed along the curve.

SHEET NO. 19 61 SHEETS	F.A.* RTE.	SECTION	COUNTY	TOTAL SHEETS	SHEET NO.
	*	1-HBR & 1-2HB-D	WINNEBAGO	216	74
IL RTE 251 & FOREST HILLS RD CONTRACT NO. 64B79					
FED. ROAD DIST. NO. 7 ILLINOIS FED. AID PROJECT					

* F.A.P. 303 & F.A.U. 5146

Revised 10/25/10 BHS

10/19/2010 11:12:37 AM g:\project\12082773_001\cadd\structure\sheet\1010190-64B79-019-DeckPlan_NB_3&4.dgn

