

DATE	
BY	
REVISIONS	
NO.	
DESCRIPTION	
DATE	
BY	
REVISIONS	
NO.	
DESCRIPTION	
DATE	
BY	
REVISIONS	
NO.	
DESCRIPTION	
DATE	
BY	
REVISIONS	
NO.	
DESCRIPTION	
DATE	
BY	
REVISIONS	
NO.	
DESCRIPTION	
DATE	
BY	
REVISIONS	
NO.	
DESCRIPTION	

DATE	
BY	
REVISIONS	
NO.	
DESCRIPTION	
DATE	
BY	
REVISIONS	
NO.	
DESCRIPTION	
DATE	
BY	
REVISIONS	
NO.	
DESCRIPTION	
DATE	
BY	
REVISIONS	
NO.	
DESCRIPTION	
DATE	
BY	
REVISIONS	
NO.	
DESCRIPTION	

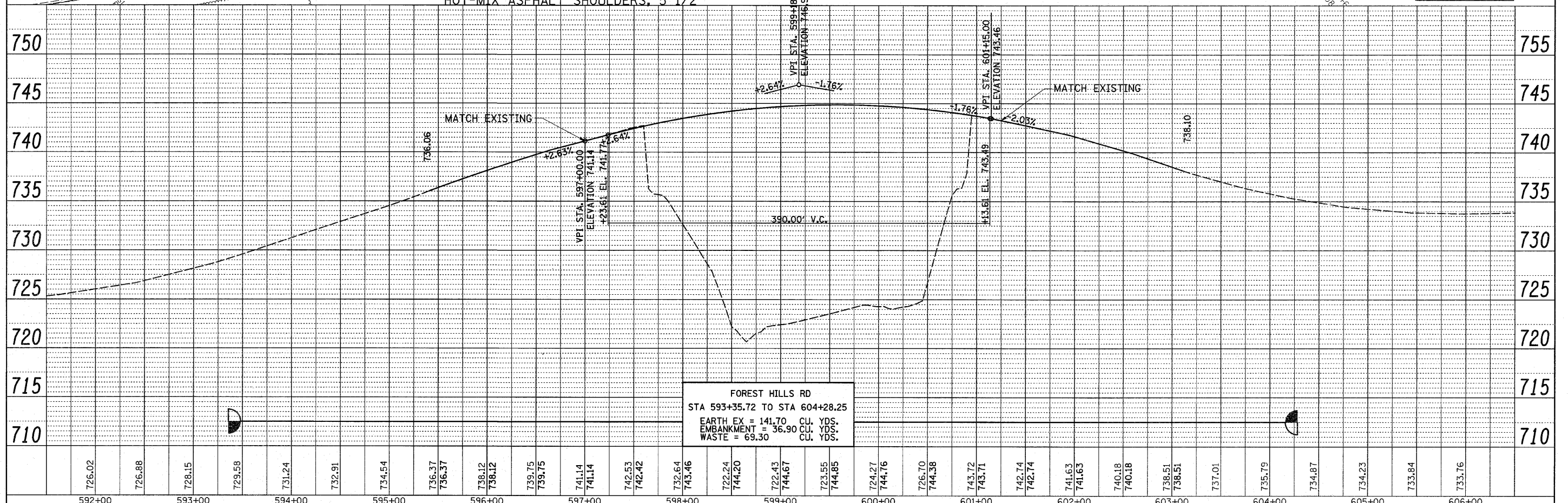
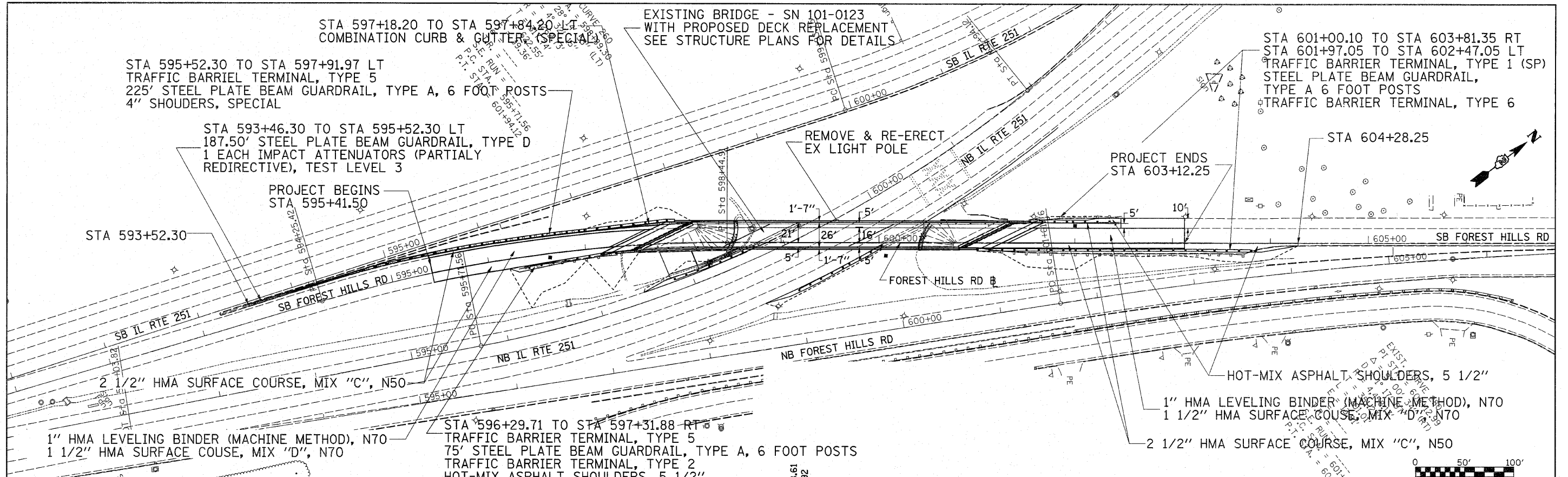

FOREST HILLS RD
 STA 593+35.72 TO STA 604+28.25
 EARTH EX = 141.70 CU. YDS.
 EMBANKMENT = 36.90 CU. YDS.
 WASTE = 69.30 CU. YDS.

FILE NAME =	USER NAME = goffjl	DESIGNED -	REVISED -	STATE OF ILLINOIS DEPARTMENT OF TRANSPORTATION	PLAN AND PROFILE SB FOREST HILLS RD				F.A.*	SECTION	COUNTY	TOTAL SHEETS	SHEET NO.
ce:\pw\work\pwwadot\goffjl\dms41657\d14405p.dgn	PLOT SCALE = 50.0000' / IN.	DRAWN -	REVISED -		IL RTE 251 & FOREST HILLS RD	1-HBR & 1-2HB-D	WINNEBAGO	216	33				
PLOT DATE = Thu Sep 30 14:42:19 2010	DATE -	CHECKED -	REVISED -		CONTRACT NO. 64B79								
		DATE -	REVISED -		FED. ROAD DIST. NO.	ILLINOIS	FED. AID PROJECT						

* F.A.P. 303 & F.A.U. 5146