

STATE OF ILLINOIS  
DEPARTMENT OF TRANSPORTATION

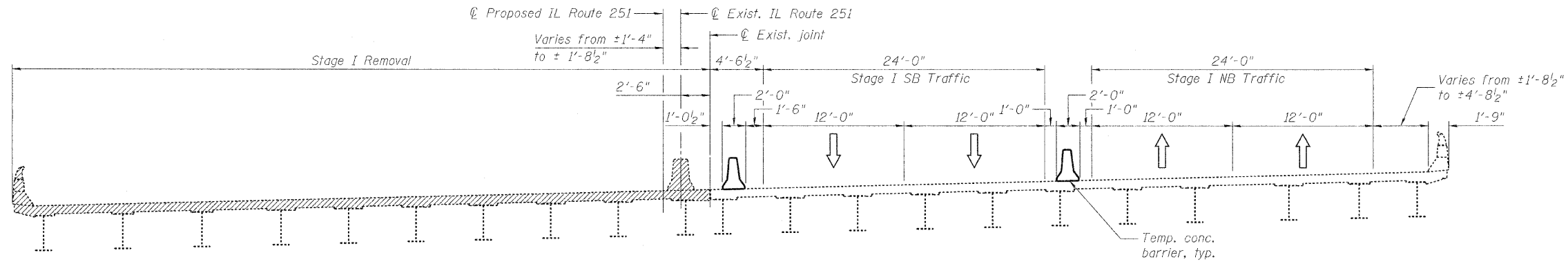

**STAGE I REMOVAL**  
(Looking North)

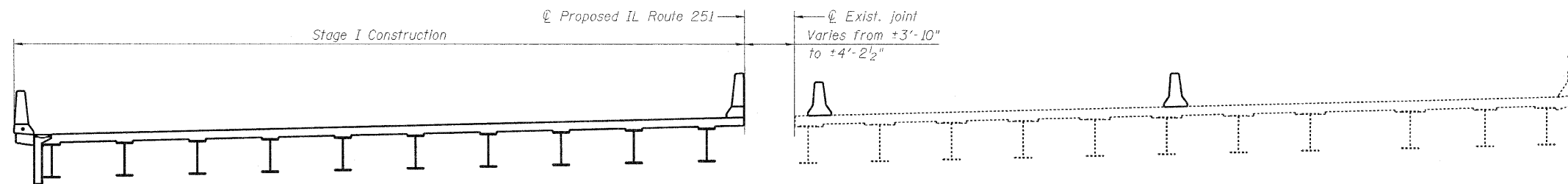

**STAGE I CONSTRUCTION**  
(Looking North)

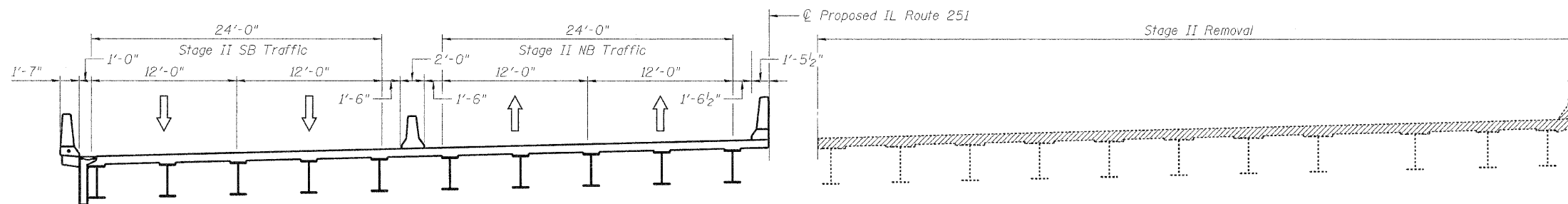

**STAGE II REMOVAL**  
(Looking North)

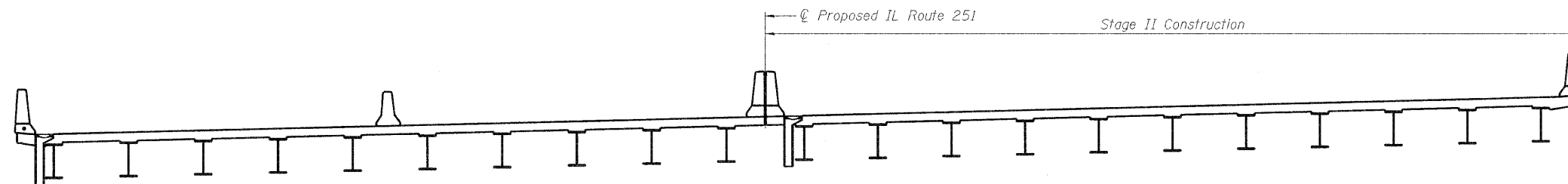

**STAGE II CONSTRUCTION**  
(Looking North)

Notes:

- All staging cross sections are looking North.
- For quantity of Temporary Concrete Barrier, see roadway plans.
- Hatched areas indicate Removal of Existing Structures.
- Deck horizontal dimensions are perpendicular to  $\hat{C}$  IL Route 251.

**STAGE CONSTRUCTION - SUPERSTRUCTURE**  
**STRUCTURE NO. 101-0190**

DESIGNED	- JY
CHECKED	- GSP
DRAWN	- MJB
CHECKED	- JY

SHEET NO. 5	F.A.* RTE.	SECTION	COUNTY	TOTAL SHEETS	SHEET NO.
	*	1-HBR & 1-2HB-D	WINNEBAGO	216	60
61 SHEETS	IL RTE 251 & FOREST HILLS RD CONTRACT NO. 64B79				
FED. ROAD DIST. NO. 7 ILLINOIS FED. AID PROJECT					

\* F.A.P. 303 & F.A.U. 5146