

STATE OF ILLINOIS  
DEPARTMENT OF TRANSPORTATION

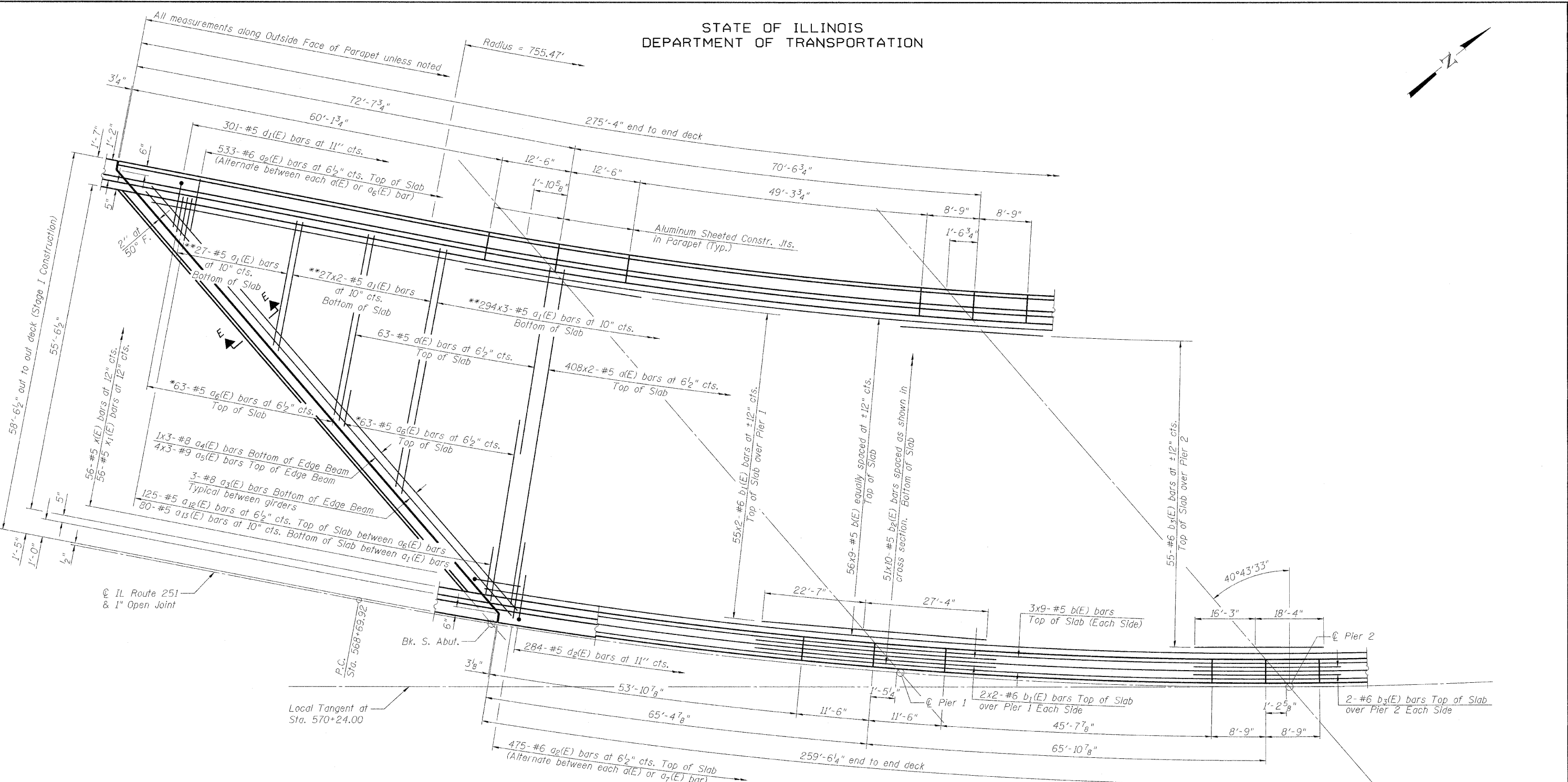
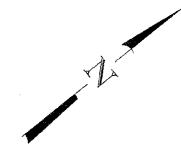

\*Order a<sub>6</sub>(E) bars full length. Cut to fit skew and use remainder of bars in same end of deck.  
\*\*Vary lap length or cut to fit skew.

**SOUTHBOUND DECK PLAN - SPANS 1 AND 2**

**DECK PLAN - SOUTHBOUND  
SPANS 1 AND 2  
STRUCTURE NO. 101-0190**

DESIGNED - JY
CHECKED - GSP
DRAWN - MJB
CHECKED - JY

**MINIMUM BAR LAPS**  
(Deck)

#5 Bar - 2'-7"
#6 Bar - 3'-1"
#8 Bar - 6'-9"
#9 Bar - 9'-8"

Notes:  
See Sheet 17 for deck cross section.  
See Sheets 22 and 23 for superstructure details and Bill of Material.  
Bars indicated thus 20 x 3-#5 etc. indicates 20 lines of bars with 3 lengths per line.  
See Sheet 21 for parapet reinforcement.  
Transverse bars shall be placed radially.  
Longitudinal bars shall be placed along the curve.

SHEET NO. 15  61 SHEETS	F.A. RTE. *	SECTION 1-HBR & 1-2HB-D	COUNTY WINNEBAGO	TOTAL SHEETS 216	SHEET NO. 70
	IL RTE 251 & FOREST HILLS RD CONTRACT NO. 64B79 FED. ROAD DIST. NO. 7 ILLINOIS FED. AID PROJECT				

\* F.A.P. 303 & F.A.U. 5146

9/20/2010 11:08:10 AM g:\project\208273\_001\cadd\structural\sheet\1010190-64B79-015-DeckPlan\_SB\_1&2.dgn