

STATE OF ILLINOIS  
DEPARTMENT OF TRANSPORTATION

\*Order  $a_{22}(E)$  bars full length. Cut to fit skew and use remainder of bars in same end of deck.

\*\*Vary lap length or cut to fit skew.

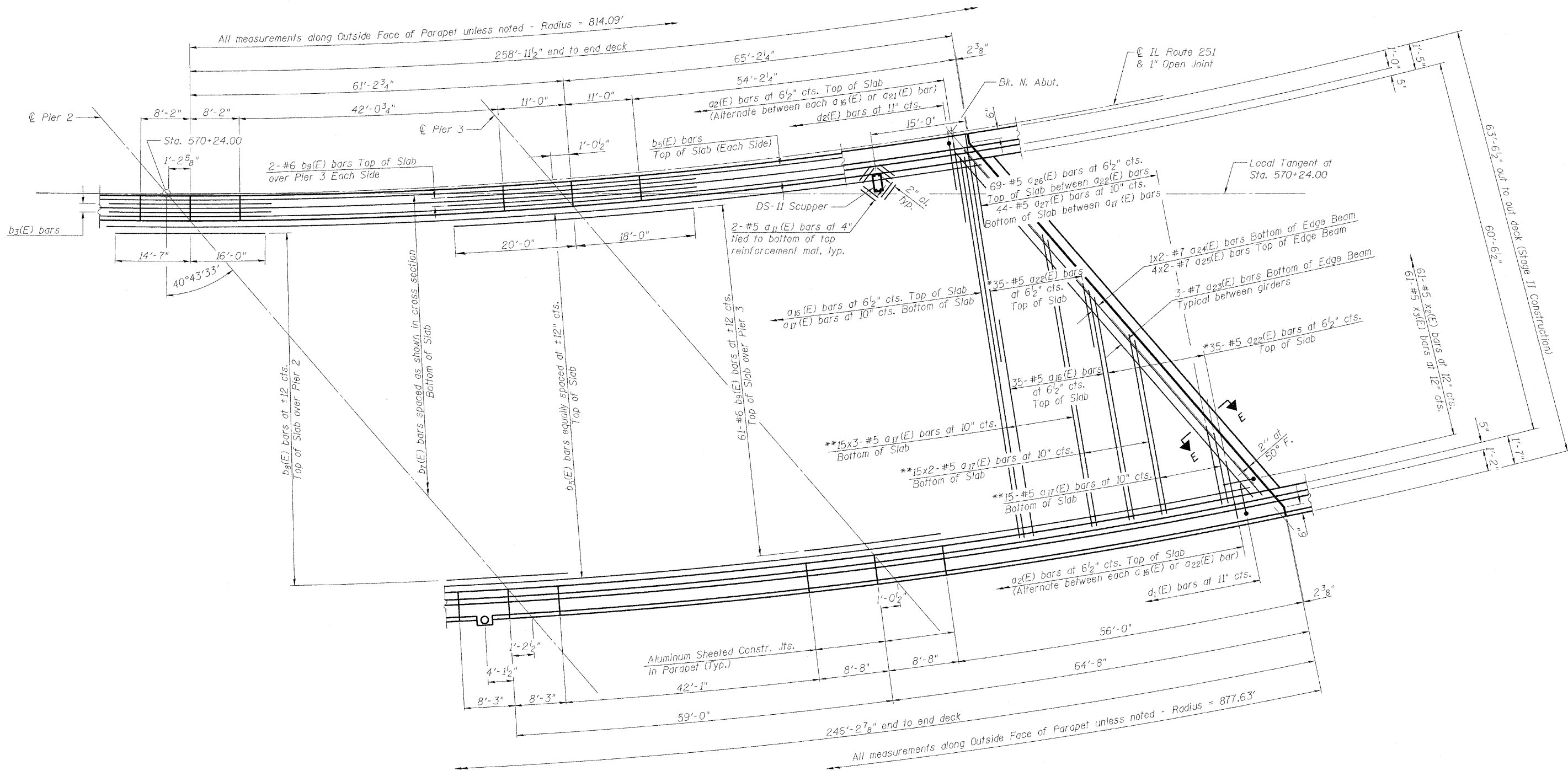
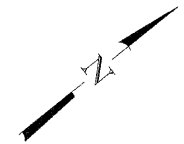

**NORTHBOUND DECK PLAN - SPANS 3 AND 4**

**DECK PLAN - NORTHBOUND  
SPANS 3 AND 4  
STRUCTURE NO. 101-0190**

DESIGNED - JY
CHECKED - GSP
DRAWN - MJB
CHECKED - JY

**MINIMUM BAR LAPS**

- (Deck)  
 #5 Bar - 2'-7"  
 #6 Bar - 3'-1"  
 #7 Bar - 5'-10"

**Notes:**

See Sheet 20 for deck cross section.  
 See Sheets 22 and 23 for superstructure details and Bill of Material.  
 Bars indicated thus 20 x 3-#5 etc. indicates 20 lines of bars with 3 lengths per line.  
 See Sheet 21 for parapet reinforcement.  
 Traverse bars shall be placed radially.  
 Longitudinal bars shall be placed along the curve.

SHEET NO. 19	F.A.* RTE.	SECTION	COUNTY	TOTAL SHEETS	SHEET NO.
	*	1-HBR & 1-2HB-D	WINNEBAGO	216	74
61 SHEETS	IL RTE 251 & FOREST HILLS RD CONTRACT NO. 64B79				
FED. ROAD DIST. NO. 7 [ILLINOIS] FED. AID PROJECT					

\* F.A.P. 303 & F.A.U. 5146

9/20/2010 11:08:22 AM g:\project\208273\_001\cadd\structural\sheet\1010190-64B79-019-DeckPlan\_NB\_384.dgn