

STATE OF ILLINOIS
DEPARTMENT OF TRANSPORTATION

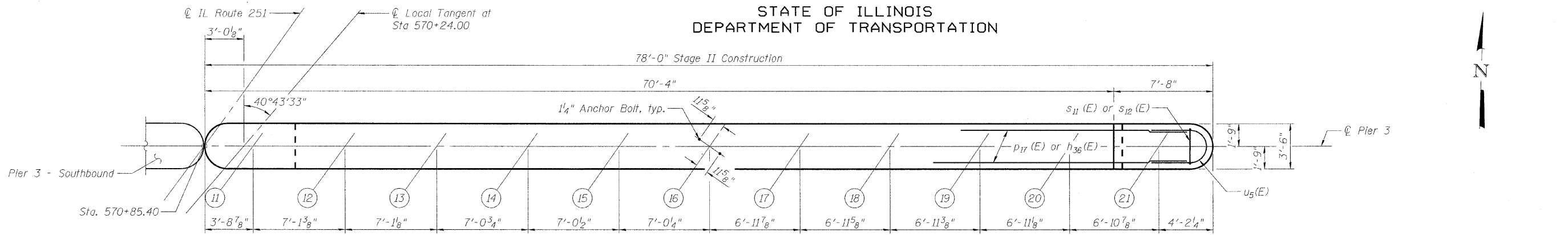

TOP PLAN

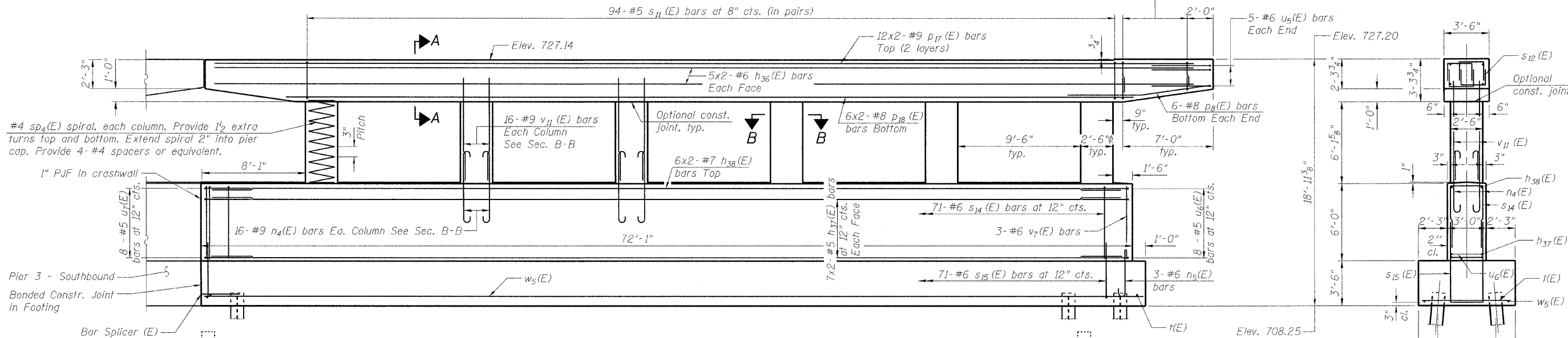

ELEVATION
(Looking North)

END VIEW

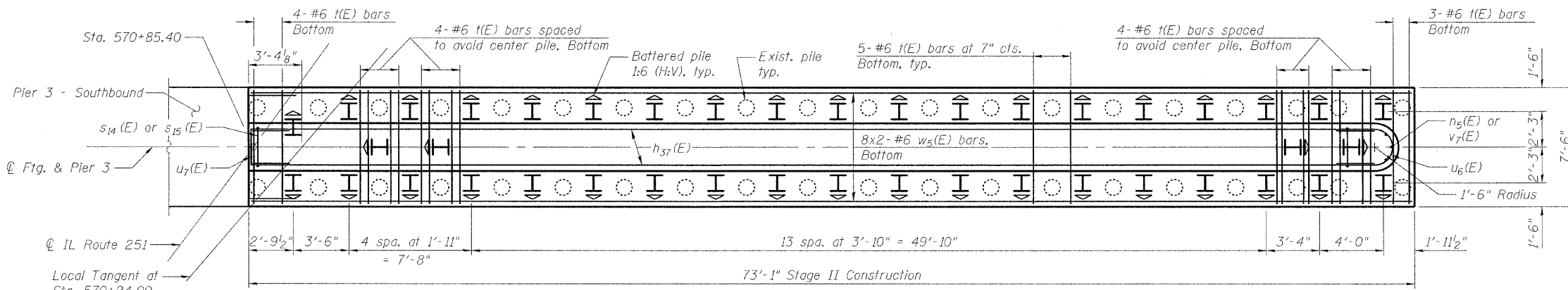

FOOTING PLAN

PILE DATA

Type: Steel HP 12x53 with pile shoes
Nominal Required Bearing: 318 kips
Factored Resistance Available: 175 kips
Est. Length: 29 ft
No. Production Piles: 42
No. Test Piles: 0

Note:
See test pile location on Sheet 3.

DESIGNED - JY
CHECKED - GSP
DRAWN - MJB
CHECKED - JY

PIER 3 - NORTHBOUND
STRUCTURE NO. 101-0190

SHEET NO. 56	F.A.* RTE.	SECTION	COUNTY	TOTAL SHEETS	SHEET NO.
	*	1-HBR & 1-2HB-D	WINNEBAGO	216	111
61 SHEETS	IL RTE 251 & FOREST HILLS RD CONTRACT NO. 64B79				
FED. ROAD DIST. NO. 7 [ILLINOIS] FED. AID PROJECT					

* F.A.P. 303 & F.A.U. 5146