

STATE OF ILLINOIS
DEPARTMENT OF PUBLIC WORKS & BUILDINGS
DIVISION OF HIGHWAYS

ROUTE NO.	SECTION	COUNTY	TOTAL SHEETS	SHEET NO.	SHEET NO. 2
FAP 303 (IL 251) & FAU 5146 (FOREST HILLS ROAD)	1-HB-F & 1-2-HB-D	Winnebago	38	22	1/2 SHEETS
PROJECT NO. 0-271(1)					

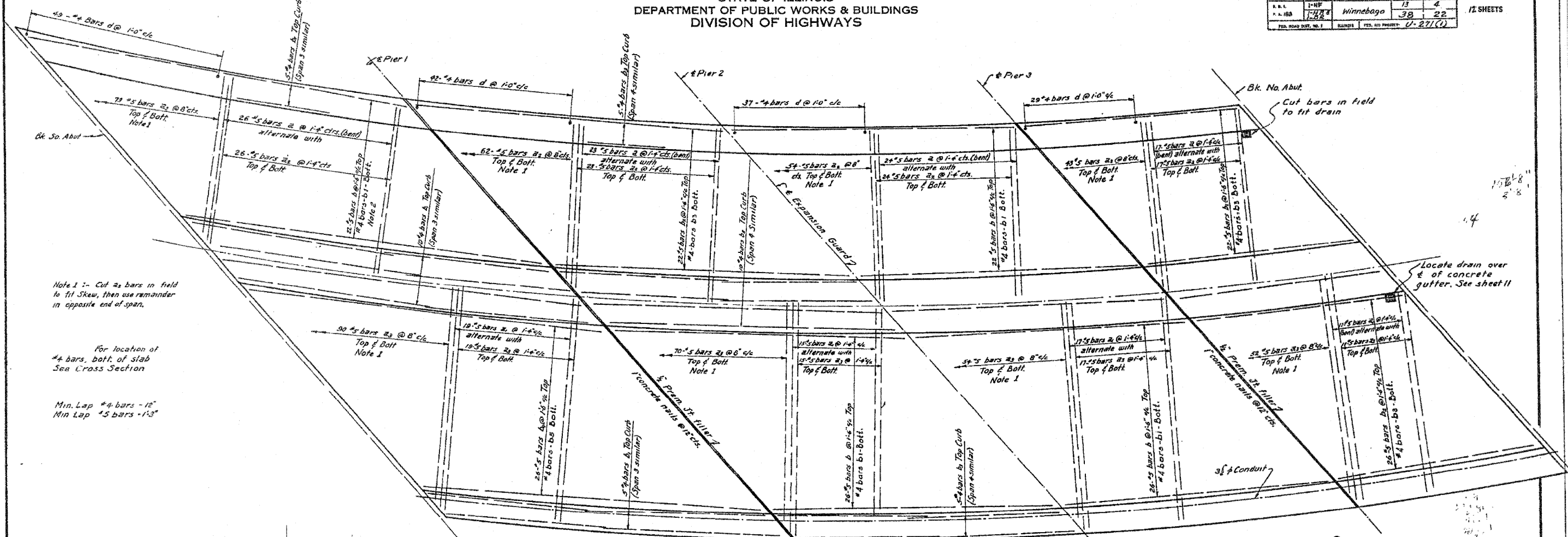

Note 1 :- Cut #2 bars in field to fit skew, then use remainder in opposite end of span.

For location of #4 bars, bott. of slab See Cross Section

Min. Lap #4 bars - 12"
Min. Lap #5 bars - 13"

Locate drain over & of concrete gutter. See sheet 11

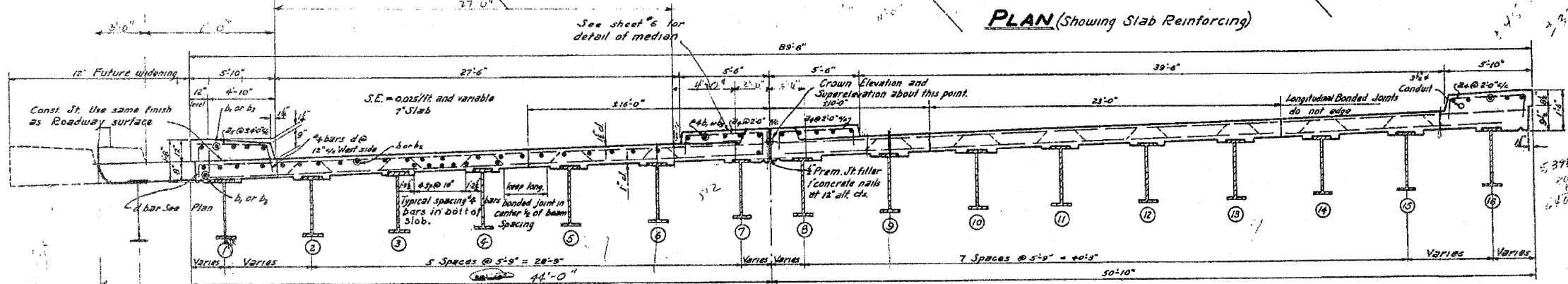

**SUPERSTRUCTURE
BILL OF MATERIAL**

Bar	No	Size	Length	Shape
a	90	#5	30'-3"	~
a1	62	#5	50'-4"	~
a2	644	#5	38'-0"	~
a3	656	#5	49'-8"	~
a4	378	#4	7'-6"	~
a5	67	#4	5'-6"	~
b	310	#5	22'-0"	~
b1	648	#4	22'-0"	~
b2	162	#5	24'-0"	~
b3	344	#4	24'-0"	~
b4	78	#5	26'-0"	~
b5	136	#7	26'-0"	~
d	417	#4	1'-0"	~
Class "C" Concrete				cu. yd. 654.8
Reinf. Bars				lbs. 101,010
Structural Steel				lbs. 1003,078
Cast Iron Frames				ea. 2
Conduit				lin. ft. 248

* Conduit shall be 3/4" Fiber Duct

**SUPERSTRUCTURE
F.A. RT 188 SEC 1-HB-F
WINNEBAGO COUNTY
STA 24+71.4**

DESIGNED: *[Signature]*
CHECKED: *[Signature]*
DRAWN: *[Signature]*
CHECKED: *[Signature]*

EXAMINED: *[Signature]*
PASSED: *[Signature]*
APPROVED: *[Signature]*

FEB. 8 1955

Note:
All transverse reinforcement shall be placed perpendicular to beams.
All longitudinal construction joints shall be placed parallel to beams.
Provide a minimum cover of 3" of concrete over 3/4" conduit. Extend conduit one foot beyond abt. and plug. Plugs and expansion devices shall be included in unit price for conduit.

ROUTE FAP 303 (IL 251) & FAU 5146 (FOREST HILLS ROAD)	SECTION 1-HB-F & 1-2-HB-D	COUNTY WINNEBAGO	SHEET 151 OF 216
		CONTRACT 64B79	

INFORMATION ONLY