

B.M. "X" TRAFFIC SIGNAL BASE 23+R 13+31(SRCR.RD.) EL. 717.90

STORM SEWER LINE AND F.A. 188 AT GRADE SEPARATION OVER SPRING CREEK ROAD

PROJECT NO.	1-HB	SECTION	3B	SHEET	9
FA. 188	1-BR	WINNEBAGO			
U-276(11)					

The Bridge Contractor will place 64' of 18" SS - Type I from the Existing Culvert 106' L 15+72 toward the Future Manhole 36' L 15+72.
The end of the storm sewer at the Future Manhole will be left open and any ditches necessary to drain off surface water collecting under the structure will be made to drain to the open end of the SS. To be paid for as STORM SEWER TYPE - I - 10" - 64 Lin. Ft.

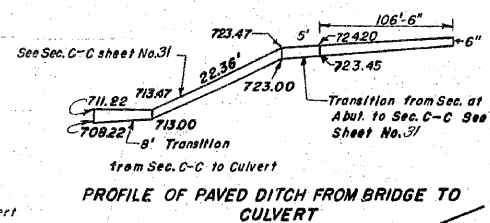
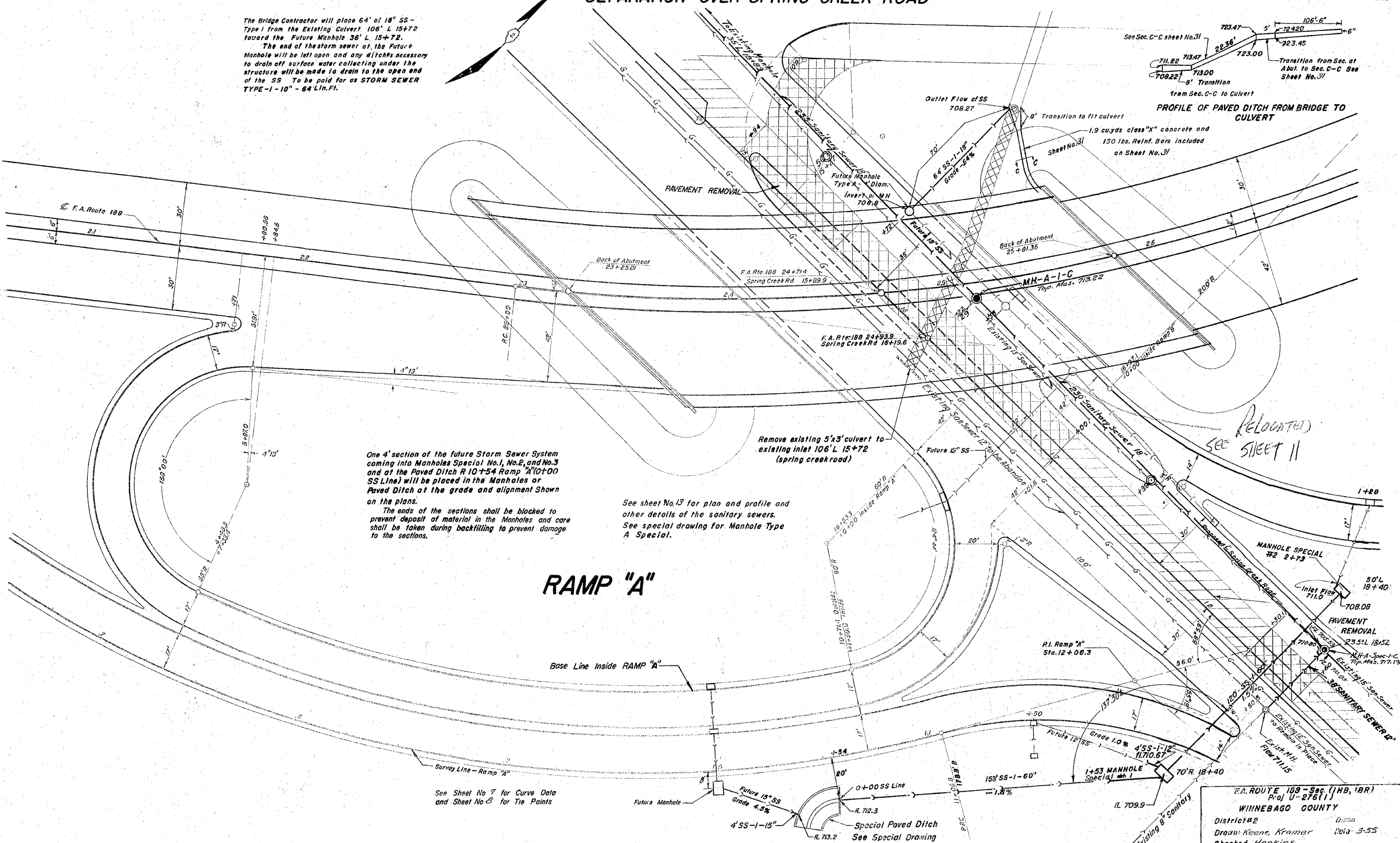

One 4' section of the future Storm Sewer System coming into Manholes Special No. 1, No. 2, and No. 3 and at the Paved Ditch R 10+54 Ramp "A" (0+00 SS Line) will be placed in the Manholes or Paved Ditch at the grade and alignment shown on the plans.
The ends of the sections shall be blocked to prevent deposit of material in the Manholes and care shall be taken during backfilling to prevent damage to the sections.

See sheet No. 13 for plan and profile and other details of the sanitary sewers. See special drawing for Manhole Type A Special.

RAMP "A"

See Sheet No 7 for Curve Data and Sheet No 8 for Tie Points

RELOCATED
SEE SHEET 11

F.A. ROUTE 188 - Sec. (1HB, 1BR)			
Proj U-276(11)			
WINNEBAGO COUNTY			
District #2	Dist. 3	Date 3-55	
Drawn: Keene, Kramer		Checked: Hankins	
ROUTE	SECTION	COUNTY	SHEET
FAP 303 (IL 251) & FAU 5146 (FOREST HILLS ROAD)	1-HB-R & 1-2-HB-D	WINNEBAGO	174 OF 216
		CONTRACT	64B79