

EXIST. CURVE I55CL-1  
 PI STA. = 309+18.58  
 $\Delta = 70^\circ 39' 24''$  (RT)  
 $D = 1^\circ 20' 00''$   
 $R = 4,297.21'$   
 $T = 3,045.78'$   
 $L = 5,299.28'$   
 $E = 969.93'$   
 $e =$   
 T.R. =  
 S.E. RUN =  
 P.C. STA. = 278+72.80  
 P.T. STA. = 331+72.08

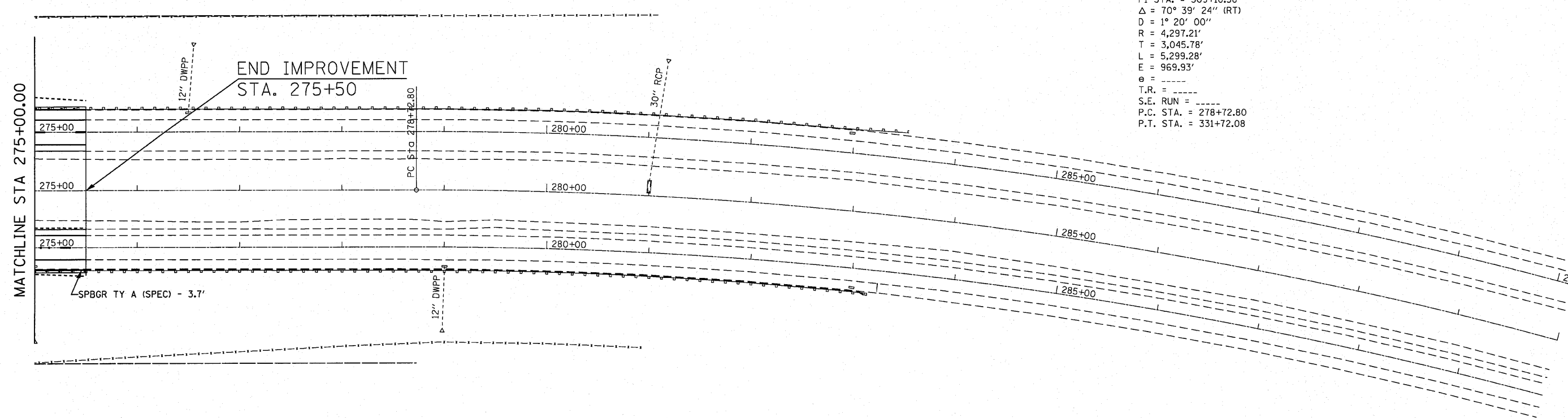

DATE	
BY	
DATE	
BY	
DATE	
BY	

DATE	
BY	
DATE	
BY	
DATE	
BY	

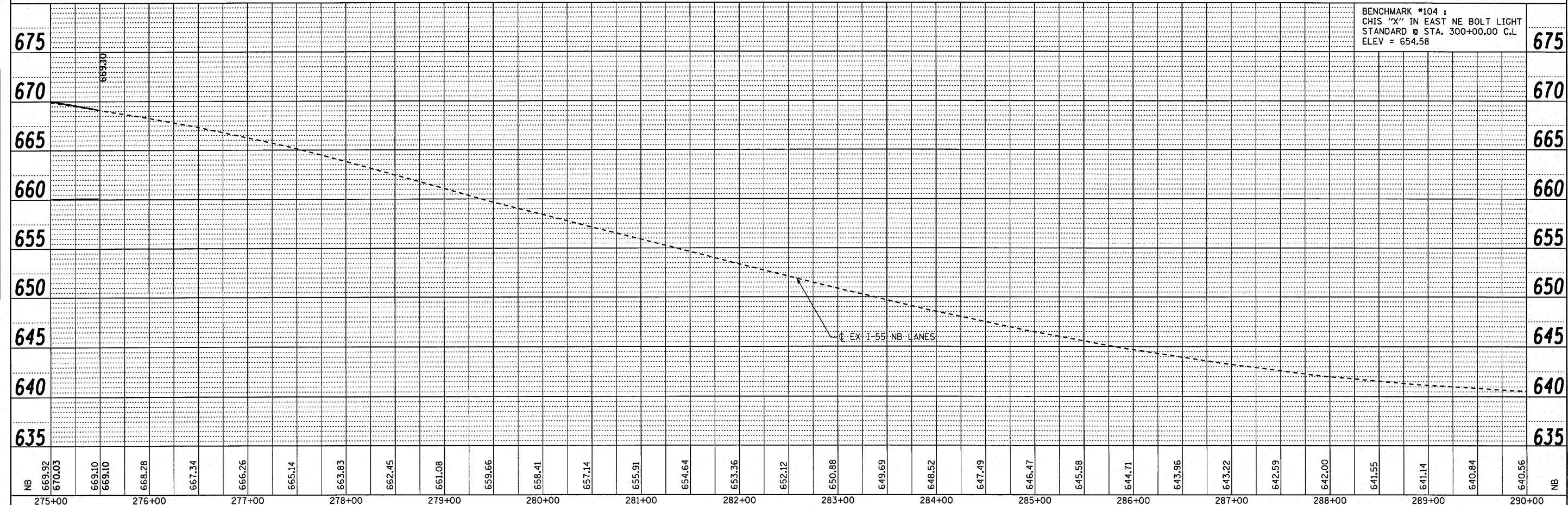

FILE NAME =	USER NAME = duncanbd	DESIGNED -	REVISED -	<b>STATE OF ILLINOIS DEPARTMENT OF TRANSPORTATION</b>	<b>PLAN AND PROFILE NORTHBOUND</b>	F.A.I. RTE.	SECTION	COUNTY	TOTAL SHEETS	SHEET NO.
ct:\pwork\pwork\duncanbd\dms58148\c36856-shr-plnprfl.dgn	DRAWN -	REVISED -	55			(53-1)HBR & HBR-1	LIVINGSTON	102	14	
PLOT SCALE = 50.0000' / IN.	CHECKED -	REVISED -	CONTRACT NO. 66856							
PLOT DATE = Aug 11, 2010 - 02:55:11 PM	DATE -	REVISED -	FED. ROAD DIST. NO. [ILLINOIS] FED. AID PROJECT							

CB JOB NO 05004-8

SCALE: 1=50    SHEET NO. 3 OF 3 SHEETS    STA. 275+00.00 TO STA. 290+00.00