

STATE OF ILLINOIS  
DEPARTMENT OF TRANSPORTATION

N. EDGE OF SHOULDER

Location	Station	Offset	Theoretical Grade Elevations
W End East Appr. Pvmt.	163+98.50	-16.00	631.52
A3	164+08.50	-16.00	631.48
A4	164+18.50	-16.00	631.45
E End East Appr. Pvmt.	164+28.50	-16.00	631.41

N. EDGE OF PAVEMENT

Location	Station	Offset	Theoretical Grade Elevations
W End East Appr. Pvmt.	163+98.50	-12.00	631.60
A3	164+08.50	-12.00	631.56
A4	164+18.50	-12.00	631.53
E End East Appr. Pvmt.	164+28.50	-12.00	631.50

☉ ROADWAY, PROFILE GRADE & STAGE CONSTRUCTION LINE

Location	Station	Offset	Theoretical Grade Elevations
W End East Appr. Pvmt.	163+98.50	0.00	631.79
A3	164+08.50	0.00	631.75
A4	164+18.50	0.00	631.72
E End East Appr. Pvmt.	164+28.50	0.00	631.68

S. EDGE OF PAVEMENT

Location	Station	Offset	Theoretical Grade Elevations
W End East Appr. Pvmt.	163+98.50	12.00	631.60
A3	164+08.50	12.00	631.56
A4	164+18.50	12.00	631.53
E End East Appr. Pvmt.	164+28.50	12.00	631.50

S. EDGE OF SHOULDER

Location	Station	Offset	Theoretical Grade Elevations
W End East Appr. Pvmt.	163+98.50	16.00	631.52
A3	164+08.50	16.00	631.48
A4	164+18.50	16.00	631.45
E End East Appr. Pvmt.	164+28.50	16.00	631.41

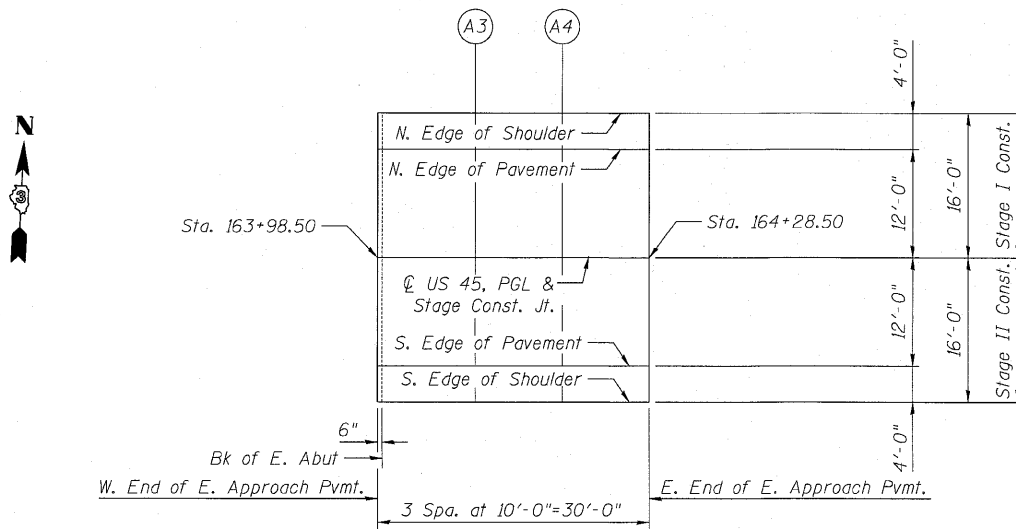

PLAN

TOP OF EAST APPROACH  
SLAB ELEVATIONS  
STRUCTURE NO. 038-0221

SHEET NO. 7 OF 20 SHEETS	F.A.P. RTE.	SECTION	COUNTY	TOTAL SHEETS	SHEET NO.
	681	118BR	IROQUOIS	42	16
			CONTRACT NO. 66861		
FED. ROAD DIST. NO. _ ILLINOIS FED. AID PROJECT					

7/29/2010 6:58:50 PM C:\Drawings\5500-10US45\Final\Structural\Plans\ST\_Top of East Approach Slab Elevations.dgn

**ZROKA**  
engineering  
Zroka Engineering, P.C.  
4216 North Hermitage  
Chicago, IL 60613

Date: 7-28-10 Drawn By: FJS Checked By: DZ E-AS

11-1-09